

206,711 SF

Industrial Space For Lease



 PROPERTY VIDEO



Prologis Bolingbrook

700 Gateway Drive
Bolingbrook, IL 60440 USA

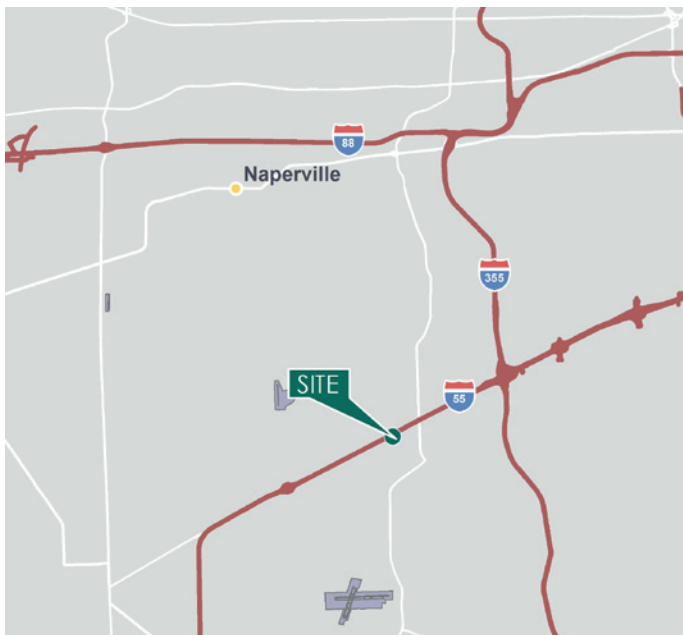

LOCATION

- I-55 visibility
- Immediate expressway access via 4-way interchange at I-55 and Rt. 53

FACILITY

- 206,711 SF
- ±6,628 SF office
- 9.6 acre site
- 30' clear height
- 31 exterior docks
- 2 drive-in doors
- ±56 car parking (expandable)
- 1600A, 480V, 3-phase power
- 54' x 52' (loading bay 60' x 52')
- ESFR sprinkler
- Built in 2005

ADVANTAGES AND AMENITIES

- Secured truck court

206,711 SF

Industrial Space For Lease

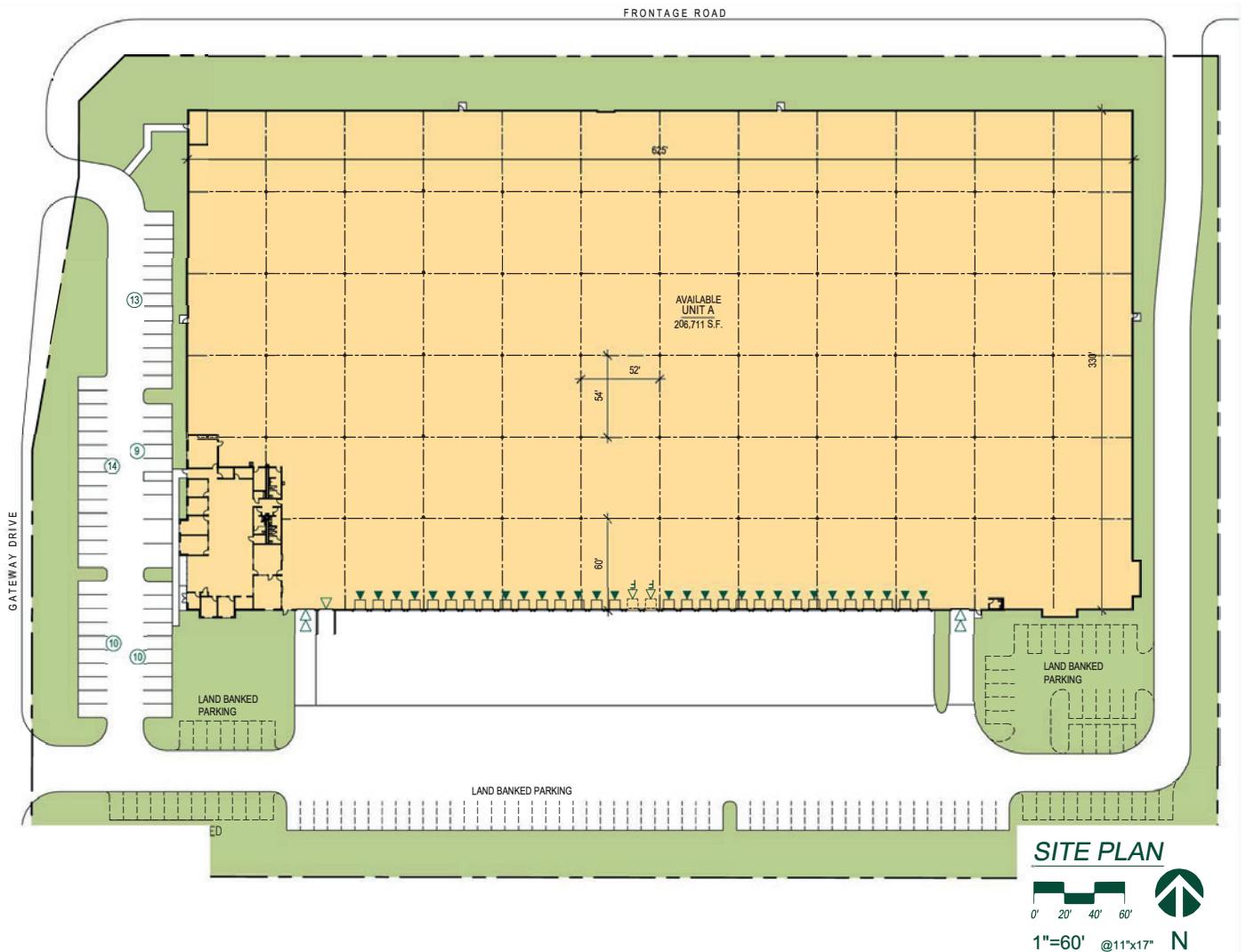

Broker Name

Jeff Galante

jgalante@lee-associates.com

ph +1 773 355 3007

cell +1 630 363 7605

9450 W Bryn Mawr

Suite 550

Rosemont, IL 60018 USA

Broker Name

Terry Grapenthin

tgrape@lee-associates.com

ph +1773 355 3042

cell +1 708 275 1263

9450 W Bryn Mawr

Suite 550

Rosemont, IL 60018 USA

Broker Name

Ryan Earley

rearley@lee-associates.com

ph +1773 355 3020

cell +1 630 253 6087

9450 W Bryn Mawr

Suite 550

Rosemont, IL 60018 USA

Prologis

James Neswold

jneswold@prologis.com

ph +1 847 292 3924

cell +1 847 571 0592

6250 N. River Road

Suite 1100

Rosemont, IL 60018 USA