

AVAILABLE

Lea Hill Retail Development

12722 SE 312th, Building K, Auburn, WA



CONTACT

Cramer Foster

253.722.1423 | cfoster@kiddermathews.com

Jeff Kraft

253.722.1405 | jkraft@kiddermathews.com



AVAILABLE

12722 SE 312th, Building K

FEATURES

Newer mixed-use development

Former grocery store consisting of 26,400 SF

Over \$1.5 MM in existing infrastructure and FF & E

Lease rate: \$13.00 PSF (modified gross)

Space can be demised

City of Auburn - zoned C1 (light commercial)

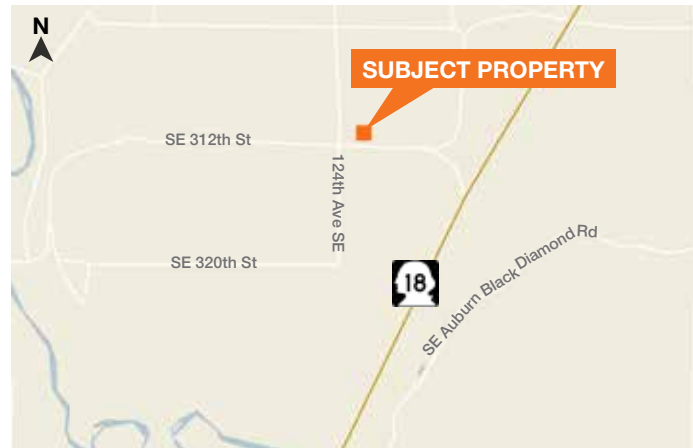

CONTACT

Cramer Foster

253.722.1423

cfoster@kiddermathews.com

Jeff Kraft

253.722.1405

jkraft@kiddermathews.com

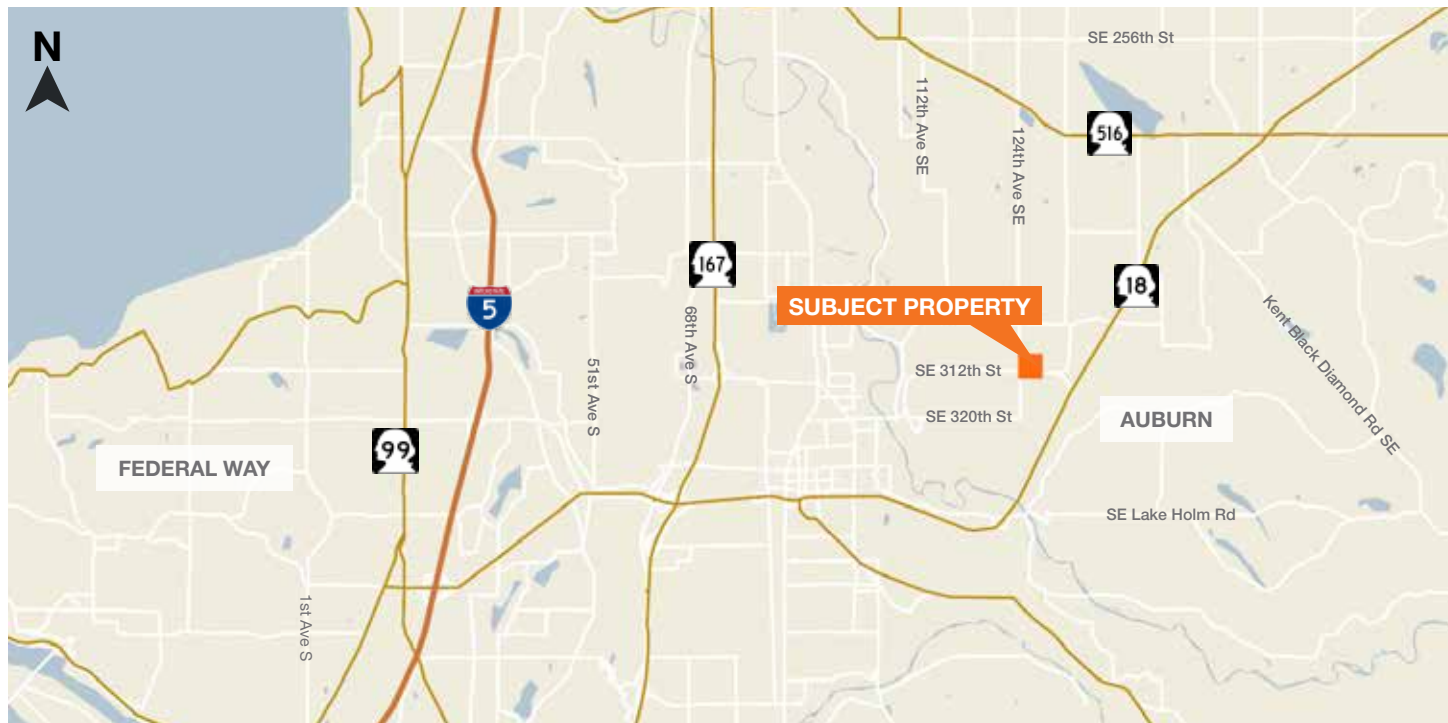

AVAILABLE

12722 SE 312th, Building K

AERIAL



CONTACT

Cramer Foster

253.722.1423

cfoster@kiddermathews.com

Jeff Kraft

253.722.1405

jkraft@kiddermathews.com



AVAILABLE

12722 SE 312th, Building K

SITE PLAN

CONTACT

Cramer Foster
253.722.1423
cfoster@kiddermathews.com

Jeff Kraft
253.722.1405
jkraft@kiddermathews.com

