

275 ON THE PARK



SCAN HERE!



EDDIE CHERRY

Phone: 314.647.6611 ext. 113
Eddie@ManorRealEstate.com

BEN CHERRY, CCIM

Phone: 314.647.6611 ext. 115
Ben@ManorRealEstate.com

245 UNION BOULEVARD
ST. LOUIS, MO 63108

8,263 S.F. | CONTACT BROKER FOR PRICING

PROPERTY INFORMATION



- **8,263 SQUARE FOOT FORMER RESTAURANT SPACE AVAILABLE!**
- **BENEFIT FROM 500+ RESIDENTIAL UNITS ONSITE**
- **WALKABLE LOCATION STEPS FROM FOREST PARK**
- **JOIN CREMA COFFEE — NOW OPEN!**
- **275 ON THE PARK FEATURES 3 HISTORIC FORMER HIGH-RISE HOTELS (THE WESTERMORELAND, CONGRESS, AND SENATE)**
- **NEW OWNERSHIP DELIVERING A \$20M+ REDEVELOPMENT TO MODERNIZE BUILDING(S)**

DEMOGRAPHICS		1 MILE	3 MILES	5 MILES
POPULATION		16,646	139,425	373,299
HOUSEHOLDS		9,424	65,428	177,342
AVERAGE HH INCOME		\$103,160	\$87,595	\$87,166

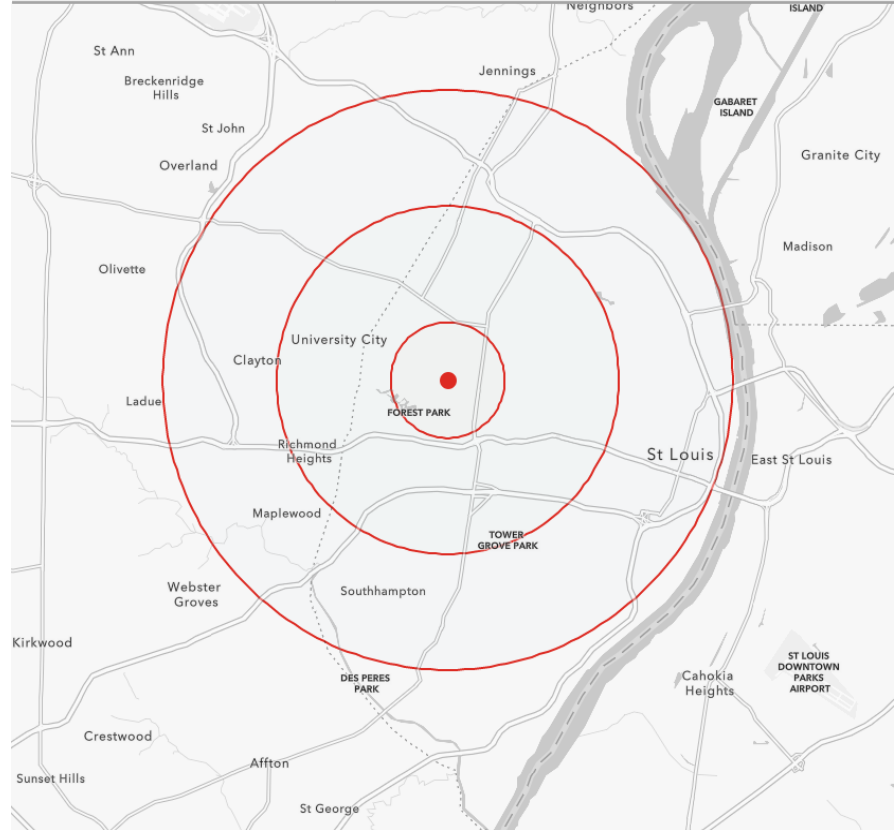

SCAN HERE!



EDDIE CHERRY

Phone: 314.647.6611 ext. 113
Eddie@ManorRealEstate.com

BEN CHERRY, CCIM

Phone: 314.647.6611 ext. 115
Ben@ManorRealEstate.com

**245 UNION BOULEVARD
 ST. LOUIS, MO 63108
 8,263 S.F. | CONTACT BROKER FOR PRICING**

SITE PLAN



SCAN HERE!



EDDIE CHERRY

Phone: 314.647.6611 ext. 113
Eddie@ManorRealEstate.com

BEN CHERRY, CCIM

Phone: 314.647.6611 ext. 115
Ben@ManorRealEstate.com

245 UNION BOULEVARD

ST. LOUIS, MO 63108

8,263 S.F. | CONTACT BROKER FOR PRICING

CONCEPTUAL FLOOR PLAN

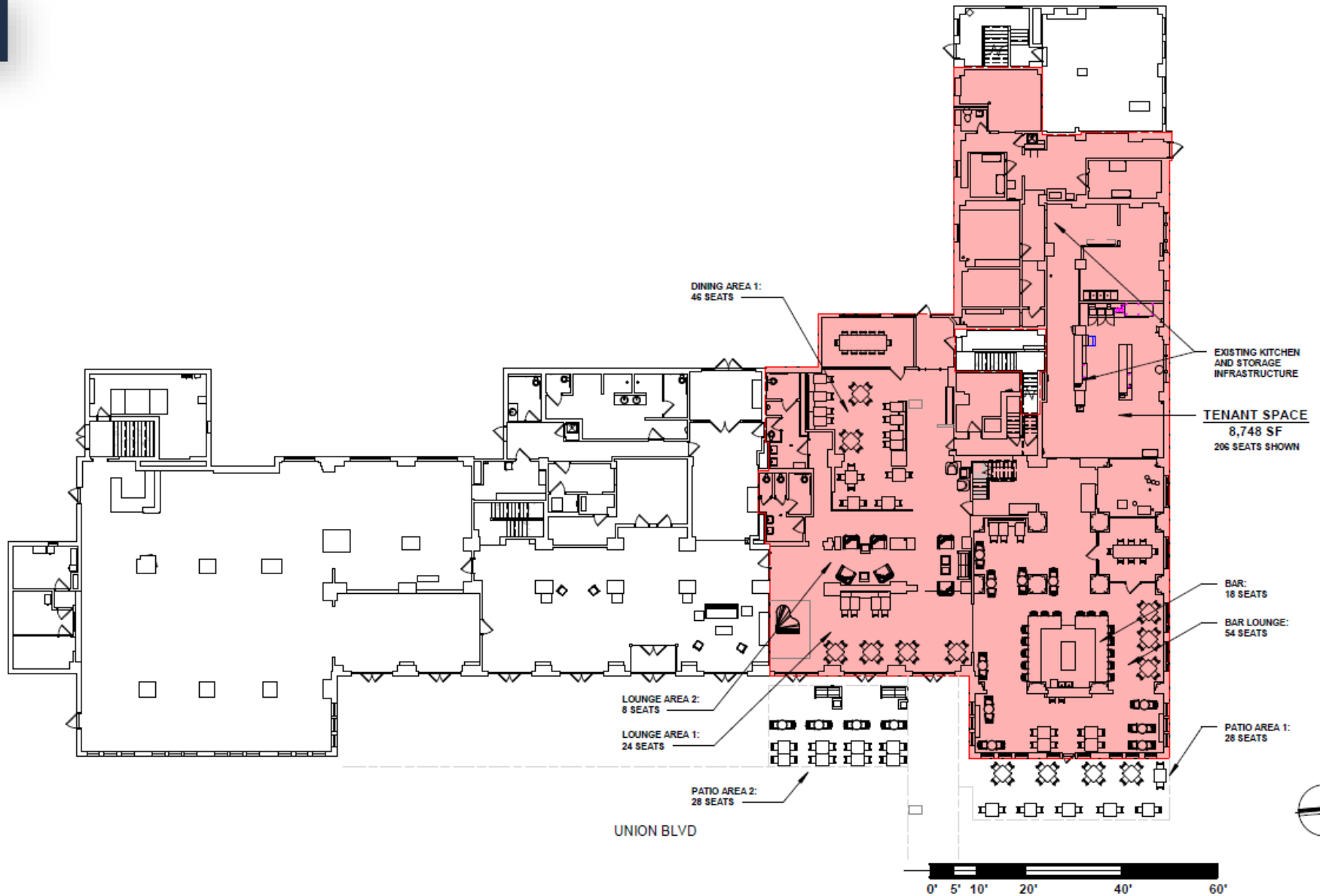

SCAN HERE!



EDDIE CHERRY

Phone: 314.647.6611 ext. 113
Eddie@ManorRealEstate.com

BEN CHERRY, CCIM

Phone: 314.647.6611 ext. 115
Ben@ManorRealEstate.com

245 UNION BOULEVARD

ST. LOUIS, MO 63108

8,263 S.F. | CONTACT BROKER FOR PRICING

AERIAL

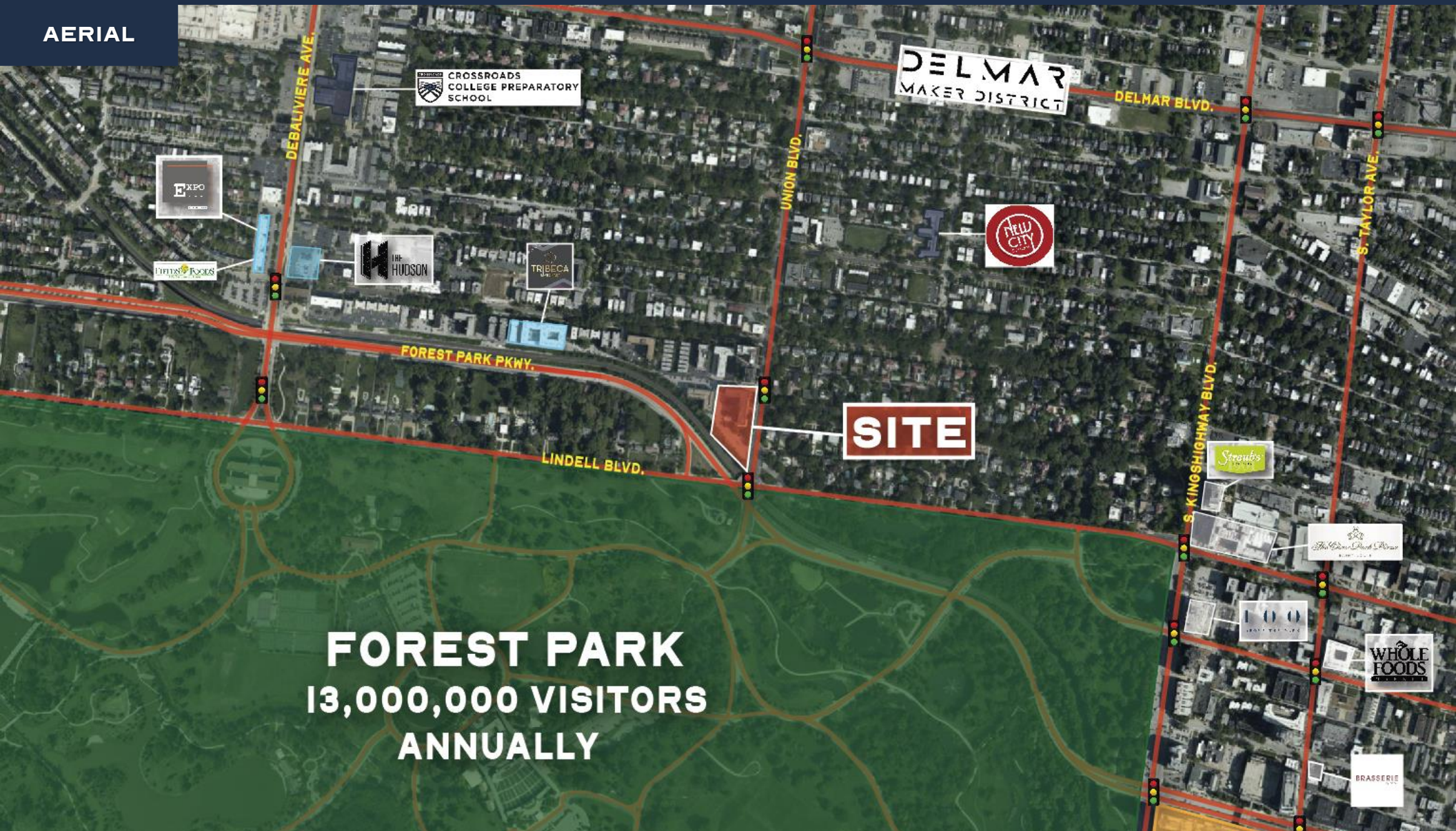

FOREST PARK
13,000,000 VISITORS
ANNUALLY

SCAN HERE!



EDDIE CHERRY

Phone: 314.647.6611 ext. 113
Eddie@ManorRealEstate.com

BEN CHERRY, CCIM

Phone: 314.647.6611 ext. 115
Ben@ManorRealEstate.com

245 UNION BOULEVARD
ST. LOUIS, MO 63108

8,263 S.F. | CONTACT BROKER FOR PRICING