

MIDWAY OFFICE SPACE FOR LEASE

THE WRIGHT BUILDING

2233 University Ave W | St. Paul, MN 55114



TRANSWESTERN

REAL ESTATE
SERVICES



Frank Richie 612.359.1674 | frank.richie@transwestern.com

PROPERTY SPECIFICATIONS



Location Map

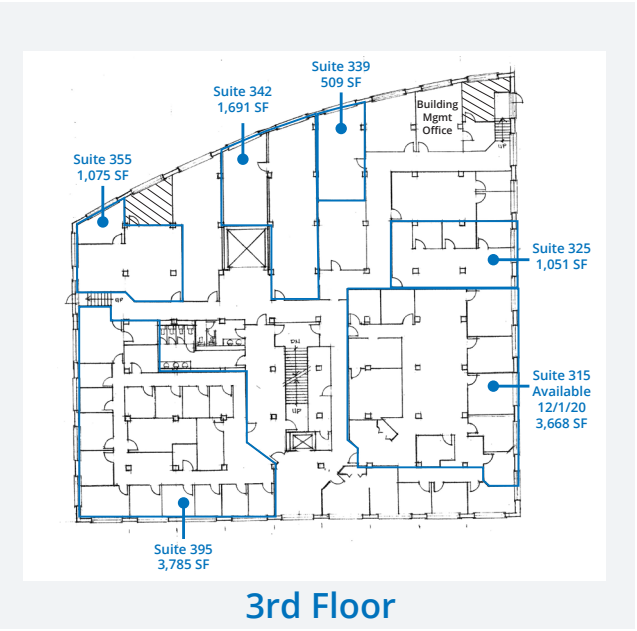

Building Specifications

- Building Size: 52,436 SF
- Year Built / Renovated: 1913 / 1987
- Gross Rates: \$17.00 - \$19.00 PSF



Area Amenities

- Convenient access to I-94 and MN-280
- Abundant food and shopping nearby



Location Amenities

- Located on bus line
- 1 block from Raymond & University light rail station
- Building breakroom
- Building conference room
- Surface parking
- Garage parking



Availability

- Suite 315: 3,668 SF (Available 12/1/20)
- Suite 325: 1,051 SF
- Suite 339: 509 SF
- Suite 342: 1,691 SF
- Suite 355: 1,075 SF
- Suite 395: 3,785 SF
- Suite 426: 1,743 SF