

# COUNTRY SQUARE

10400 South & Redwood Road (NWC)  
South Jordan, Utah



RETAIL  
FOR LEASE

**Hunter Todd**

RETAIL SPECIALIST

☎ 801.838.9630  
📠 801.808.8146  
✉ hunter@situsretail.com

**Matt Harlin**

RETAIL SPECIALIST

☎ 801.838.9632  
✉ mharlin@situsretail.com



Situs Retail Group, PLLC | 90 East 7200 South | Suite 102 | Midvale, UT 84047 | 801.266.1333 | www.situsretail.com

This statement with the information it contains is given with the understanding that all negotiations relating to the purchase, renting or leasing of the property described above shall be conducted through this office. The above information, while not guaranteed, has been secured from sources we believe to be reliable.





# COUNTRY SQUARE

10400 South & Redwood Road (NWC)  
South Jordan, Utah

**Hunter Todd**

RETAIL SPECIALIST

- ☎ 801.838.9630
- 📠 801.808.8146
- ✉ hunter@situsretail.com

**Matt Harlin**

RETAIL SPECIALIST

- ☎ 801.838.9632
- ✉ mharlin@situsretail.com





## ✓ SUMMARY

- ✓ Sizes: 1,642 to 6,562 SF
- ✓ Lease Rate: \$16 to \$18 PSF
- ✓ NNNs: \$5.35 PSF (est.)
- ✓ Availability: Immediate

## ☞ FEATURES

- ☞ Access/Visibility from Redwood Rd & 10400 South
- ☞ High-Growth Area
- ☞ Great Traffic Counts
- ☞ Nearby Tenants:



## COUNTRY SQUARE

10400 South & Redwood Road (NWC)  
South Jordan, Utah

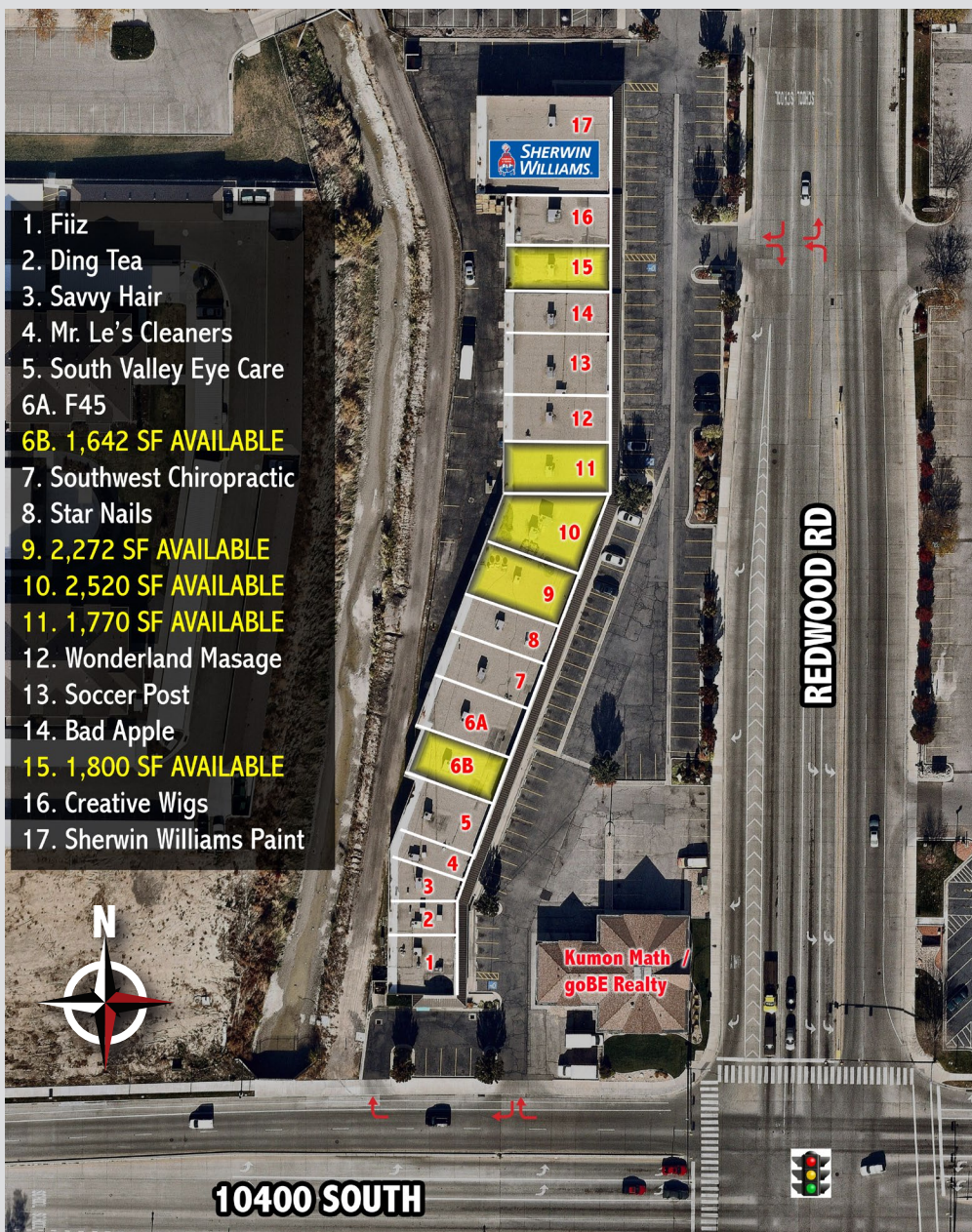

1. Fiiz
2. Ding Tea
3. Savvy Hair
4. Mr. Le's Cleaners
5. South Valley Eye Care
- 6A. F45
- 6B. 1,642 SF AVAILABLE
7. Southwest Chiropractic
8. Star Nails
9. 2,272 SF AVAILABLE
10. 2,520 SF AVAILABLE
11. 1,770 SF AVAILABLE
12. Wonderland Masage
13. Soccer Post
14. Bad Apple
15. 1,800 SF AVAILABLE
16. Creative Wigs
17. Sherwin Williams Paint



10400 SOUTH

**Hunter Todd**

RETAIL SPECIALIST

- ☎ 801.838.9630
- ☎ 801.808.8146
- ✉ hunter@situsretail.com

**Matt Harlin**

RETAIL SPECIALIST

- ☎ 801.838.9632
- ✉ mharlin@situsretail.com





# 3 MILE DEMOGRAPHICS

2020  
Population



104,300

2020 Average  
Household Income



\$122,224

2020  
Households



33,235

5-Year Projected  
Population Growth



6.4%

2020  
Employees



57,759



## DEMOGRAPHIC REPORT

		1 mi ring		3 mi ring		5 mi ring	
<b>Population</b>	<b>2020</b>	<b>10,887</b>		<b>104,300</b>		<b>318,960</b>	
	2025	11,661		110,998		339,201	
	2010	8,559		80,596		252,633	
	2000	7,459	%	63,543	%	202,858	%
<b>Households</b>		<b>3,702</b>		<b>33,235</b>		<b>101,079</b>	
	Average household size	2.94		3.13		3.14	
<b>Household income</b>	< \$25,000	259	7.0	1,294	3.9	4,541	4.5
	\$25,000 - \$49,999	413	11.2	4,405	13.3	15,005	14.8
	\$50,000 - \$74,999	471	12.7	5,827	17.5	18,642	18.4
	\$75,000 - \$99,999	458	12.4	5,403	16.3	16,562	16.4
	\$100,000+	1,920	51.9	14,979	45.1	42,082	41.6
Median household income	\$98,080		\$92,810		\$85,542		
<b>Average household income</b>	<b>\$130,487</b>		<b>\$122,224</b>		<b>\$108,376</b>		
<b>Total employees</b>		9,628		57,759		131,663	
<b>Business establishments</b>		853		4,800		11,928	
	Industrial	62	7.3	505	10.5	1,344	11.3
	Manufacturing	12	1.4	93	1.9	243	2.0
	Commercial	181	21.2	1,385	28.9	3,556	29.8
	Office	463	54.3	2,070	43.1	4,879	40.9
	Other	136	15.9	748	15.6	1,907	16.0
<b>Race</b>	White	9,829	90.3	89,939	86.2	267,394	83.8
	Black	148	1.4	1,892	1.8	5,729	1.8
	American Indian	29	0.3	300	0.3	1,325	0.4
	Asian & PI	432	4.0	5,108	4.9	15,516	4.9
	Other	450	4.1	7,061	6.8	28,996	9.1
<b>Hispanic population</b>		827	7.6	11,435	11.0	43,962	13.8
<b>Sex</b>	Male	5,244	48.2	52,096	49.9	158,994	49.8
	Female	5,644	51.8	52,204	50.1	159,966	50.2
<b>Median age</b>		43.2		35.4		34.5	

## COUNTRY SQUARE

10400 South & Redwood Road (NWC)  
South Jordan, Utah

**Hunter Todd**

RETAIL SPECIALIST

☎ 801.838.9630

☎ 801.808.8146

✉ hunter@situsretail.com

**Matt Harlin**

RETAIL SPECIALIST

☎ 801.838.9632

✉ mharlin@situsretail.com

