

# Classic Brick R+D Space for Lease

## 1251 Park Avenue, Emeryville



### Property Size: ±5,222 SF

As exclusive agents, we are pleased to offer the following space:

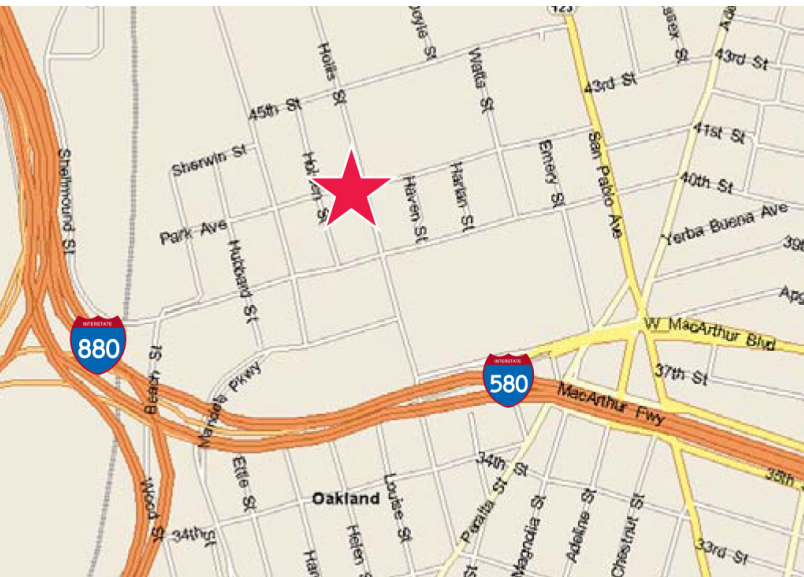

- ◆ 2 Private Offices, Primarily Open Layout
- ◆ Two restrooms Inside Space with Shower, plus Laundry Hookups
- ◆ Large Conference Room
- ◆ Reception Area/Kitchenette with Dishwasher
- ◆ Electric Grade Level Roll Up Door (12x12)
- ◆ Natural Wood 18' Ceilings
- ◆ 3 On-Site Parking Spaces inside Garage
- ◆ Untimed Street Parking
- ◆ Several Operable Windows/ 2 Gas Space Heaters
- ◆ LED Lighting
- ◆ 3 Phase - 2 x 200 Amp Panels 120/240 Volts (Tenant Verify)
- ◆ Polished Concrete Floors
- ◆ Short Walk to Restaurants - Can't Fail Cafe
- ◆ Paxio High Speed Fiber
- ◆ **Asking Rent: \$2.40 Industrial Gross**
- ◆ **Available: Immediately**

**Jeff Lahr** 510.923.6208 [jlahr@ngkf.com](mailto:jlahr@ngkf.com) CA RE License #01296493

**Jim Clark** 510.923.6247 [jim.clark@ngkf.com](mailto:jim.clark@ngkf.com) CA RE License #00926308



1111 Broadway, Suite 100, Oakland, CA 94607

[www.ngkf.com](http://www.ngkf.com)

# Classic Brick R+D Space for Lease

1251 Park Avenue, Emeryville

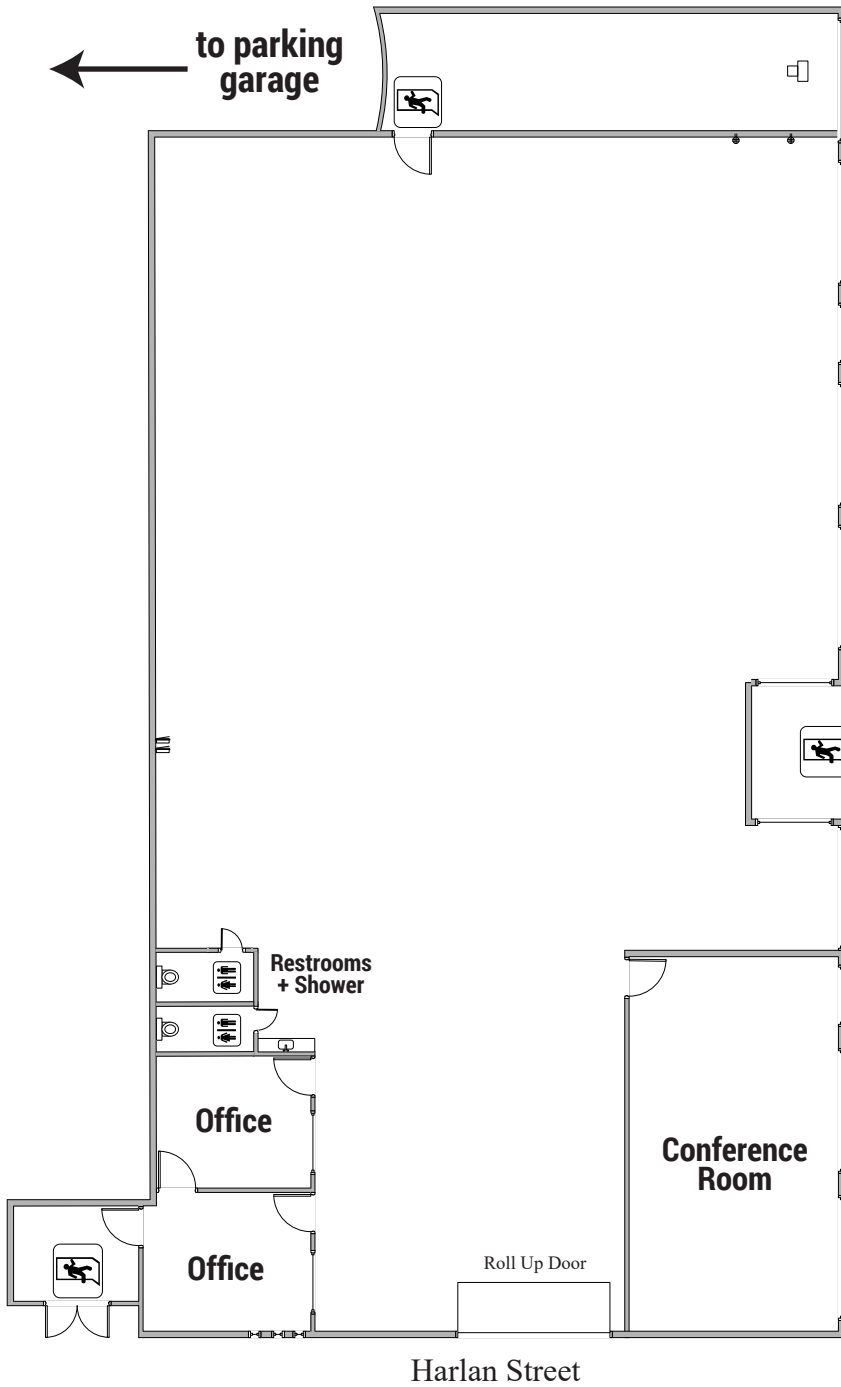

**Jeff Lahr** 510.923.6208 [jlahr@ngkf.com](mailto:jlahr@ngkf.com) CA RE License #01296493  
**Jim Clark** 510.923.6247 [jim.clark@ngkf.com](mailto:jim.clark@ngkf.com) CA RE License #00926308

1111 Broadway, Suite 100, Oakland, CA 94607

[www.ngkf.com](http://www.ngkf.com)

The distributor of this communication is performing acts for which a real estate license is required. The information contained herein has been obtained from sources deemed reliable but has not been verified and no guarantee, warranty or representation, either express or implied, is made with respect to such information. Terms of sale or lease and availability are subject to change or withdrawal without notice.