



EXTRAORDINARY

40
YEARS



LEASING OPPORTUNITY FOR BUILD-TO-SUIT MEDICAL OFFICE

BELLAIRE MEDICAL PLAZA II

ON CLAREWOOD DRIVE BETWEEN CHIMNEY ROCK ROAD AND MAPLERIDGE | HOUSTON, TX 77081

CONTACT
SARAH CARTER, VP
713.231.1629

Sarah.Carter@transwestern.com

LEASING OPPORTUNITY FOR BUILD-TO-SUIT MEDICAL OFFICE

BELLAIRE MEDICAL PLAZA II

ON CLAREWOOD DRIVE BETWEEN CHIMNEY ROCK ROAD AND MAPLERIDGE | HOUSTON, TX 77081

AMENITIES

- Central Location in Bellaire on Clarewood at Mapleridge near the Bellaire and Bissonett intersection
- Within Close Proximity of the Texas Medical Center, Galleria, Downtown, and Hobby Airport
- Next to Cornerstone Specialty Hospitals - Bellaire and M.D. Anderson Diagnostic Imaging
- 1 Block from METRO Bus Route

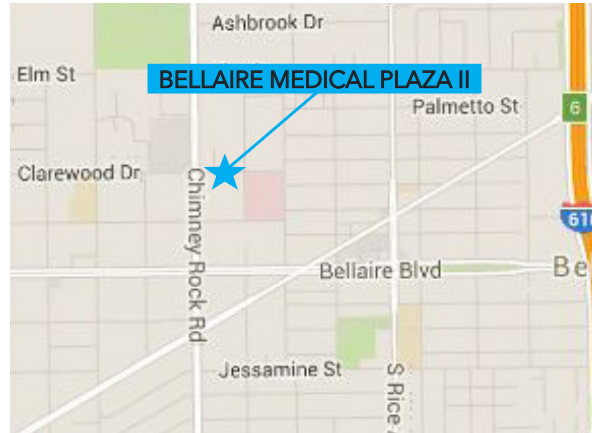

BUILDING SPECS

- Single-Story Build-to-suit Medical Office Building
- 10,000 Gross Square Feet
- Parking Ratio: 4:1,000

AVAILABILITIES

- 3,300 - 10,000 RSF

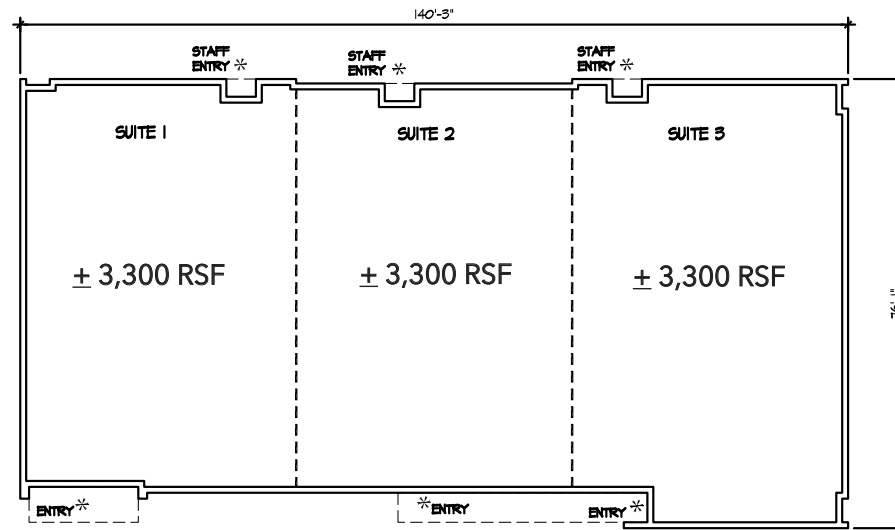

CONTACT
SARAH CARTER, VP
713.231.1629

Sarah.Carter@transwestern.com