

685 Route 10 E

Randolph, NJ

For
LEASE
60,160 SF

*For further information,
please contact
Exclusive Broker:*

Brian Wilson
bwilson@resource-realty.com

Scott Peck, SIOR
speck@resource-realty.com

Exclusive Marketing by:



**RESOURCE REALTY of
Northern New Jersey**

299 Cherry Hill Road,
Suite 202
Parsippany, New Jersey 07054

Phone: 973-299-0900

www.resource-realty.com



Available Space:

| | |
|-----------------------|--------------------|
| Building Size: | 60,160 SF |
| Office Area: | +/- 6,800 SF |
| Lease Price: | \$6.50 PSF NNN |
| Taxes: | \$1.49 PSF |
| Loading: | 6 Tailgates |
| Car Parking: | 50 (Approximately) |

Building Specifications:

| | | | |
|------------------------|---|--------------------|------------|
| Ceiling Height: | 21' | Water: | Municipal |
| Power: | 2000 Amps/480 Volts | Sewer: | Septic |
| Column Spacing: | 40' x 32' | Year Built: | 1968 |
| Sprinkler: | Wet | Taxes: | \$1.49 PSF |
| Heat: | Gas | Land: | 4.6 Acres |
| Zoning: | B-2 – permits retail, warehousing, distribution | | |
| Comments: | Available immediately, approximately 8 miles from Rt. 287, Route 10 visibility. | | |

685 Route 10 E

Randolph, NJ

Floor Plan

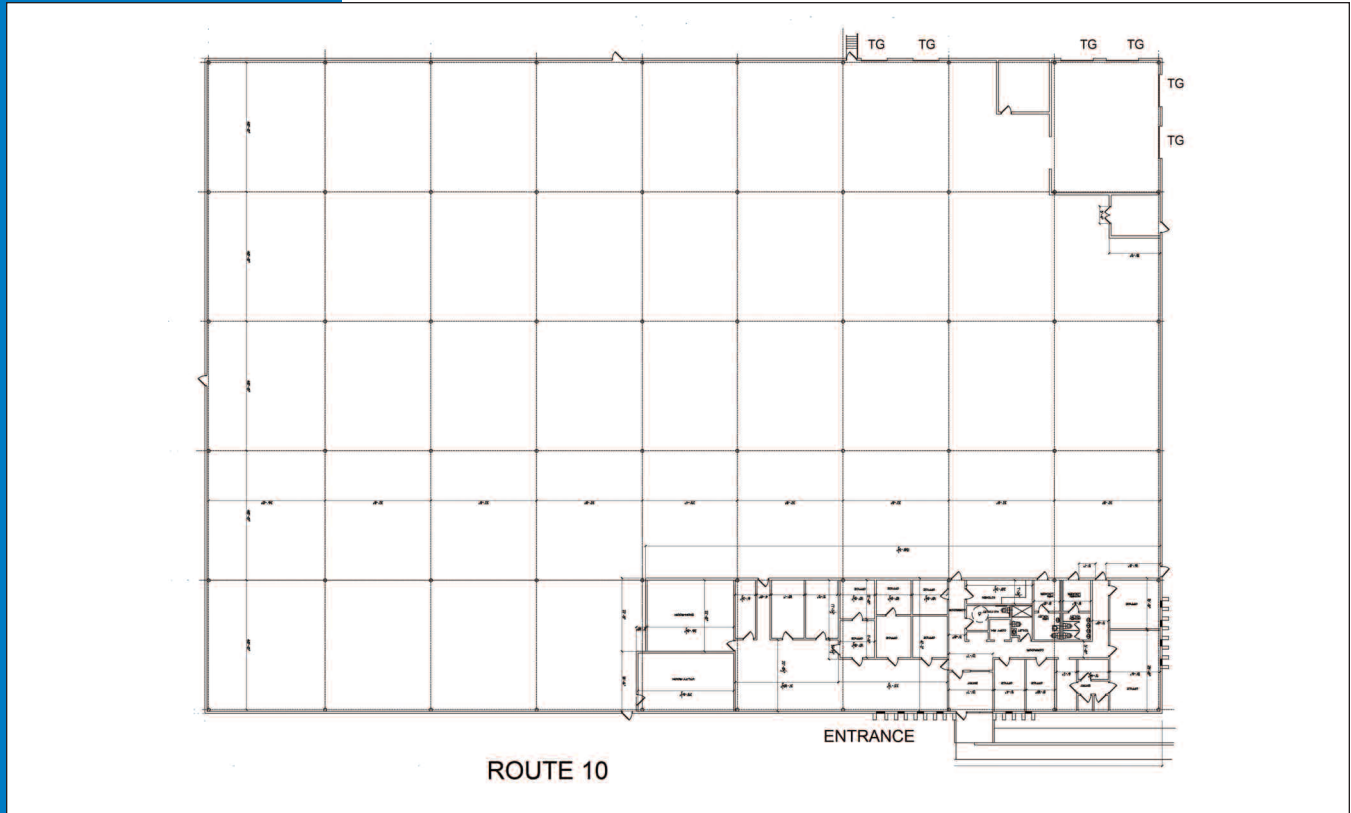

Map



Exclusive Marketing by:



Phone: 973-299-0900

www.resource-realty.com