

3413 S. TRYON STREET

EXCLUSIVE LISTING | CHARLOTTE, NORTH CAROLINA

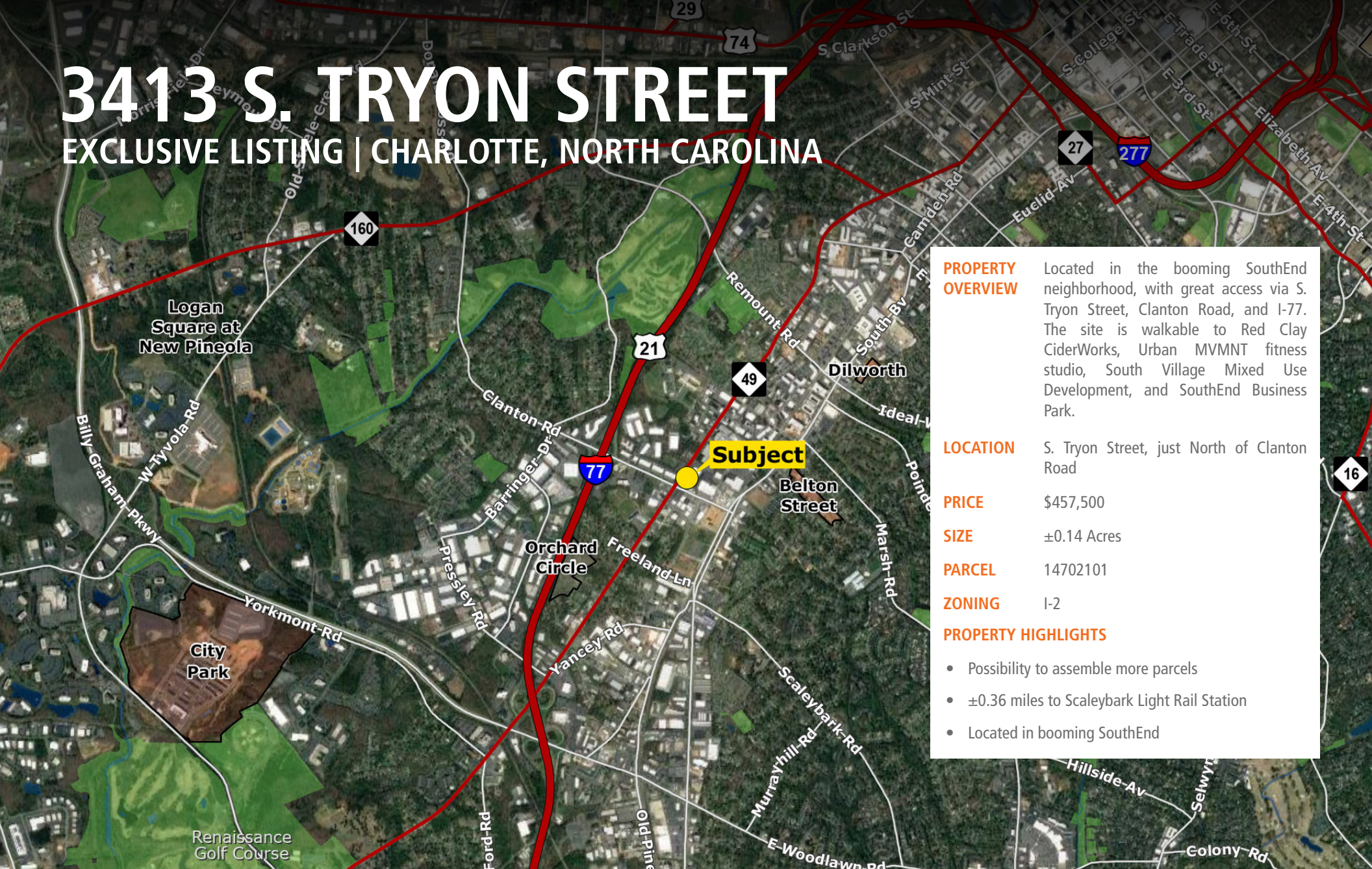

PROPERTY OVERVIEW Located in the booming SouthEnd neighborhood, with great access via S. Tryon Street, Clanton Road, and I-77. The site is walkable to Red Clay CiderWorks, Urban MVMNT fitness studio, South Village Mixed Use Development, and SouthEnd Business Park.

LOCATION S. Tryon Street, just North of Clanton Road

PRICE \$457,500

SIZE ±0.14 Acres

PARCEL 14702101

ZONING I-2

PROPERTY HIGHLIGHTS

- Possibility to assemble more parcels
- ±0.36 miles to Scaleybark Light Rail Station
- Located in booming SouthEnd

Forde Britt | fbritt@landadvisors.com

809 W. Hill Street, Charlotte, NC 28208, ph.704.594.7310 | landadvisors.com

The information contained herein is from sources deemed reliable. We have no reason to doubt its accuracy but do not guarantee it. It is the responsibility of the person reviewing this information to independently verify it. This package is subject to change, prior sale or complete withdrawal.
12 21 2018



REGIONAL MAP

Forde Britt | 704.351.3338 | www.landadvisors.com

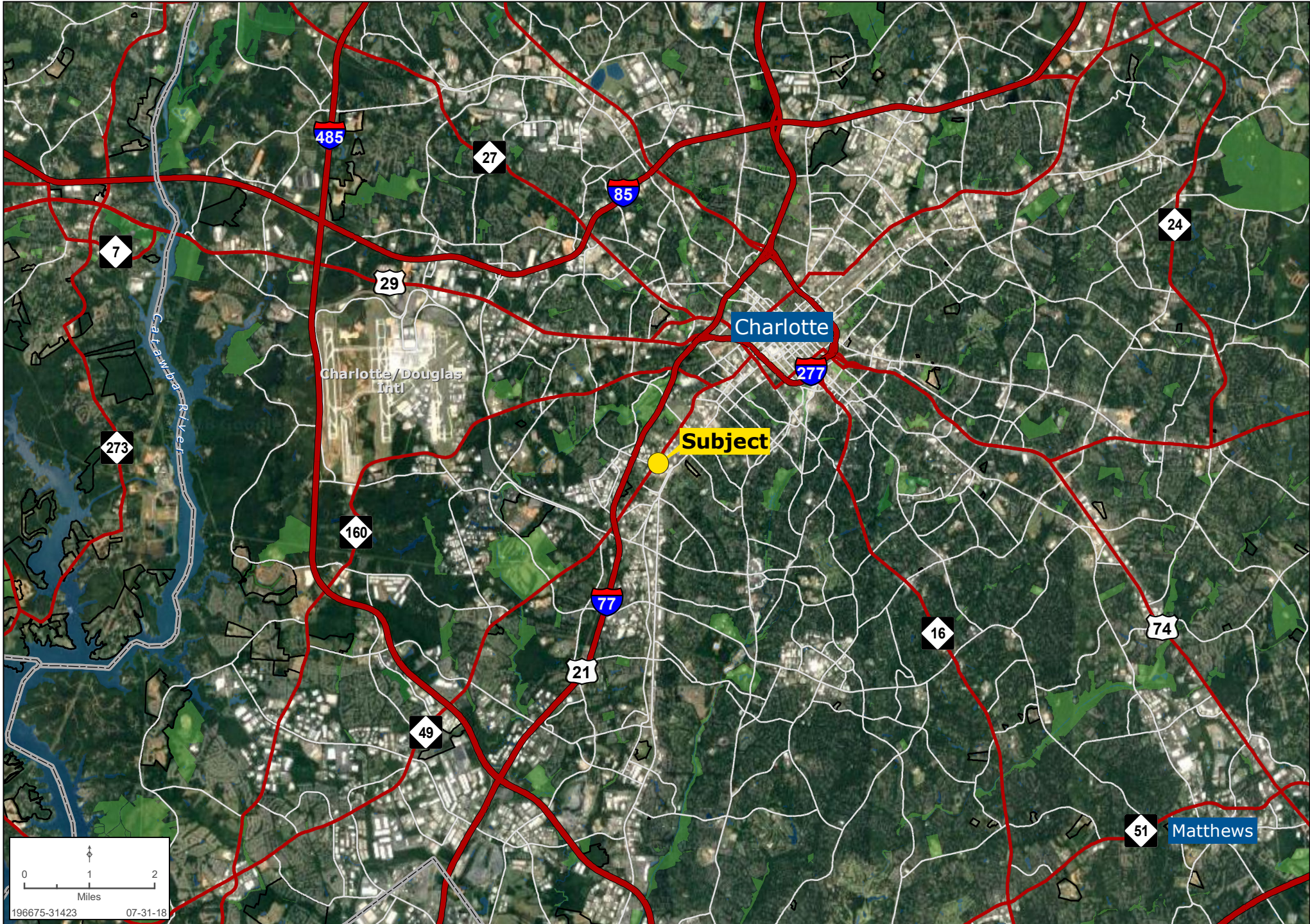

SURROUNDING ATTRACTIONS MAP

Forde Britt | 704.351.3338 | www.landadvisors.com

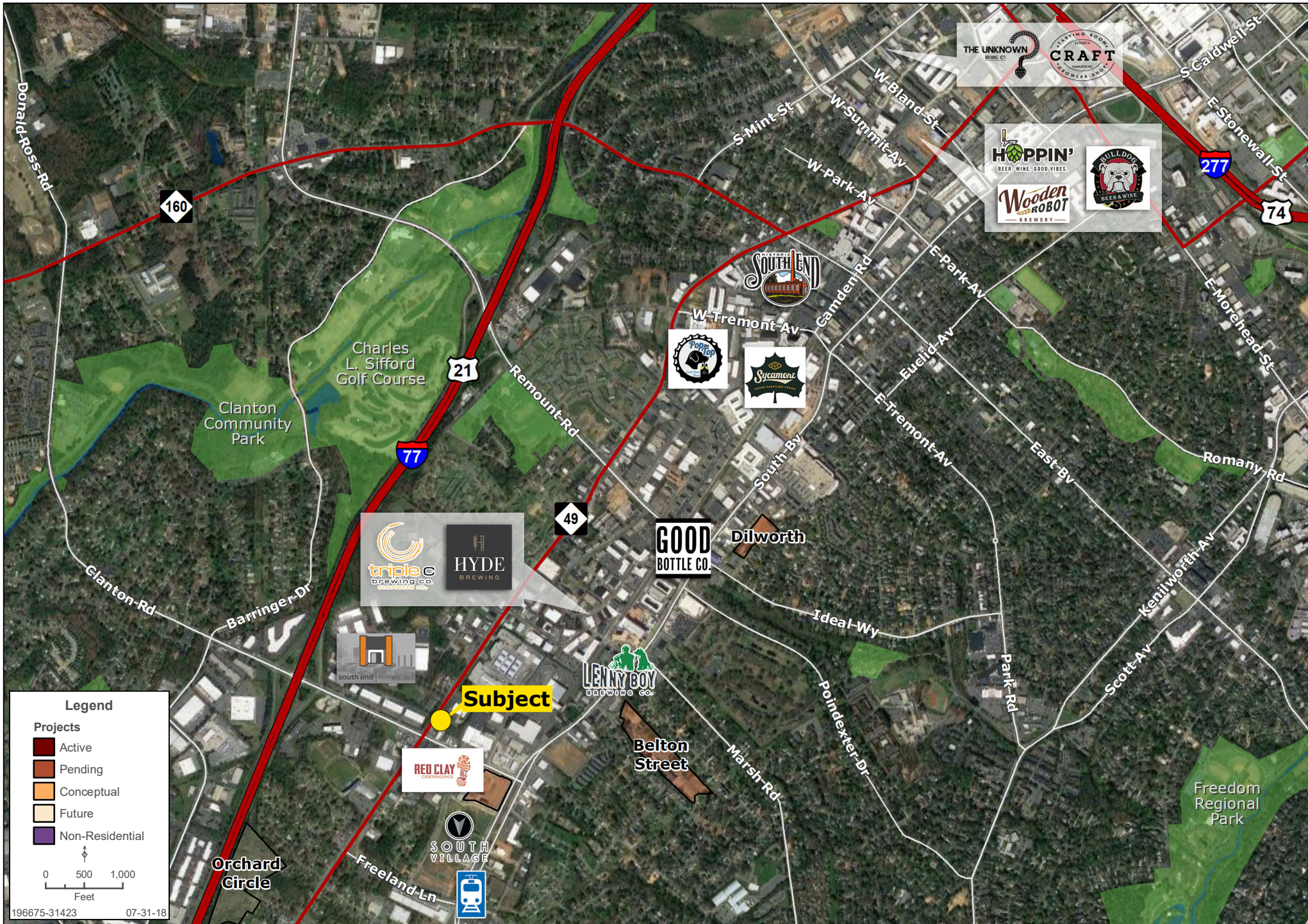

PROPERTY DETAIL MAP

Forde Britt | 704.351.3338 | www.landadvisors.com



0 25 50
Feet
196675-31423 07-31-18

3413 S. TRYON STREET | SOUTH END

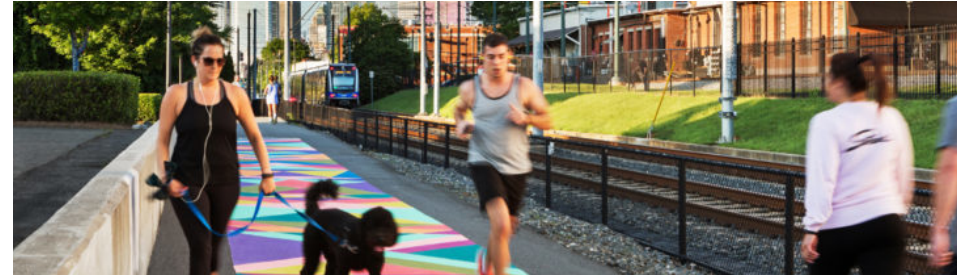

SOUTH END

The lively South End is known for its vibrant nightlife, with a number of craft breweries and laid-back pubs, plus buzzy restaurants serving elevated American and global cuisines. In an 1800s mill building, the Atherton Mill and Market has chic artisan shops, while the surrounding area is home to a number of fine art galleries. The Charlotte Rail Trail is popular with runners and cyclists.

