



# St. Johns County, FL

### Tax Bill

### Estimate Taxes

### 2020 TRIM Notice

### 2019 TRIM Notice

### Summary

**Parcel ID** 1358110161  
**Location Address** 87 MOULTRIE CREEK CIR  
 SAINT AUGUSTINE 32086-0000  
**Neighborhood** Moultrie Woods Townhouses (2256.01)  
**Tax Description\*** OR720/681 MOULTRIE WOODS BLDG 16 LOT A (AKA UNIT 16-A) OR3884/1399 &3920/1788(Q/C) &3941/1054(C/Q) &3956/245  
*\*The Description above is not to be used on legal documents.*  
**Property Use Code** Single Family Townhouse (0130)  
**Subdivision** N/A  
**Sec/Twp/Rng** 2-8-29  
**District** County (District 300)  
**Millage Rate** 13.3141  
**Acreage** 0.020  
**Homestead** N

### Owner Information

**Owner Name** Bacon James E Et AL 100%  
[Scheufler-Bacon Loell J](#) 100%  
**Mailing Address** 55 FERROL RD  
 SAINT AUGUSTINE, FL 32084-0000

### Map



**Valuation Information**

	2021
Building Value	\$54,507
Extra Features Value	\$0
Total Land Value	\$24,000
Agricultural (Assessed) Value	\$0
Agricultural (Market) Value	\$0
Just (Market) Value	<b>\$78,507</b>
Total Deferred	\$7,932
Assessed Value	<b>\$70,575</b>
Total Exemptions	\$0
Taxable Value	<b>\$70,575</b>

*Values listed are from our working tax roll and are subject to change.*

**Historical Assessment Information**

Year	Building Value	Extra Feature Value	Total Land Value	Ag (Market) Value	Ag (Assessed) Value	Just (Market) Value	Assessed Value	Exempt Value	Taxable Value
2020	\$56,134	\$0	\$24,000	\$0	\$0	\$80,134	\$64,159	\$15,975	\$64,159
2019	\$54,936	\$0	\$24,000	\$0	\$0	\$78,936	\$58,326	\$20,610	\$58,326
2018	\$50,618	\$0	\$24,000	\$0	\$0	\$74,618	\$53,024	\$21,594	\$53,024
2017	\$44,060	\$0	\$17,000	\$0	\$0	\$61,060	\$48,204	\$12,856	\$48,204
2016	\$35,822	\$0	\$8,000	\$0	\$0	\$43,822	\$43,822	\$0	\$43,822
2015	\$36,860	\$0	\$8,000	\$0	\$0	\$44,860	\$44,860	\$0	\$44,860
2014	\$36,860	\$0	\$9,000	\$0	\$0	\$45,860	\$45,269	\$591	\$45,269
2013	\$31,654	\$0	\$9,500	\$0	\$0	\$41,154	\$41,154	\$0	\$41,154
2012	\$28,968	\$0	\$11,500	\$0	\$0	\$40,468	\$40,468	\$0	\$40,468
2011	\$43,272	\$0	\$12,500	\$0	\$0	\$55,772	\$55,772	\$0	\$55,772
2010	\$62,333	\$0	\$20,000	\$0	\$0	\$82,333	\$82,333	\$0	\$82,333

**Building Information**

<b>Building</b>	1	<b>Roof Structure</b>	Gable Hip
<b>Actual Area</b>	1196	<b>Roof Cover</b>	Composite Shingle
<b>Conditioned Area</b>	1078	<b>Interior Flooring</b>	Carpet, Ceramic Tile
<b>Actual Year Built</b>	1986	<b>Interior Wall</b>	Drywall
<b>Use</b>	Single Family Townhouse	<b>Heating Type</b>	Air Duct
<b>Style</b>	01	<b>Heating Fuel</b>	
<b>Class</b>	N	<b>Air Conditioning</b>	Central
<b>Exterior Wall</b>	Stucco, Wood	<b>Baths</b>	

Category	Type	Pct
Exterior Wall	Wood	80%
Exterior Wall	Stucco	20%
Roofing Structure	Gable Hip	100%
Roofing Cover	Composite Shingle	100%
Interior Walls	Drywall	100%
Interior Flooring	Carpet	95%
Interior Flooring	Ceramic Tile	5%
Heating Type	Air Duct	100%
Air Conditioning	Central	100%
Frame	Wood Frame	100%
Plumbing	7 Fixtures	100%
Electrical	Good	100%
Foundation	Concrete Perimeter Footing	100%
Condition	Average	100%
Floor System	Concrete Slab	100%

Description	Conditioned Area	Actual Area
SLAB	0	60
BASE AREA	512	512
FINISHED UPPER STORY	512	512
FRAME UTILITY	0	16
FINISHED OPEN PORCH	0	42
BASE AREA	54	54
Total SqFt	1078	1196

**Land Information**

Use Description	Front	Depth	Total Land Units	Unit Type	Land Value
Single Family Townhouse	0	0	1	UT	\$24,000

**Sale Information**

Recording Date	Sale Date	Sale Price	Instrument Type	Book	Page	Qualification	Vacant/Improved	Grantor	Grantee
11/20/2014	11/19/2014	\$100.00	WD	<a href="#">3956</a>	<a href="#">245</a>	U	I	MC DONALD ALTON D TRUSTEE	BACON JAMES E & LOELL J SCHEUFLER-
10/13/2014	10/3/2014	\$0.00	CQ	<a href="#">3941</a>	<a href="#">1054</a>	U	I	KITCHENS TAM DAVID &	BACON JAMES E, LOELL J & MC DONALD ALTON DAVID LIVING TRUST
8/22/2014	8/20/2014	\$100.00	QC	<a href="#">3920</a>	<a href="#">1788</a>	U	I	KITCHENS TAM DAVID & MC DONALD ALTON D	BACON JAMES, LOELL & MC DONALD ALTON DAVID LIVING TRUST
5/29/2014	5/22/2014	\$100.00	WD	<a href="#">3884</a>	<a href="#">1399</a>	U	I	BACON JAMES, LOELL & MC DONALD ALTON D	BACON JAMES, LOELL & MC DONALD ALTON D, KITCHENS TAM DAVID
12/10/2012	10/31/2012	\$41,500.00	WD	<a href="#">3654</a>	<a href="#">825</a>	U	I	PRIOR CAROLE F	BACON JAMES, LOELL & MC DONALD ALTON D
9/4/2007	8/31/2007	\$125,000.00	WD	<a href="#">2976</a>	<a href="#">1840</a>	Q	I	CHILDS THERESA A	PRIOR CAROLE F
	8/30/2002	\$83,900.00	WD	<a href="#">1809</a>	<a href="#">100</a>	Q	I	PECK DOROTHY L	CHILDS THERESA A
	1/1/1987	\$54,025.00		<a href="#">732</a>	<a href="#">1785</a>	Q	I		PECK DOROTHY L
	1/1/1986	\$0.00		<a href="#">720</a>	<a href="#">668</a>	U	V		

**Sketch Information**

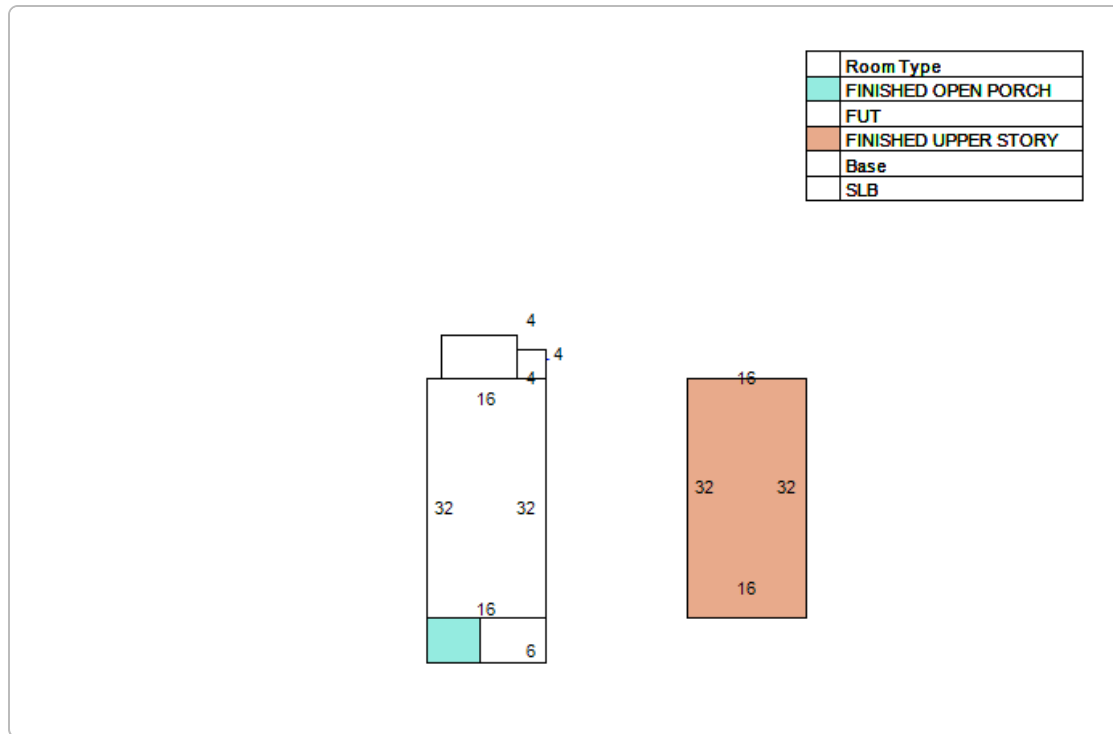

No data available for the following modules: Exemption Information, Extra Feature Information.

[User Privacy Policy](#)  
[GDPR Privacy Notice](#)

Last Data Upload: 10/13/2020, 12:17:40 AM



Version 2.3.90