

# COUNTRY SQUARE

10400 South & Redwood Road (NWC)  
South Jordan, Utah



**RETAIL**  
FOR LEASE

**Adam Lewis**

RETAIL SPECIALIST

☎ 801.838.9627  
📠 801.949.8381  
✉ adam@situsretail.com

**Hunter Todd**

RETAIL SPECIALIST

☎ 801.838.9630  
📠 801.808.8146  
✉ hunter@situsretail.com





# COUNTRY SQUARE

10400 South & Redwood Road (NWC)  
South Jordan, Utah

**Adam Lewis**

RETAIL SPECIALIST

☎ 801.838.9627

📠 801.949.8381

✉ adam@situsretail.com

**Hunter Todd**

RETAIL SPECIALIST

☎ 801.838.9630

📠 801.808.8146

✉ hunter@situsretail.com



## ✓ SUMMARY

- ✓ Sizes: 1,132 to 2,272 SF
- ✓ Lease Rate: \$14 PSF
- ✓ NNNs: \$5.35 PSF (est.)
- ✓ Availability: Immediate

## ☞ FEATURES

- ☞ Access/Visibility from Redwood Rd & 10400 South
- ☞ High-Growth Area
- ☞ Great Traffic Counts
- ☞ Nearby Tenants:



# COUNTRY SQUARE

10400 South & Redwood Road (NWC)  
South Jordan, Utah

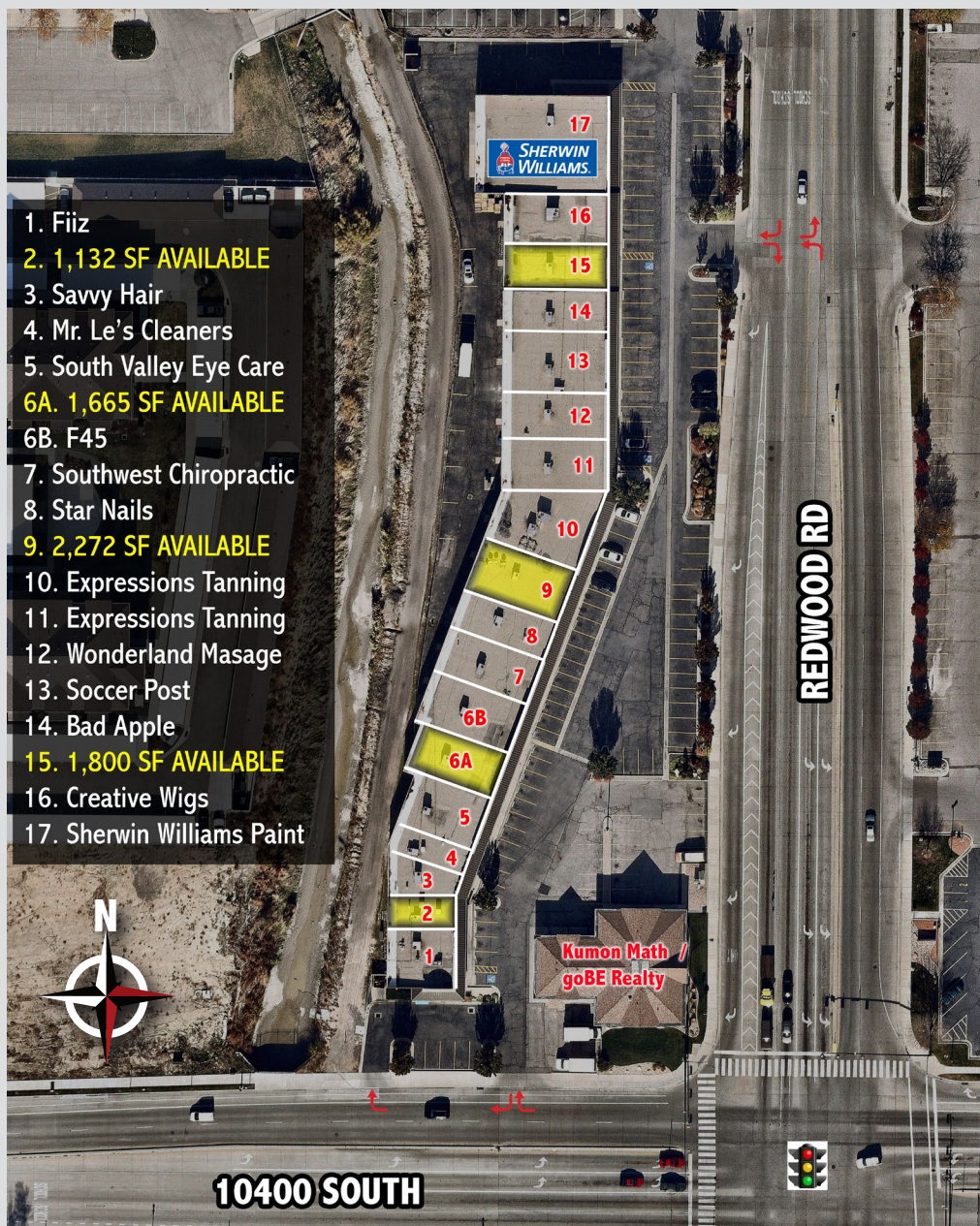

**Adam Lewis**

RETAIL SPECIALIST

☎ 801.838.9627

☎ 801.949.8381

✉ adam@situsretail.com

**Hunter Todd**

RETAIL SPECIALIST

☎ 801.838.9630

☎ 801.808.8146

✉ hunter@situsretail.com



# 3 MILE DEMOGRAPHICS

2019  
Population



100,038

2019 Average  
Household Income



\$116,126

2019  
Households



31,878

5-Year Population  
Growth



6.1%

2019  
Employees



57,325



## DEMOGRAPHIC REPORT

		1 mi ring		3 mi ring		5 mi ring	
Population	2019	<b>10,404</b>		<b>100,038</b>		<b>307,036</b>	
	2024	11,070		106,170		325,217	
	2010	8,541		80,594		252,437	
	2000	7,438	%	63,549	%	202,797	%
Households		<b>3,558</b>		<b>31,878</b>		<b>97,684</b>	
	Average household size	2.92		3.13		3.13	
Household income	< \$25,000	304	8.5	2,270	7.1	8,363	8.6
	\$25,000 - \$49,999	408	11.5	4,053	12.7	14,291	14.6
	\$50,000 - \$74,999	500	14.1	5,926	18.6	19,523	20.0
	\$75,000 - \$99,999	521	14.6	5,537	17.4	17,041	17.4
	\$100,000+	1,824	51.3	14,096	44.2	38,467	39.4
	Median household income	\$99,638		\$92,592		\$83,706	
	Average household income	<b>\$119,369</b>		<b>\$116,126</b>		<b>\$102,794</b>	
Total employees		6,842		57,325		131,507	
Business establishments		650		4,629		11,490	
	Industrial	51	7.8	486	10.5	1,330	11.6
	Manufacturing	7	1.1	92	2.0	249	2.2
	Commercial	156	24.0	1,309	28.3	3,400	29.6
	Office	335	51.5	2,032	43.9	4,681	40.7
	Other	101	15.5	710	15.3	1,830	15.9
Race	White	9,457	90.9	86,784	86.8	259,768	84.6
	Black	112	1.1	1,659	1.7	4,984	1.6
	American Indian	34	0.3	295	0.3	1,313	0.4
	Asian & PI	352	3.4	4,422	4.4	13,492	4.4
	Other	449	4.3	6,879	6.9	27,478	8.9
Hispanic population		681	6.5	10,676	10.7	41,546	13.5
Sex	Male	5,126	49.3	50,070	50.1	153,111	49.9
	Female	5,277	50.7	49,968	49.9	153,925	50.1
Median age		39.2		34.6		34.2	

## COUNTRY SQUARE

10400 South & Redwood Road (NWC)  
South Jordan, Utah

**Adam Lewis**

RETAIL SPECIALIST

☎ 801.838.9627

📠 801.949.8381

✉ adam@situsretail.com

**Hunter Todd**

RETAIL SPECIALIST

☎ 801.838.9630

📠 801.808.8146

✉ hunter@situsretail.com

