

*Now Leasing Premier Retail Space*

# 215 Saint Paul Street

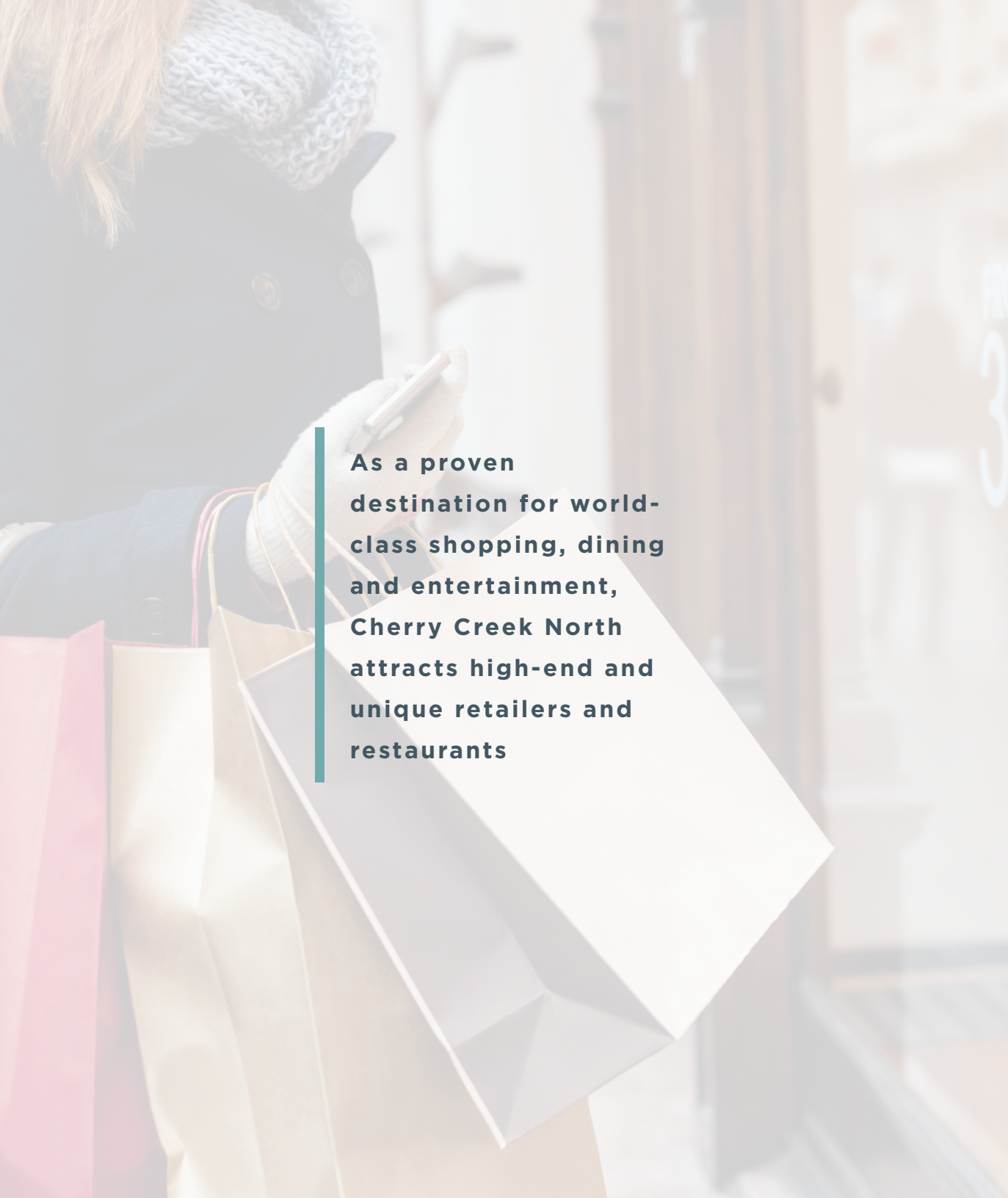



As a proven destination for world-class shopping, dining and entertainment, Cherry Creek North attracts high-end and unique retailers and restaurants

## PROPERTY OVERVIEW

Cherry Creek North Retail

Retail / Restaurant Space

Hard Corner

2,970 SF Available

## CHERRY CREEK



RESIDENTIAL UNITS

**270%**

INCREASE IN  
RESIDENCES FROM 2010



HOTEL ROOMS

**300+%**

INCREASE IN  
ROOMS SINCE 2010



TOTAL RETAIL SPACE

**33%**

INCREASE IN SQUARE FEET  
OF SPACE FROM 2010



TOTAL OFFICE SPACE

**25%**

INCREASE IN SQUARE FEET  
OF RETAIL FROM 2010

*Source: Cherry Creek Area Business Alliance*

# DEMOGRAPHICS



## POPULATION

1 MILE	2 MILE	3 MILE
18,274	114,181	220,173



## HOUSEHOLDS

1 MILE	2 MILE	3 MILE
9,587	64,226	115,119



## AVG. HH INCOME

1 MILE	2 MILE	3 MILE
\$181,354	\$101,210	\$95,425



## DAYTIME POP.

1 MILE	2 MILE	3 MILE
20,167	82,136	200,486

**\$181,354**

Average Income within 1 Mile

Garage  
Parking  
Available  
(303)  
297-8912

WALK SCORE

**96**

“Walker’s Paradise”

BIKE SCORE

**85**

“Very Bikeable”

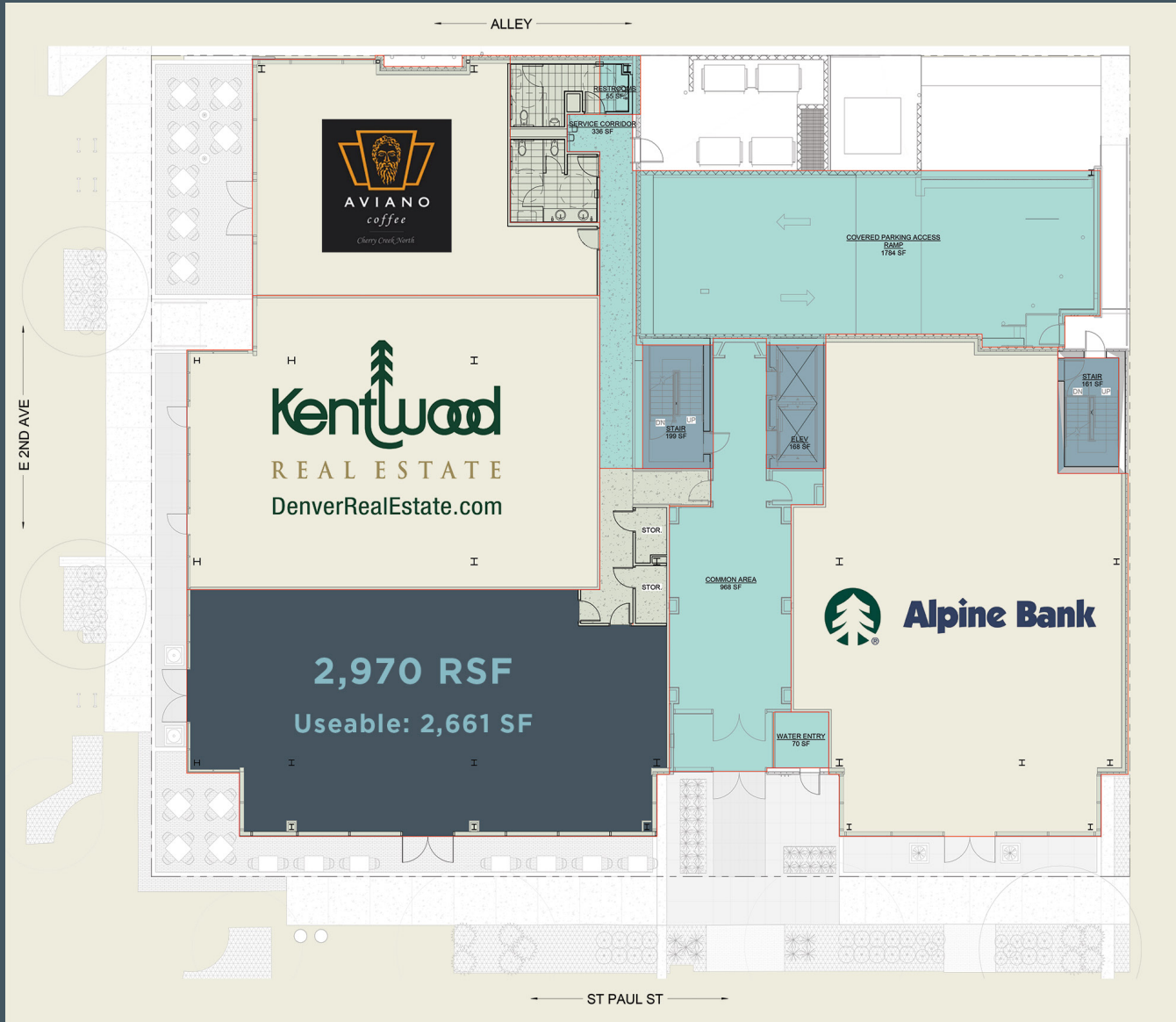

2,970 SF Hard Corner Space Available



BROMWELL  
ELEMENTARY

HILLSTONE

christy  
sports  
your ski and patio shop

MACHETE

CUCINA  
COLORE

VITALITY BOWLS

E 3RD AVE

SUITSUPPLY

**SITE**

Room&Board

SOULCYCLE  
CB2

STARBUCKS

PAPER SOURCE

WALKER  
TAYLOR

REX

HASU  
SUSHI

Sherry  
CRICKET

ORVIS

EILEEN FISHER

FELICE

WELLS  
FARGO

Pet's Coffee & Tea

HW HOME

True Food

HMK

Patxi's  
pizza

WHOLE  
FOODS

Sur la table

hapa

prAna

LE CREUSET

CHERRY  
CREEK  
GRILL

Crate&Barrel

JW MARRIOTT

THE NORTH  
FACE

HERMES  
PARIS

west elm

PIATTI

title nine

E 1ST AVE

tbank

WELLS  
FARGO

CHIPOTLE

ELWAYS The Container Store

BRIO

RESTORATION  
HARDWARE

NORDSTROM

Neiman Marcus

Matsuhisa

at&t



CHERRY CREEK  
MALL



macy's

DENVER  
COUNTRY  
CLUB

UNIVERSITY BLVD

CHERRY CREEK DR'S

STEELE ST

KEY

-  Planned Redevelopment
-  Active Redevelopment





[www.creginc.com](http://www.creginc.com)

303 398 2111

**L I S T I N G   B R O K E R S**

**Rhonda Coy**

720 287 6866

[rcoy@creginc.com](mailto:rcoy@creginc.com)

**Scott Steputis**

720 287 6868

[step@creginc.com](mailto:step@creginc.com)

