



UEI  
COLLEGE

9215 N Black Canyon HWY, Phoenix, Arizona

100% Leased Single-Tenant Office  
Building Totaling ±38,086 SF in the  
Northwest Phoenix Submarket





UEI  
COLLEGE

Contact | Kidder Mathews

**Darren Tappen**

Senior Vice President, Partner  
602.513.5112  
dtappen@kiddermathews.com

**Peter Beauchamp**

Senior Vice President, Partner  
949.557.5010  
peterb@kiddermathews.com

Contact | Colliers International

**Todd Noel**

Executive Vice President  
602.222.5190  
todd.noel@colliers.com

This information supplied herein is from sources we deem reliable. It is provided without any representation, warranty or guarantee, expressed or implied as to its accuracy. Prospective Buyer or Tenant should conduct an independent investigation and verification of all matters deemed to be material, including, but not limited to, statements of income and expenses. Consult your attorney, accountant, or other professional advisor.

[kiddermathews.com](http://kiddermathews.com)

[colliers.com](http://colliers.com)



## PROPERTY DESCRIPTION

<b>Property</b>	9215 N Black Canyon Highway Phoenix, Arizona
<b>Type</b>	Single Tenant Office Building
<b>Year Built</b>	1984; renovated in 2013
<b>Rentable SF</b>	±38,086 SF
<b>Lot Size</b>	±4.326 AC (±188,428 SF)
<b>Floors</b>	Two (2)
<b>Tenant</b>	IEC US Holdings, Inc.
<b>Occupancy</b>	100%
<b>Elevators</b>	One (1)
<b>Construction</b>	Steel with Stucco Exterior
<b>Parking</b>	Over 10/1,000 SF
<b>Zoning</b>	C-2, Phoenix
<b>APN</b>	149-12-001-Q

## ANNUAL RENT

INVESTMENT YEARS	ANNUAL RENT	PER SF
10/1/2014 - 09/30/2015	\$476,075	\$12.50
10/1/2015 - 09/30/2016	\$487,882	\$12.81
10/1/2016 - 09/30/2017	\$500,069	\$13.13
10/1/2017 - 09/30/2018	\$512,628	\$13.46
<b>10/1/2018 - 09/30/2019</b>	<b>\$525,587</b>	<b>\$13.80</b>
10/1/2019 - 09/30/2020	\$538,917	\$14.15
10/1/2020 - 09/30/2021	\$552,247	\$14.50
10/1/2021 - 09/30/2022	\$565,958	\$14.86
10/1/2022 - 09/30/2023	\$580,050	\$15.23
10/1/2023 - 09/30/2024	\$594,522	\$15.61
10/1/2024 - 09/30/2025	\$609,376	\$16.00

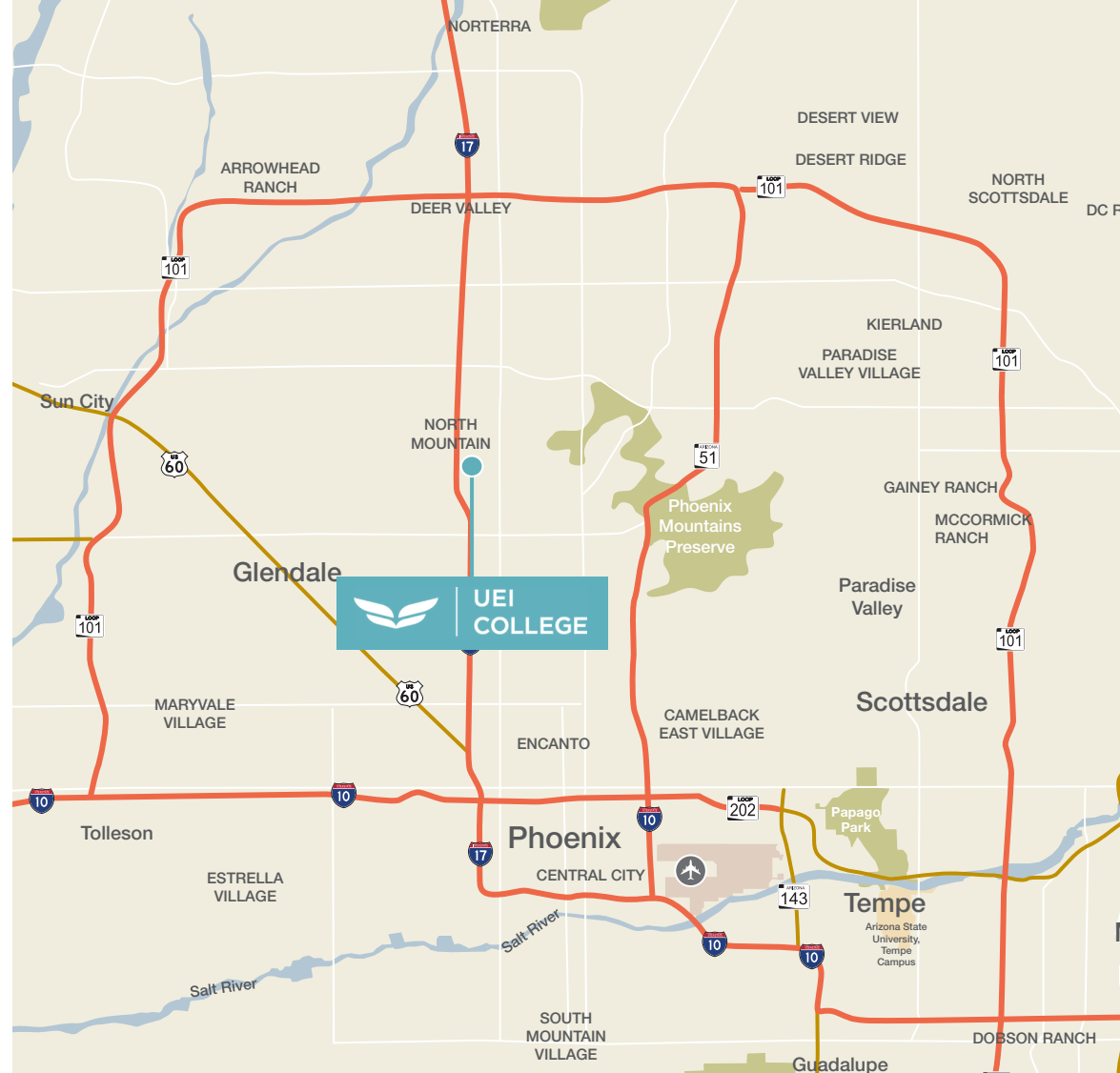

# United Education Institute

## SITE PLAN

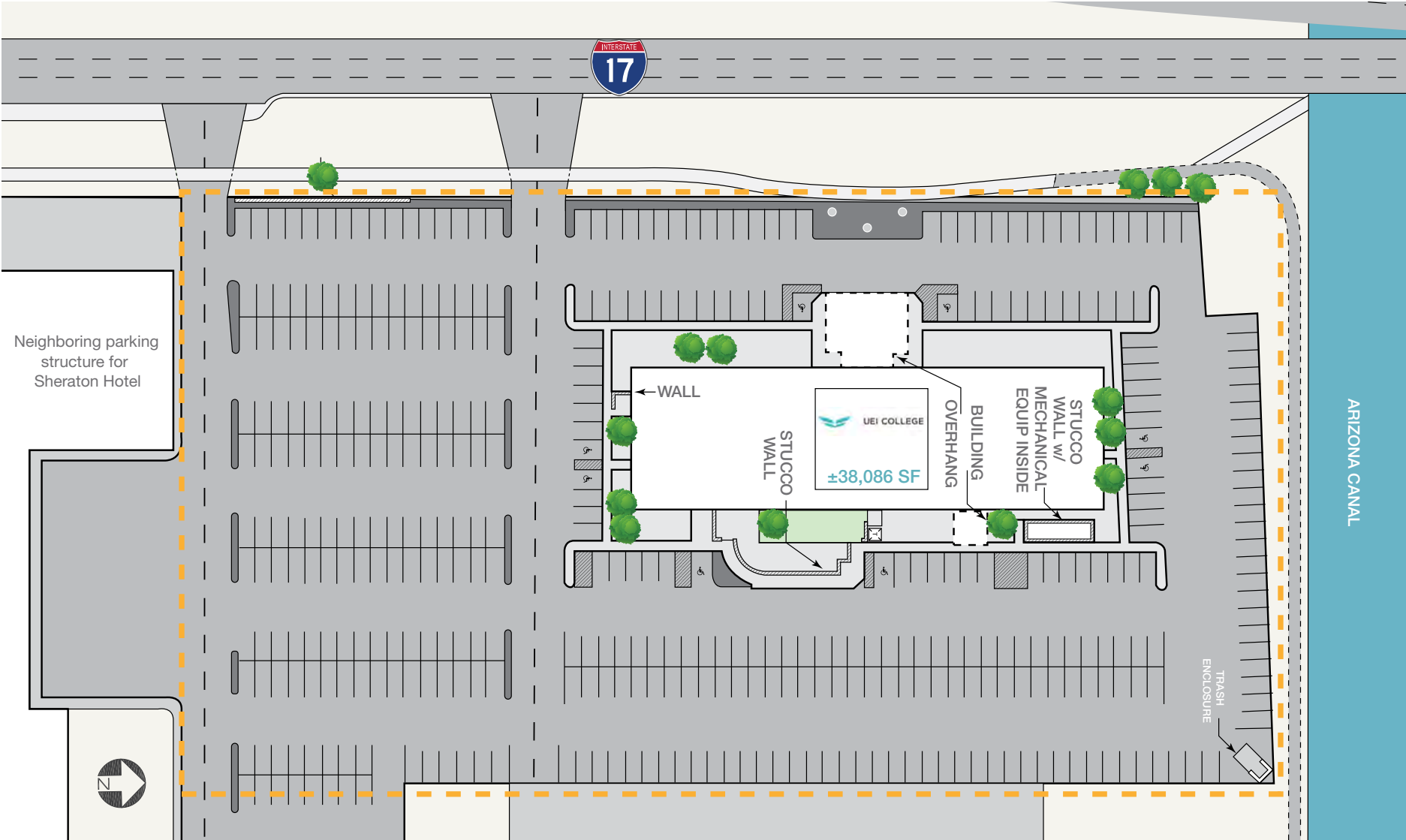

# United Education Institute

## FLOOR PLANS

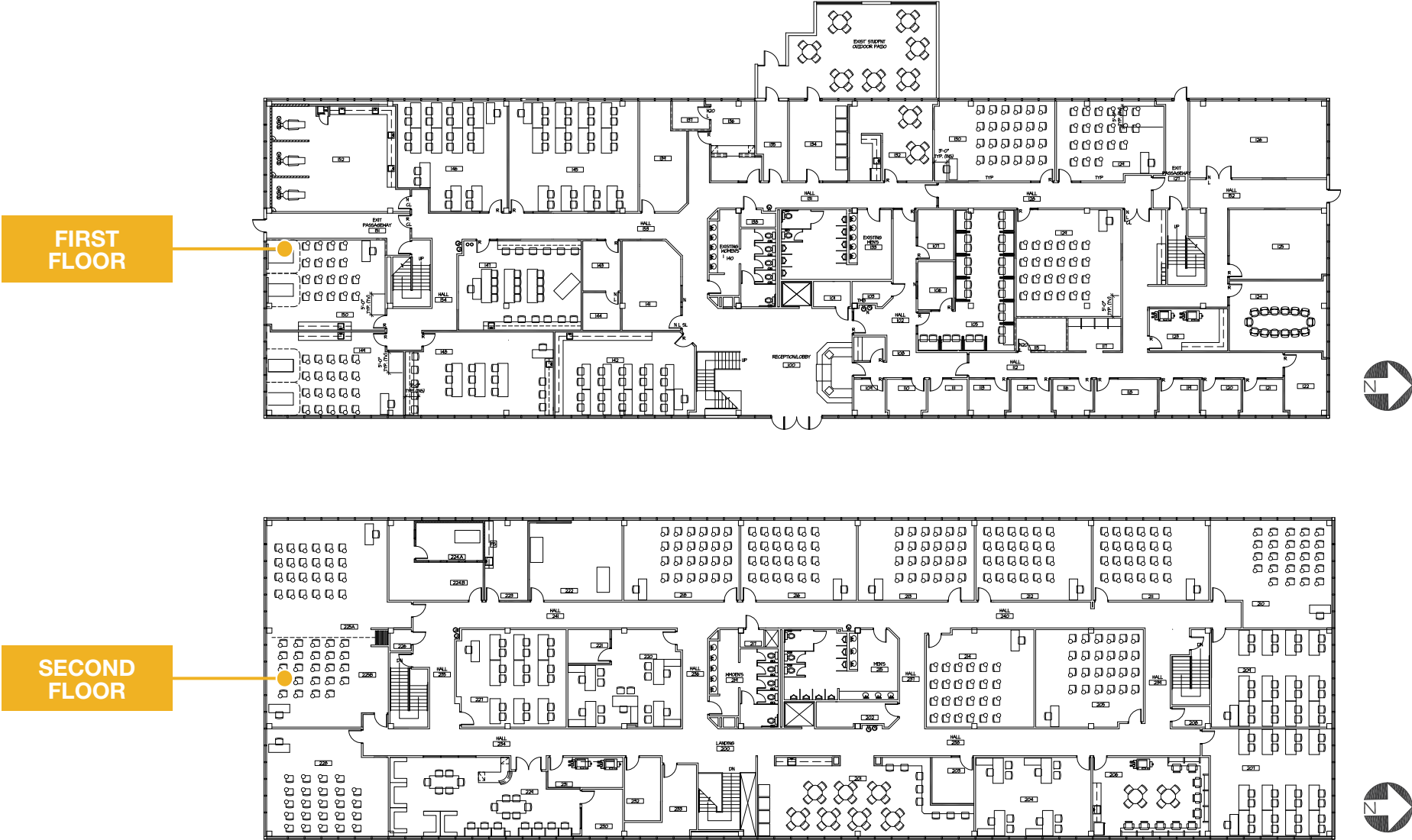

METRO SQUARE



METRO BUSINESS CENTER

W Peoria Ave



KARSTEN INDUSTRIAL PARK

N 23rd Ave

DESERT CANYON CORPORATE

ROSE MOFFORD SPORTS COMPLEX

METRO CENTER



SANFORD BROWN

OTTOWA UNIVERSITY



DEER VALLEY WATER

W Dunlap Ave



METRO MARKETPLACE



KOLL BUSINESS

BROOKLINE

Contact | Kidder Mathews

**Darren Tappen**

Senior Vice President, Partner  
602.513.5112  
dtappen@kiddermathews.com

**Peter Beauchamp**

Senior Vice President, Partner  
949.557.5010  
peterb@kiddermathews.com

Contact | Colliers International

**Todd Noel**

Executive Vice President  
602.222.5190  
todd.noel@colliers.com

[kiddermathews.com](http://kiddermathews.com)

[colliers.com](http://colliers.com)

