

CORPORATE PARKWAY NORTH

16404 N BLACK CANYON HWY | PHOENIX, AZ

16404

CBRE

SECOND CITY
REAL ESTATE



CORPORATE PARKWAY NORTH

PROPERTY FEATURES



Two-story atrium provides multiple collaboration spaces



Corporate neighbors include Paychex Regional Facility and Teletch/Revana



10-person conference room available to tenants



Canyon Deli open from 7am - 4pm



Freight elevator + loading dock



Parking: 6.5/1,000



Wi-Fi connected throughout building

AVAILABILITIES

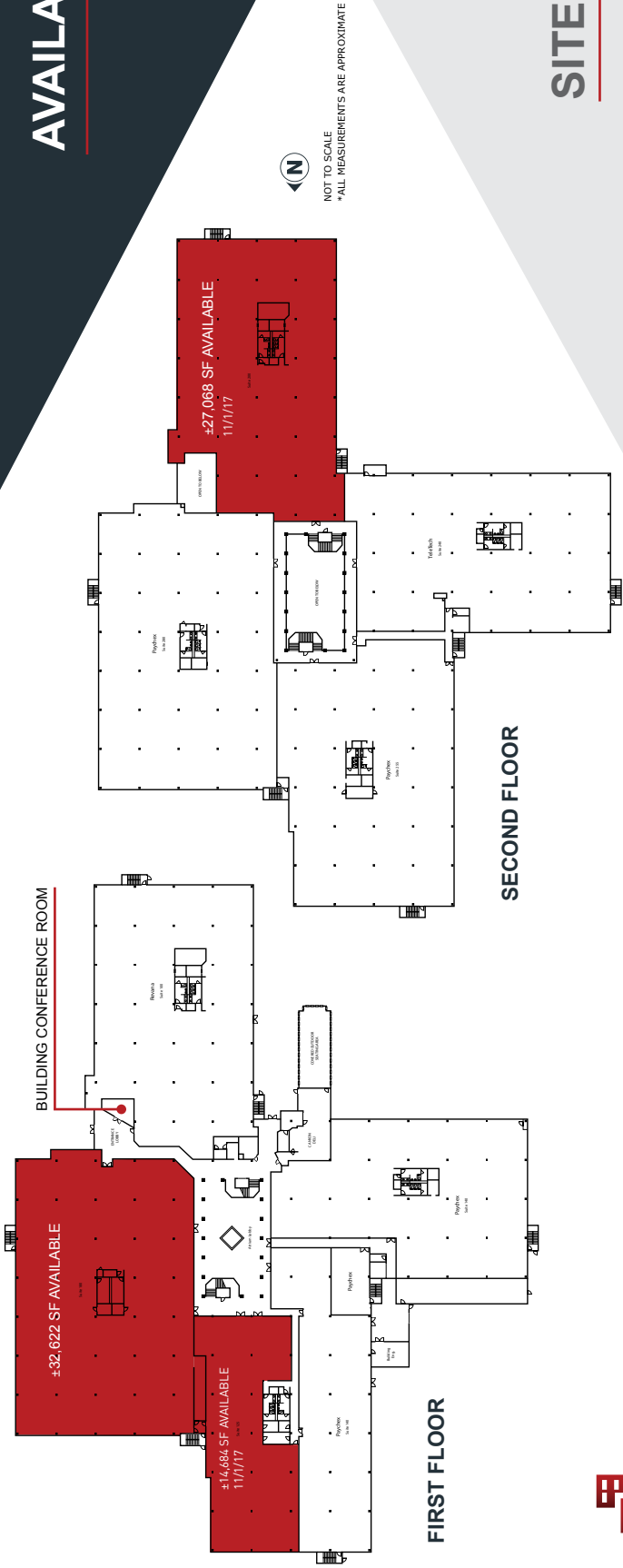

SITE PLAN

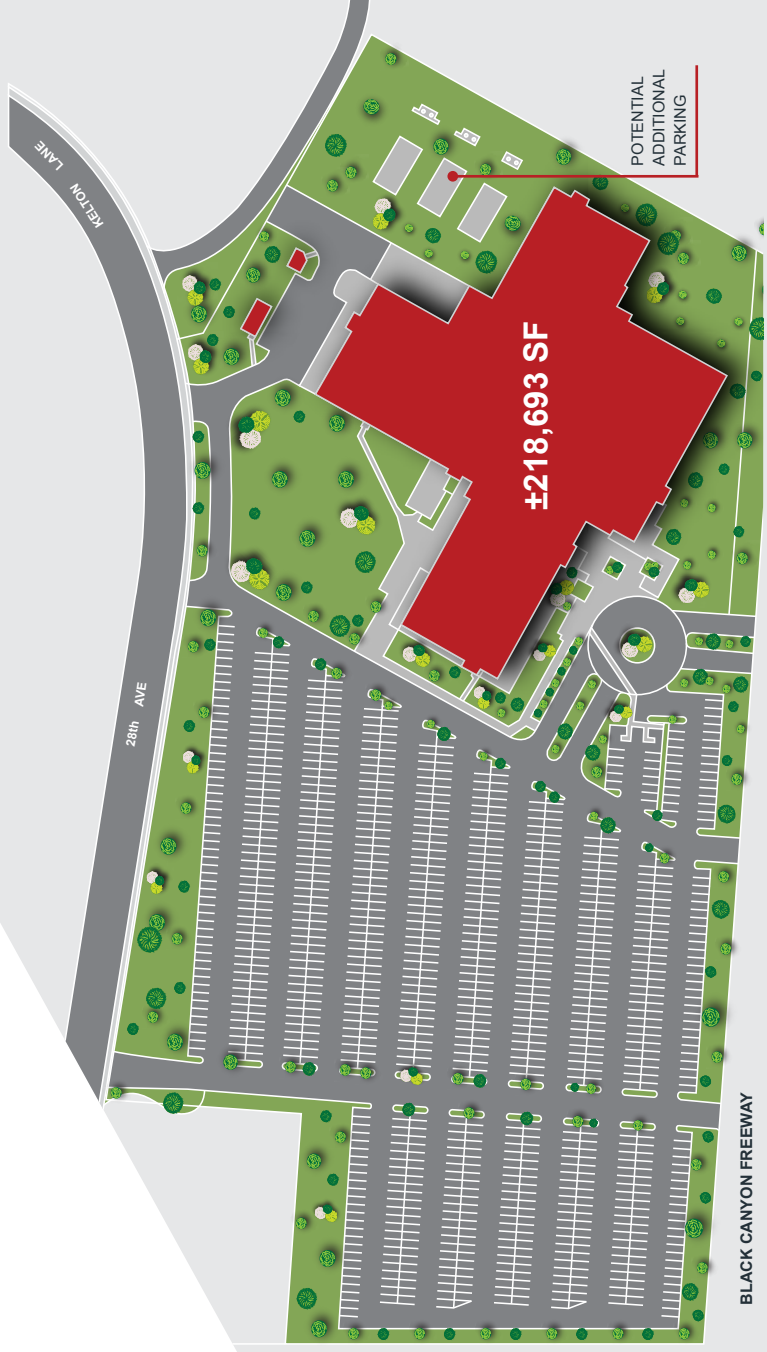

Suite 125 | ±14,684 SF (Available 11/1/17)*

Suite 180 | ±32,622 SF*

Suite 200 | ±27,068 SF (Available 11/1/17)

*Contiguous for ±47,306 SF



CORPORATE PARKWAY NORTH

16404 N BLACK CANYON HWY | PHOENIX, AZ

James Bayless

Senior Vice President

+1 602 735 1794

james.bayless@cbre.com

Ashley Brooks

Senior Vice President

+1 602 735 1758

ashley.brooks@cbre.com



©2017 CBRE, Inc. All rights reserved. This information has been obtained from sources believed reliable, but has not been verified for accuracy or completeness. Any projections, opinions, or estimates are subject to uncertainty. The information may not represent the current or future performance of the property. You and your advisors should conduct a careful, independent investigation of the property and verify all information. Any reliance on this information is solely at your own risk. CBRE and the CBRE logo are service marks of CBRE, Inc. and/or its affiliated or related companies in the United States and other countries. All other marks displayed on this document are the property of their respective owners. Photos herein are the property of their respective owners and use of these images without the express written consent of the owner is prohibited. PMSStudio_May2017

NOT TO SCALE

