

Professional/Medical/Retail  
Development Opportunity  
**5.25± Acres for Sale**

**208 E. Jimmie Leeds Road**  
Galloway, New Jersey

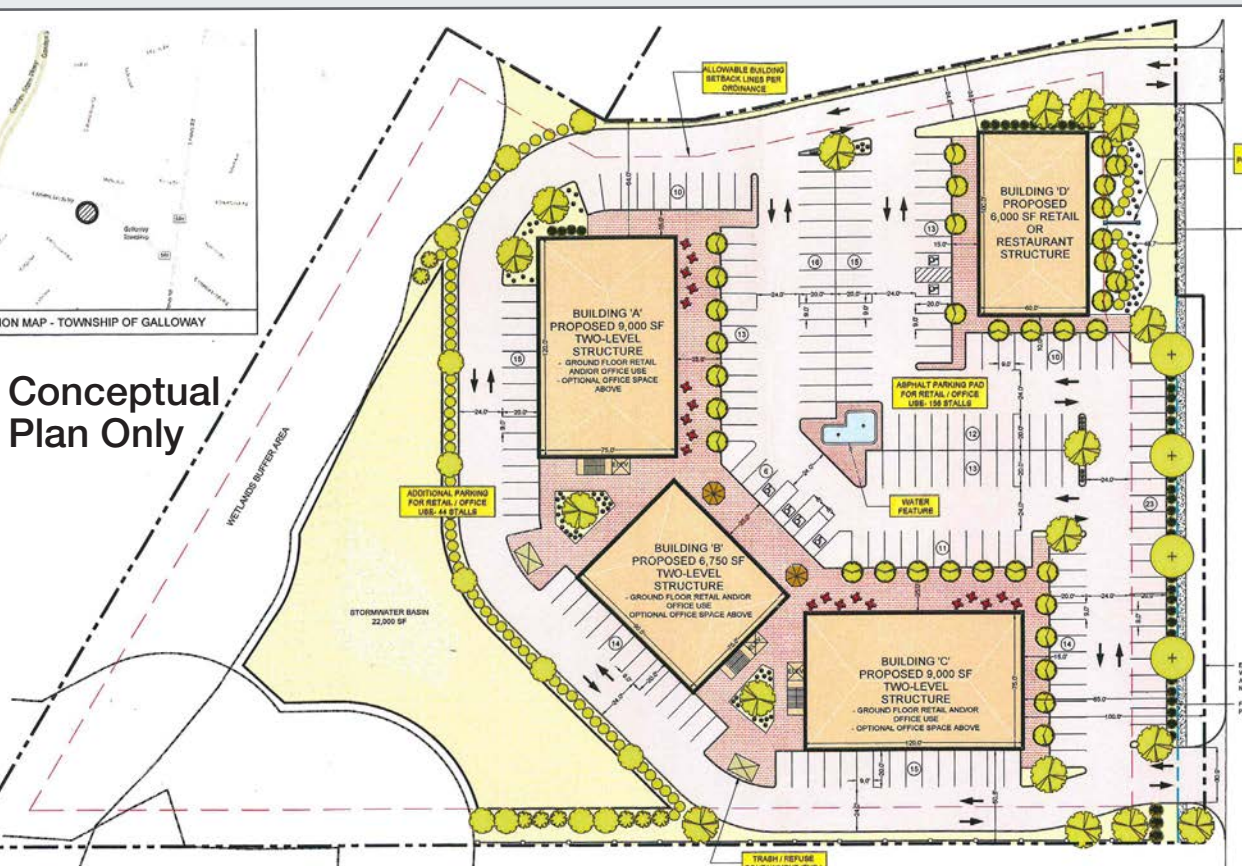

**Property Description**

- 5.25 ± acres available for sale with 450' ± frontage on Jimmie Leeds Road
- Block 980, Lots 13.03 & 14
- Zoned PRO - Professional Office District
- City Utilities, Water Sewer, Natural Gas
- Ideal site for developers of professional office buildings or retail strip centers

**Location Information**

- A no-toll interchange of the Garden State Parkway is under construction a short distance from this land parcel
- Minutes from AtlantiCare Regional Medical Center, Stockton State College, Stockton Seaview Hotel & Golf Club and Galloway National Golf Club
- 1 mile to Garden State Parkway; 5.5 miles to Atlantic City Expressway

SALE PRICE **\$575,000**

For more information:

<b>Roy Kardon, SIOR</b>	<b>John Brown</b>
+1 610 246 7118	+1 609 471 6133
roy.kardon@naimertz.com	john.brown@naimertz.com

NO WARRANTY OR REPRESENTATION, EXPRESS OR IMPLIED, IS MADE AS TO THE ACCURACY OF THE INFORMATION CONTAINED HEREIN, AND THE SAME IS SUBMITTED SUBJECT TO ERRORS, OMISSIONS, CHANGE OF PRICE, RENTAL OR OTHER CONDITIONS, PRIOR SALE, LEASE OR FINANCING, OR WITHDRAWAL WITHOUT NOTICE, AND OF ANY SPECIAL LISTING CONDITIONS IMPOSED BY OUR PRINCIPALS NO WARRANTIES OR REPRESENTATIONS ARE MADE AS TO THE CONDITION OF THE PROPERTY OR ANY HAZARDS CONTAINED THEREIN ARE ANY TO BE IMPLIED.

21 Roland Avenue  
Mount Laurel NJ 08054  
+1 856 234 9600  
[naimertz.com](http://naimertz.com)

Map & Demographics  
208 E. Jimmie Leeds Rd, Galloway, NJ

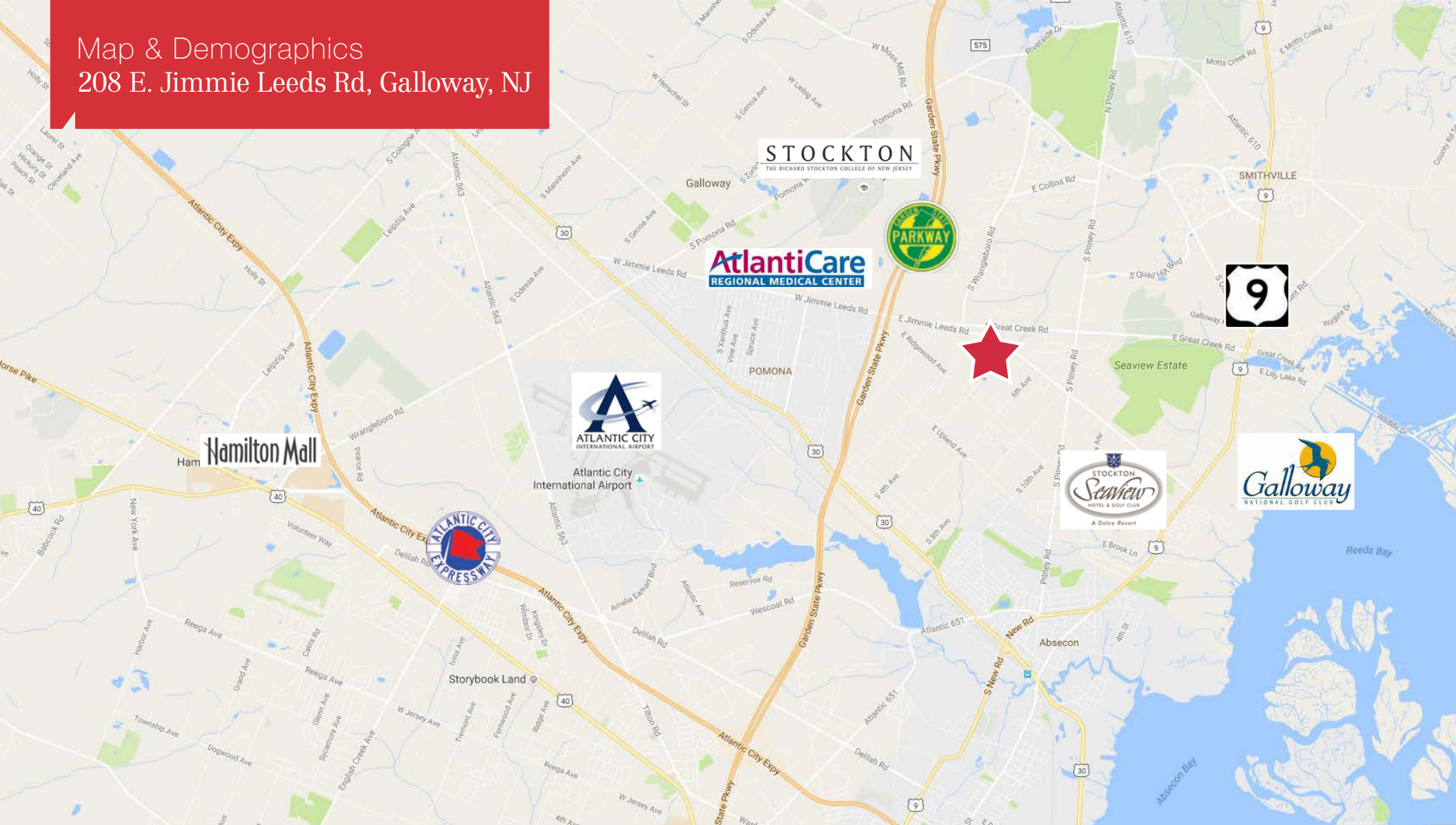

Demographic Information

1 Mile      3 Mile      5 Mile

Total Population	4,652	34,170	54,520
Median Household Income	\$61,674	\$63,672	\$58,248
Total Households	4,788	31,514	80,405

For more information:

**Roy Kardon, SIOR**  
+1 610 246 7118  
roy.kardon@naimertz.com

**John Brown**  
+1 609 471 6133  
john.brown@naimertz.com



21 Roland Avenue  
Mount Laurel NJ 08054  
+1 856 234 9600  
[naimertz.com](http://naimertz.com)