

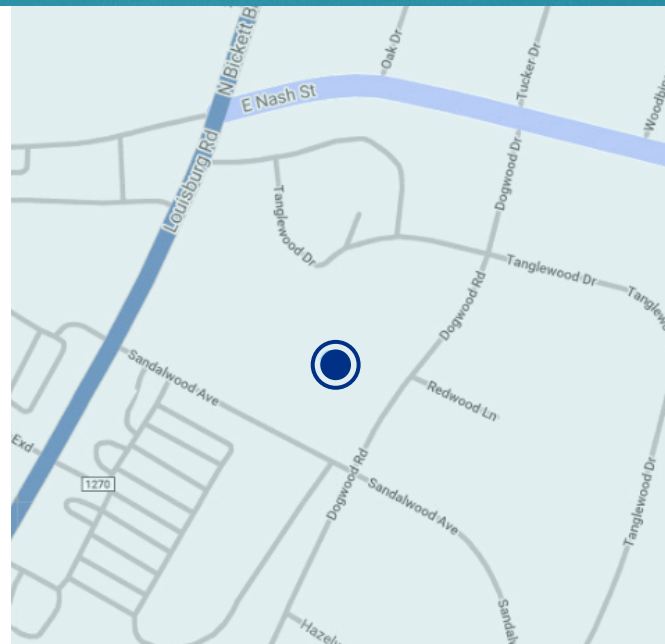

## OVERVIEW

- One-level, 13,549 SF brick building
- Situated on 1.6 acres
- Zoned for office or retail, up-fitted for medical use
- Located just off US-401 in Louisburg
- Neighborhood substantially developed with retail, office, and hotels
- Few medical facilities available in Franklin County



**FRED DICKENS** fdickens@trademarkproperties.com 919.227.5508 direct 919.673.4775 mobile

**CLAIBORNE LORD** clord@trademarkproperties.com 919.645.1426 direct 919.219.8635 mobile



## SPACE DETAILS

- Unit A
  - 8,000 SF
  - 16 exam rooms
  - \$17.00/SF, NNN
- Unit B
  - 2,860 SF
  - Nine exam rooms
  - \$17.00/SF, NNN
- Each space has reception area, waiting rooms, and break room
- Five-year term preferred for each space



### FRED DICKENS

fdickens@trademarkproperties.com  
919.227.5508 direct 919.673.4775 mobile

### CLAIBORNE LORD

clord@trademarkproperties.com  
919.645.1426 direct 919.219.8635 mobile

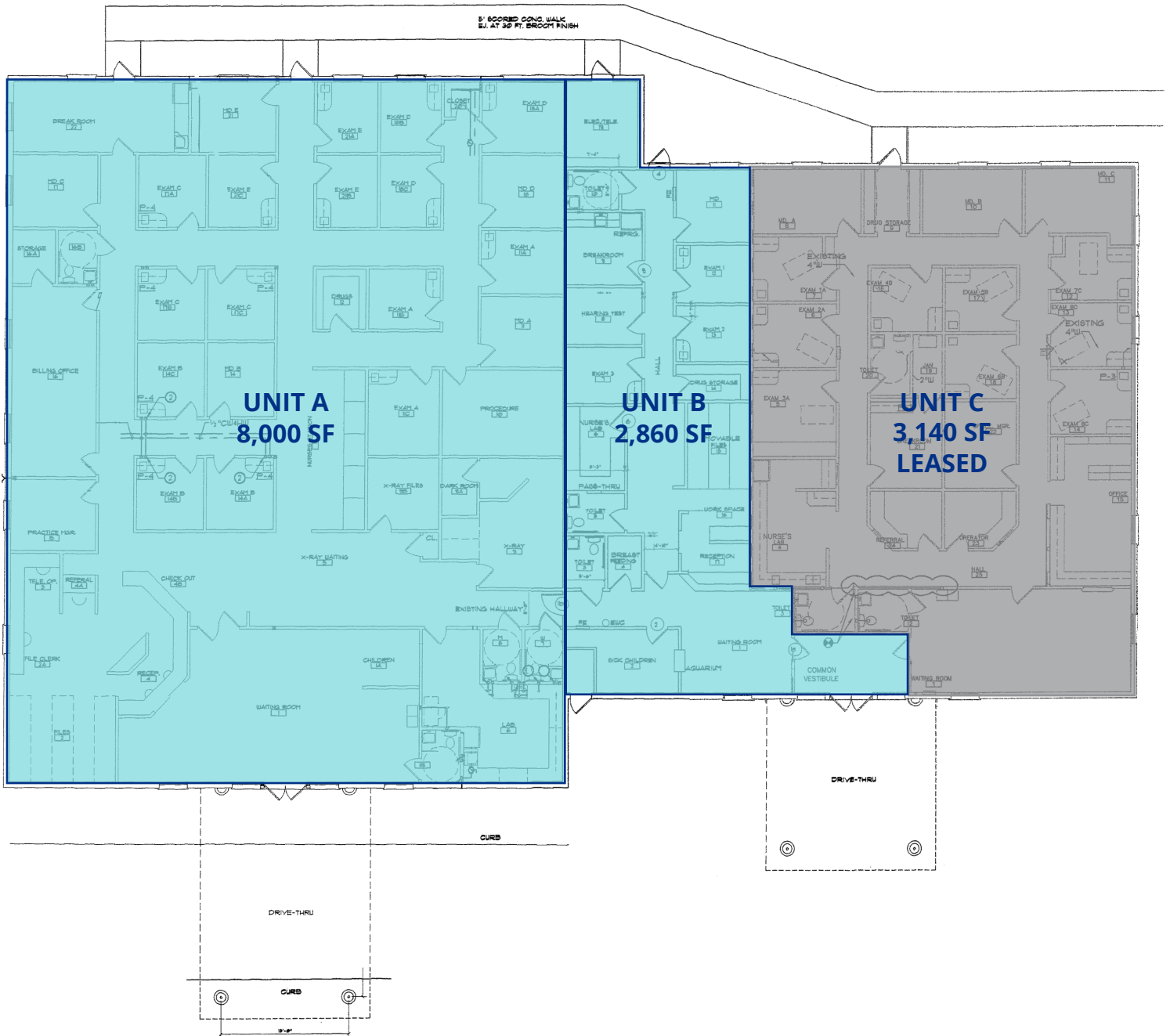

**FRED DICKENS**

fdickens@trademarkproperties.com

919.227.5508 direct 919.673.4775 mobile

**CLAIBORNE LORD**

clord@trademarkproperties.com

919.645.1426 direct 919.219.8635 mobile