

FOR SUBLEASE > PLUG AND PLAY OFFICE SPACE



Issaquah Highlands Professional Center

1011 NE HIGH STREET, ISSAQUAH, WA 98029



Building Features

- > Available for occupancy March 1, 2014
- > Suite 215: 9,052 SF (second floor)
- > Adjacent plug and play 2,722 SF available through Landlord
- > Master lease expires April 30, 2015, longer term available through Landlord
- > Free surface and covered parking at 3.3/1,000 SF
- > Fiber service in suite
- > \$24.00/SF, full service
- > Furniture included - plug and play opportunity



JEFF JEREMIAH
425 453 3123
Associate
jeff.jeremiah@colliers.com

BRET JORDAN
425 453 3131
Managing Director I Bellevue
bret.jordan@colliers.com

COLLIERS INTERNATIONAL
11225 SE 6th Street, Suite 240
Bellevue, WA 98004
www.colliers.com

FOR SUBLEASE > PLUG AND PLAY OFFICE SPACE



Issaquah Highlands Professional Center

1011 NE HIGH STREET, ISSAQUAH, WA 98029

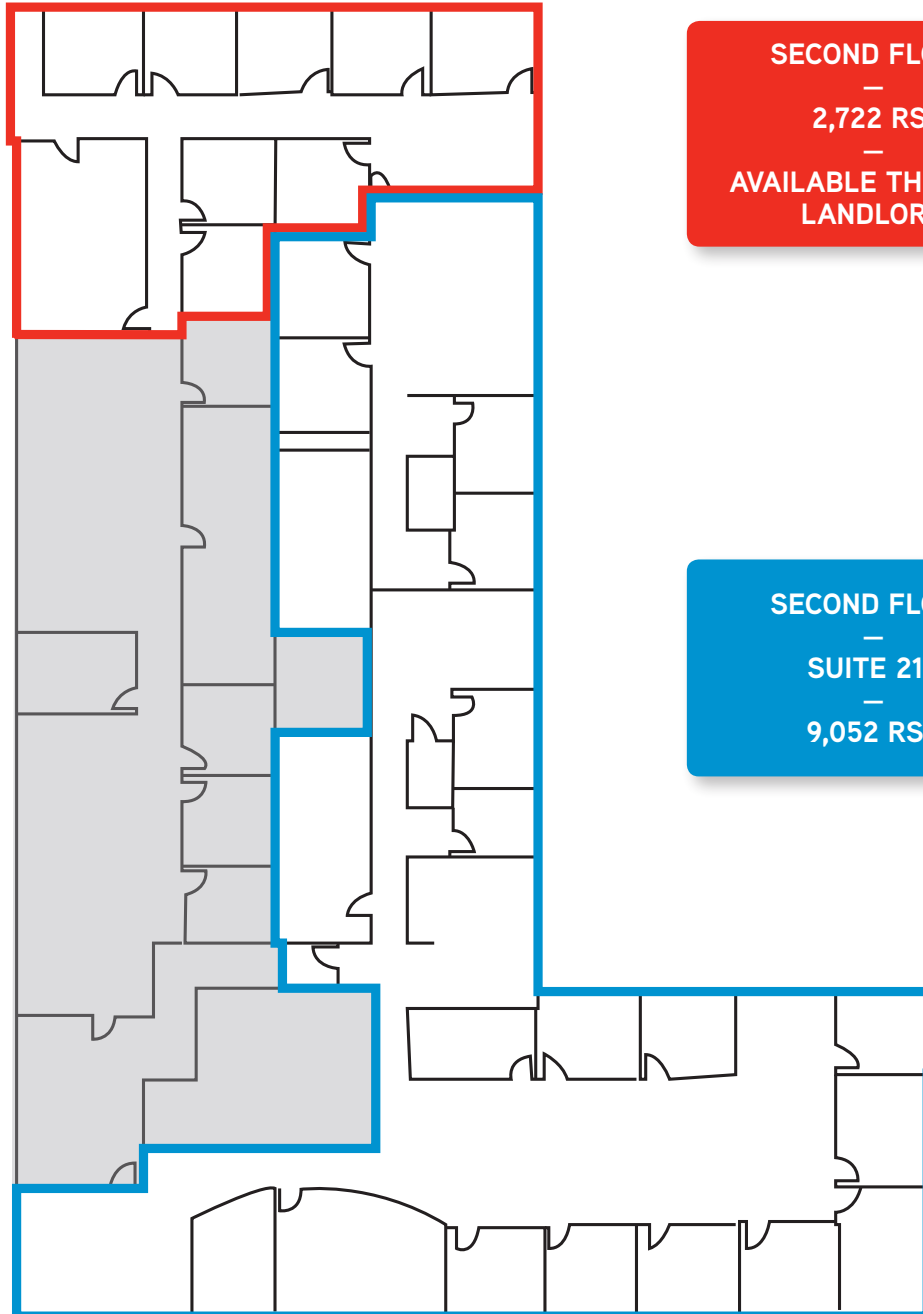

SECOND FLOOR
—
2,722 RSF
—
**AVAILABLE THROUGH
LANDLORD**

SECOND FLOOR
—
SUITE 215
—
9,052 RSF

This document has been prepared by Colliers International for advertising and general information only. Colliers International makes no guarantees, representations or warranties of any kind, expressed or implied, regarding the information including, but not limited to, warranties of content, accuracy and reliability. Any interested party should undertake their own inquiries as to the accuracy of the information. Colliers International excludes unequivocally all inferred or implied terms, conditions and warranties arising out of this document and excludes all liability for loss and damages arising there from. This publication is the copyrighted property of Colliers International and /or its licensor(s). © 2013. All rights reserved.

JEFF JEREMIAH
425 453 3123
Associate
jeff.jeremiah@colliers.com

BRET JORDAN
425 453 3131
Managing Director I Bellevue
bret.jordan@colliers.com

COLLIERS INTERNATIONAL
11225 SE 6th Street, Suite 240
Bellevue, WA 98004
www.colliers.com