



BETWEEN PRINCE & SPRING

100 WOOSTER

DETAILS:

Ground Level: **2,600 Square Feet** | Lower Level: **1,200 Square Feet**

Frontage: **15'** | Term: **Negotiable** | Possession: **Arranged**

Asking Rent: **Please Inquire**

LOCATED
AT THE CENTER OF
AN UNBELIEVABLE CO-TENANCY

Chanel | Tiffany & Co. | Redemption | Victorinox | Canada Goose |
One Kings Lane | Equipment | Ted Baker | Joie | Ray Ban | Woolrich |
Barbour | Diesel | Burberry | Leesa | Rossignol

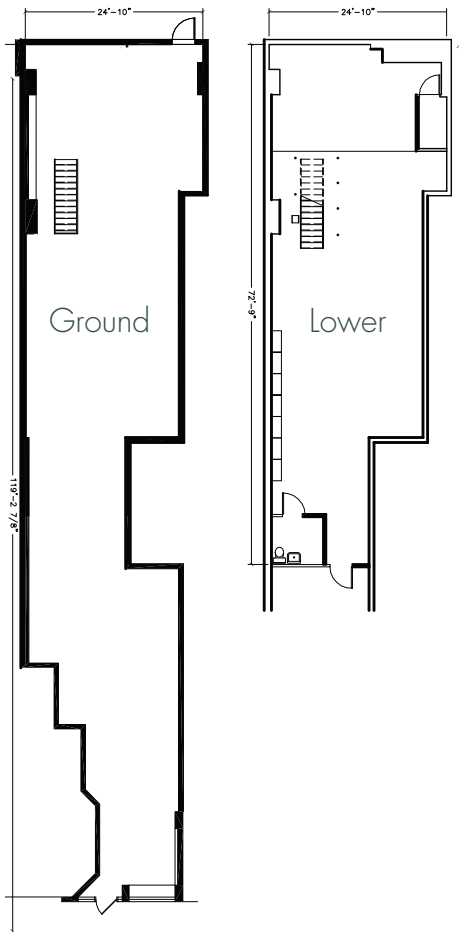

SPACE FEATURES:

- Steps from Soho's finest brands
- Adjacent to Chanel
- On the block with Canada Goose, Woolrich, & Barbour
- Exceptional build-out





PLEASE CONTACT:

Michael Glanzberg

212.604.9004
 michael@sinvin.com

Christopher Owles

212.604.9002
 chris@sinvin.com

Elliott Mishan

646.673.8786
 elliot@sinvin.com

