

Oviedo Point

1000 W Mitchell Hammock Road

Oviedo, FL 32765



MEDICAL OFFICE OPPORTUNITY

Equinox Development has retained Lee & Associates - Central Florida, LLC as its exclusive agent in the sale of the medical office opportunities at Oviedo Point, 1000 W. Mitchell Hammock Rd, located at the southeast corner of Aloma Ave. (SR 426) and Mitchell Hammock Road in Oviedo, FL.

Oviedo Point, at completion, will feature nine (9) single story, free standing retail & medical office buildings covering 23 acres in a park setting. Individual medical buildings can be provided

starting at 5,000 SF and as large as 30,000 SF contiguous.

Located between the new Oviedo Hospital and Oviedo on the Park, this is a unique opportunity for medical ownership in a section of Oviedo experiencing a large wave of commercial development. Each site offers 5/1000 parking, high visibility with monument signage and ease of access with a median cut off of Mitchell Hammock Rd. Each site will be delivered at grade with utilities stubbed and ready for construction. Please call for additional details.



COMMERCIAL REAL ESTATE SERVICES
LOCAL EXPERTISE. NATIONAL REACH. WORLD CLASS.

4700 Millenia Blvd
Suite 200
Orlando, FL 32839
321.281.8500 phone
321.281.8519 fax
www.lee-associates.com

Jason Bantel, CCIM

321.281.8509

jbantel@lee-associates.com

Another Development By:
EQUINOX
Development Properties, Inc.

All information furnished regarding property for sale, rental or financing is from sources deemed reliable, but no warranty or representation is made to the accuracy thereof and the same is submitted to errors, omissions, change of price, rental or other conditions prior to sale, lease or financing or withdrawal without notice. No liability of any kind is to be imposed on the broker herein.

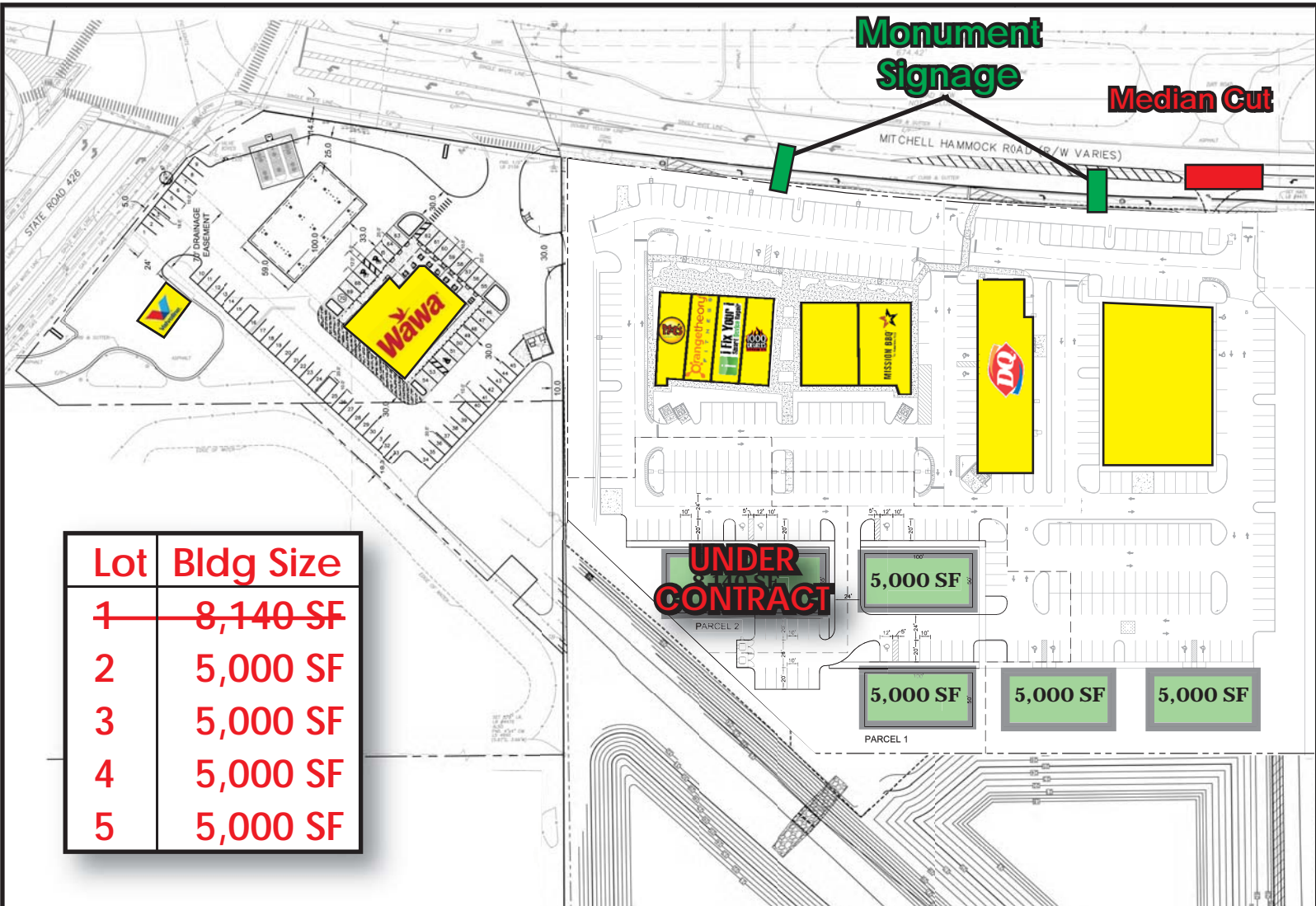

Lot	Bldg Size
1	8,140 SF
2	5,000 SF
3	5,000 SF
4	5,000 SF
5	5,000 SF

UNDER CONTRACT

5,000 SF

5,000 SF

5,000 SF

5,000 SF

5,000 SF

Demographics

	3 Miles	5 Miles	7 Miles
Total Population	60,756	150,423	287,901
Average HH Income	\$93,000	\$85,555	\$70,409
Total Businesses	2,272	4,360	9,442
Daytime Population	19,332	52,593	102,354
Median Age	37	33	33

Monument Signage

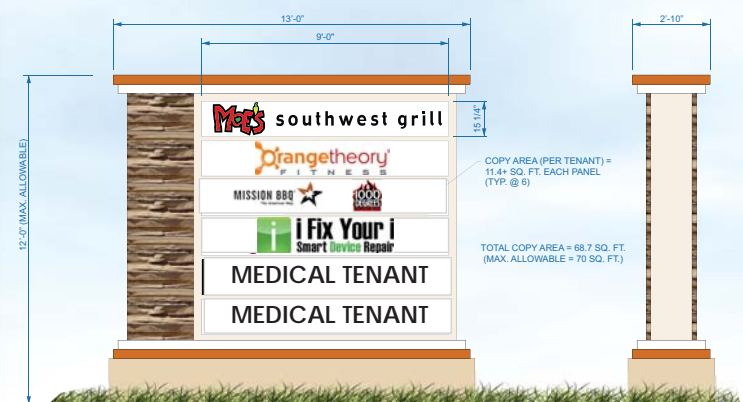

Signage Shown is Representative