

# 4,250 SF Industrial Unit

Central Clark County

## FOR LEASE

## Minnehaha Corporate Center

4214 NE Minnehaha St. Bldg. 6, Ste 100 Vancouver, WA 98661

**Available March 2018**

- 4,250 SF Warehouse/ Office
- Clear Height: 16' - 20'
- Heavy Power: 480V 3-Phase
- Grade Door: 12'w x 14'h
- Sprinklers: Wet System
- Zoning: Light Industrial- IL
- Located in a Growing Industrial Area



**Lease: \$2,679 Mo.**

**3 Year Minimum - NNN \$0.10 SF Mo.**

Located in  
Central Clark County  
I-5 2.25 miles, I-205 2.25 miles  
SR500 1.75 miles,  
PDX 10 Minutes



**Kelly D. Shea**

Direct: 360-823-5110

Cell: 360-921-3710

Kelly@CBCIndustrialProperties.com

**CBC  
Industrial Properties**

**Industrial Property Specialist**

*2016 Top Producer*

Sales & Leasing  
Development

Investment Properties



**JENKINS & ASSOCIATES**

300 W 15th St., Ste 201 - Vancouver, WA 98660



© 2008 Coldwell Banker Real Estate LLC. Coldwell Banker Commercial® is a registered trademark licensed to Coldwell Banker Real Estate LCC. An Equal Opportunity Company. Each Office Is Independently Owned And Operated

Coldwell Banker Commercial and the Coldwell Banker Commercial Logo are registered service marks licensed to Coldwell Banker Real Estate LLC. Each Office is Independently Owned and Operated. We deem the information provided reliable, but it is not guaranteed. All potential investors and tenants must take appropriate measures to verify all of the information set forth herein before entering into a Purchase or Lease.

# Bldg. Foot Print

## Minnehaha Corp Ctr Bldg 6, Ste 100

- 4,250 SF Warehouse  
Incl. Office 455 SF  
w/ Restroom
- 1 OH Door
- Glass Entrance
- Heavy Power
- Built 2013/ 2014
  
- Available 3/2018

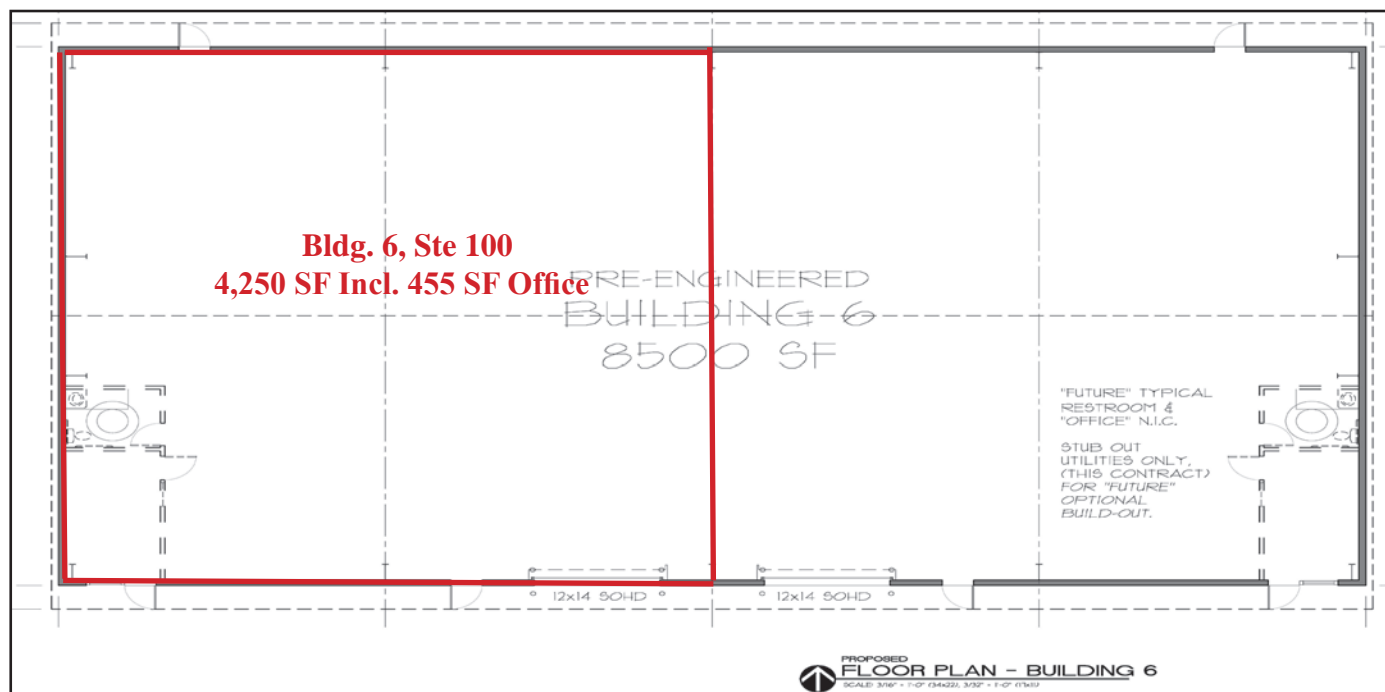
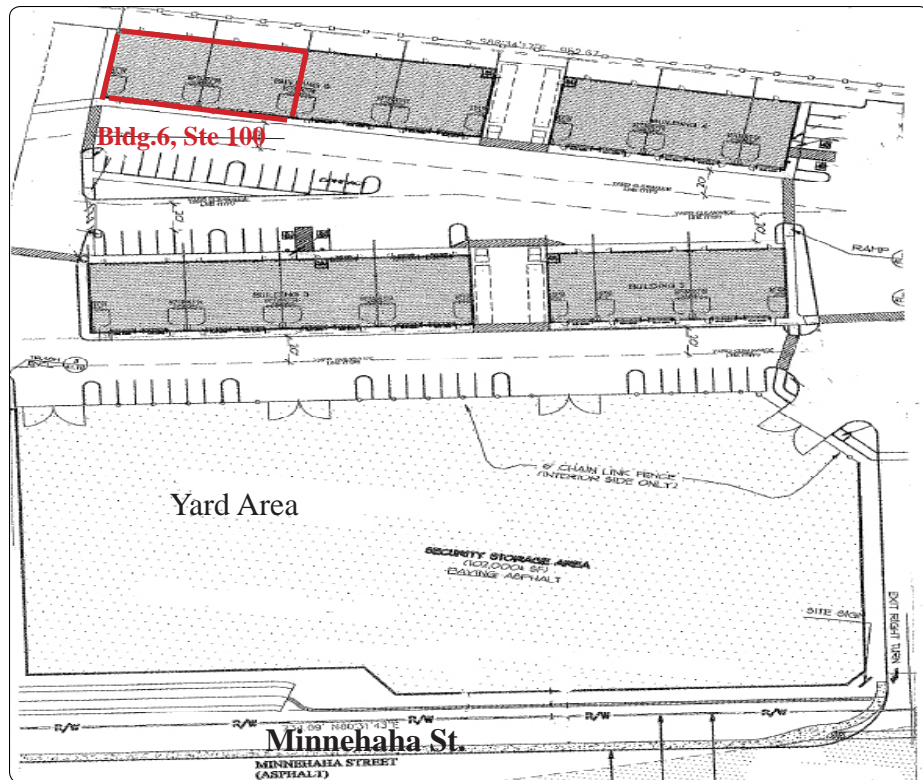

4214 NE Minnehaha St. Bldg 6 Ste 100, Vancouver, WA 98661