

Doctors Park at Eastlake

963-967 Lane Avenue, Chula Vista, CA 91914

FOR SALE/LEASE

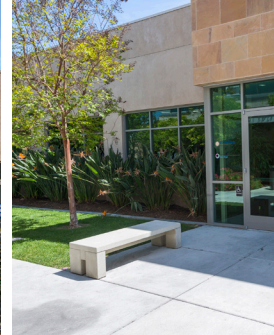

Paul Braun
+ 1 858 410 6388
Paul.Braun@am.jll.com
License no. 00891709

Kelly Moriarty
+ 1 858 410 6359
Kelly.Moriarty@am.jll.com
License no. 01963162

Doctors Park at Eastlake

963-967 Lane Avenue, Chula Vista, CA 91914



Doctors Park at Eastlake

955 Lane Ave.
Leased: LSC Orthopedics
2-story 21,500 s.f.

959 Lane Ave.
Leased: UCSD Radiation Oncology
1-story 10,000 s.f.

971 Lane Ave.
Leased: Scripps Coastal Medical Center
2-story 21,500 s.f.

963 Lane Ave.
For Lease/Sale: 1-story 9,500 s.f.

967 Lane Ave.
For Lease/Sale: 1-story 10,500 s.f.



Paul Braun

+ 1 858 410 6388

Paul.Braun@am.jll.com

License no. 00891709

Kelly Moriarty

+ 1 858 410 6359

Kelly.Moriarty@am.jll.com

License no. 01963162

FOR SALE/LEASE

Join other well recognized healthcare providers like Scripps Health and UC San Diego Health System in South County's newest and most dynamic medical campus.

- New 5-building class "A" medical office fronting Otay Lakes Road in the community of Eastlake
- 1,500 - 20,000 SF Available
- Abundant parking: 5/1,000
- Lease Rate: \$2.75 - \$3.00/SF NNN
- Sale Price & Terms: Negotiable

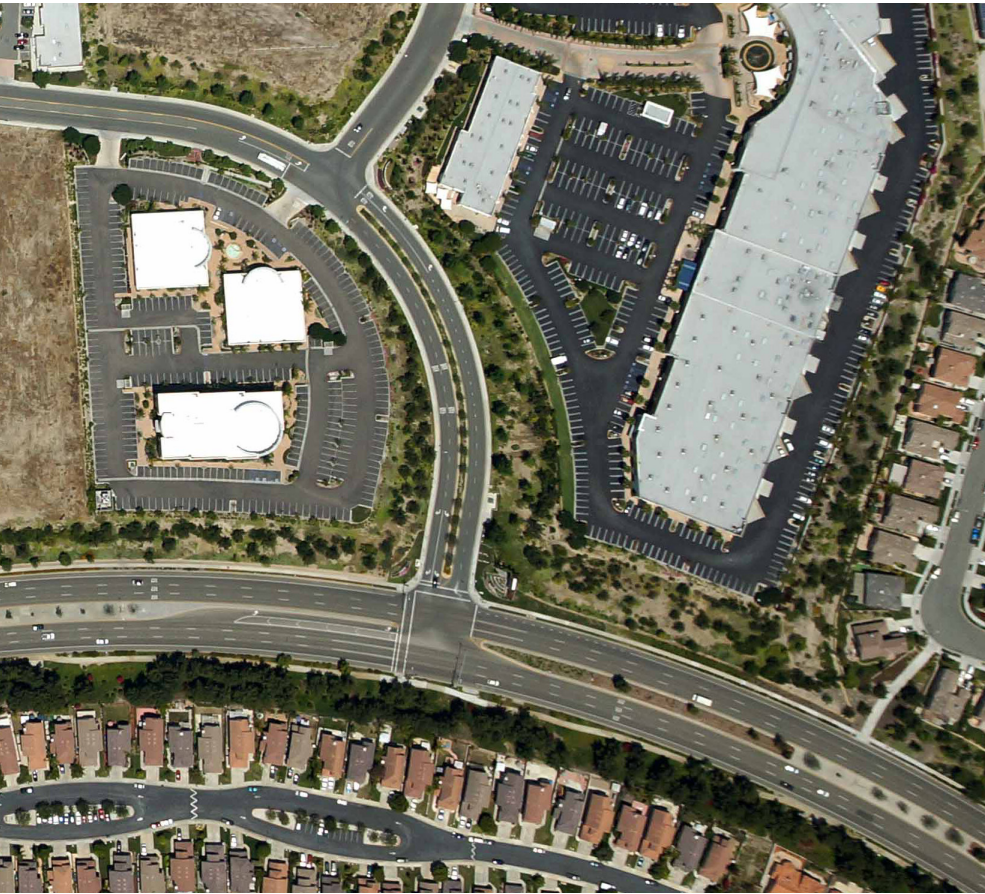

Doctors Park at Eastlake

963-967 Lane Avenue, Chula Vista, CA 91914



Within a 3-mile radius of Doctors Park, Eastlake has experienced an 8.95% increase in population with an average household income of \$103,459.00



Paul Braun
+ 1 858 410 6388
Paul.Braun@am.jll.com
License no. 00891709

Kelly Moriarty
+ 1 858 410 6359
Kelly.Moriarty@am.jll.com
License no. 01963162

FOR SALE / LEASE



Centrally located in Eastlake's booming retail and commercial district

Easy access; two blocks from the SR-125 toll road

Doctors Park at Eastlake
US Olympic Training Center

Doctors Park at Eastlake

963-967 Lane Avenue, Chula Vista, CA 91914

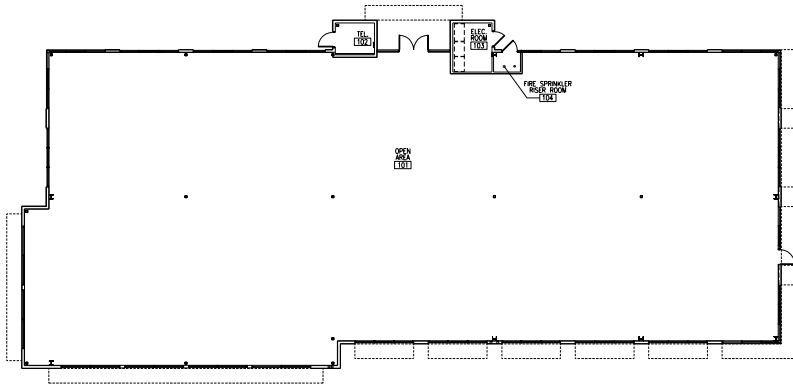

963 Lane Avenue, Chula Vista, CA 91914

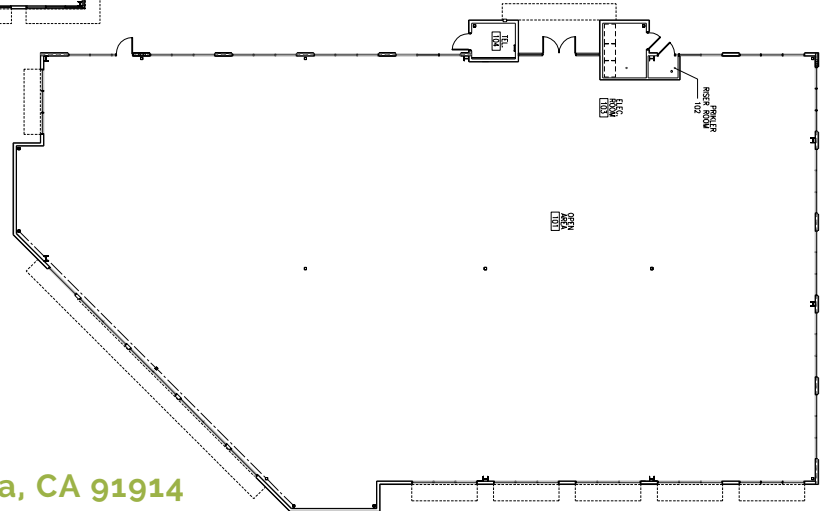

967 Lane Avenue, Chula Vista, CA 91914



Paul Braun
+ 1 858 410 6388
Paul.Braun@am.jll.com
License no. 00891709

Kelly Moriarty
+ 1 858 410 6359
Kelly.Moriarty@am.jll.com
License no. 01963162

FOR SALE / LEASE



