

402 North Lake Street - (SR 528)

# 13,500± SF Industrial For Lease

Madison Village, OH 44057 (Lake County)



402 North Lake Street, Madison Village, OH

## Property Features:

- Building Size: 39,018± SF
  - Space Available: 13,500± SF
    - Office: 1,265± SF
    - Warehouse: 12,235± SF
  - 3-Phase Power 480/240
  - Fluorescent Lighting
  - Reznor Heating Units
  - 2 Step Docks (10' x 10')
  - 1 Indoor Dock (14' x 14')
  - 30' x 30' Column Spacing
  - 16' Clear Ceiling Height in Warehouse
  - Alarm System
  - Mezzanine Area Above Office
  - Easy Access to Interstate 90
  - Ample Parking
  - Property Also Available as an Investment
- Lease Rate: \$4,500.00 Monthly NNN**

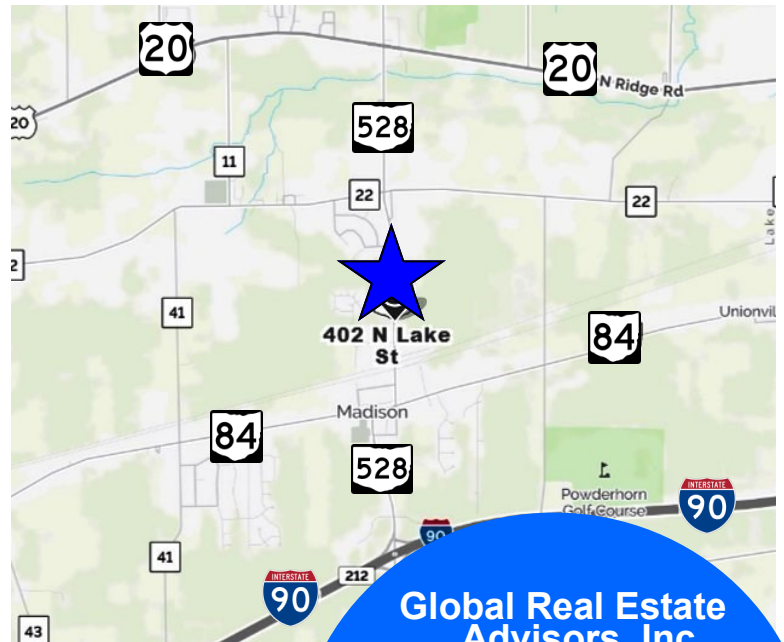

**Global Real Estate  
Advisors, Inc.**

**Neil Sawicki, SIOR, Broker**

**440-255-5552 x 221**

**440-339-8585 Cell**

**Neil@GlobalCommercialRE.com**



# GLOBAL

[www.GlobalCommercialRE.com](http://www.GlobalCommercialRE.com)

8585 East Ave., Mentor, Ohio 44060

**Real Estate Advisors Inc.**  
BROKER

This information has been secured from sources we believe are reliable, but we make no representations or warranties, expressed or implied, as to the accuracy of the information. References to condition, square footage or age are approximate. Buyer or Tenant acknowledges that they are relying on their own investigations and are not relying on Broker provided information. Procuring broker shall only be entitled to a commission, calculated in accordance with the rates approved by our principal only if such procuring broker executes a brokerage agreement acceptable to us and our principal and the conditions as set forth in the brokerage agreement are fully and unconditionally satisfied. Although all information furnished regarding property for sale, rental, or financing is from sources deemed reliable, such information has not been verified and no express representation is made nor is any to be implied as to the accuracy thereof and it is submitted subject to errors, omissions, change of price, rental or other conditions, prior sale, lease or financing, or withdrawal without notice and to any special conditions imposed by our principal.

402 North Lake Street - (SR 528)

# 13,500± SF Industrial For Lease

Madison Village, OH 44057 (Lake County)



# GLOBAL

[www.GlobalCommercialRE.com](http://www.GlobalCommercialRE.com)  
8585 East Ave., Mentor, Ohio 44060

**Real Estate Advisors Inc.**  
BROKER

Global Real Estate  
Advisors, Inc.

Neil Sawicki, SIOR, Broker

440-255-5552 x 221

440-339-8585 Cell

[Neil@GlobalCommercialRE.com](mailto:Neil@GlobalCommercialRE.com)

This information has been secured from sources we believe are reliable, but we make no representations or warranties, expressed or implied, as to the accuracy of the information. References to condition, square footage or age are approximate. Buyer or Tenant acknowledges that they are relying on their own investigations and are not relying on Broker provided information. Procuring broker shall only be entitled to a commission, calculated in accordance with the rates approved by our principal only if such procuring broker executes a brokerage agreement acceptable to us and our principal and the conditions as set forth in the brokerage agreement are fully and unconditionally satisfied. Although all information furnished regarding property for sale, rental, or financing is from sources deemed reliable, such information has not been verified and no express representation is made nor is any to be implied as to the accuracy thereof and it is submitted subject to errors, omissions, change of price, rental or other conditions, prior sale, lease or financing, or withdrawal without notice and to any special conditions imposed by our principal.

402 North Lake Street - (SR 528)

# 13,500± SF Industrial For Lease

Madison Village, OH 44057 (Lake County)

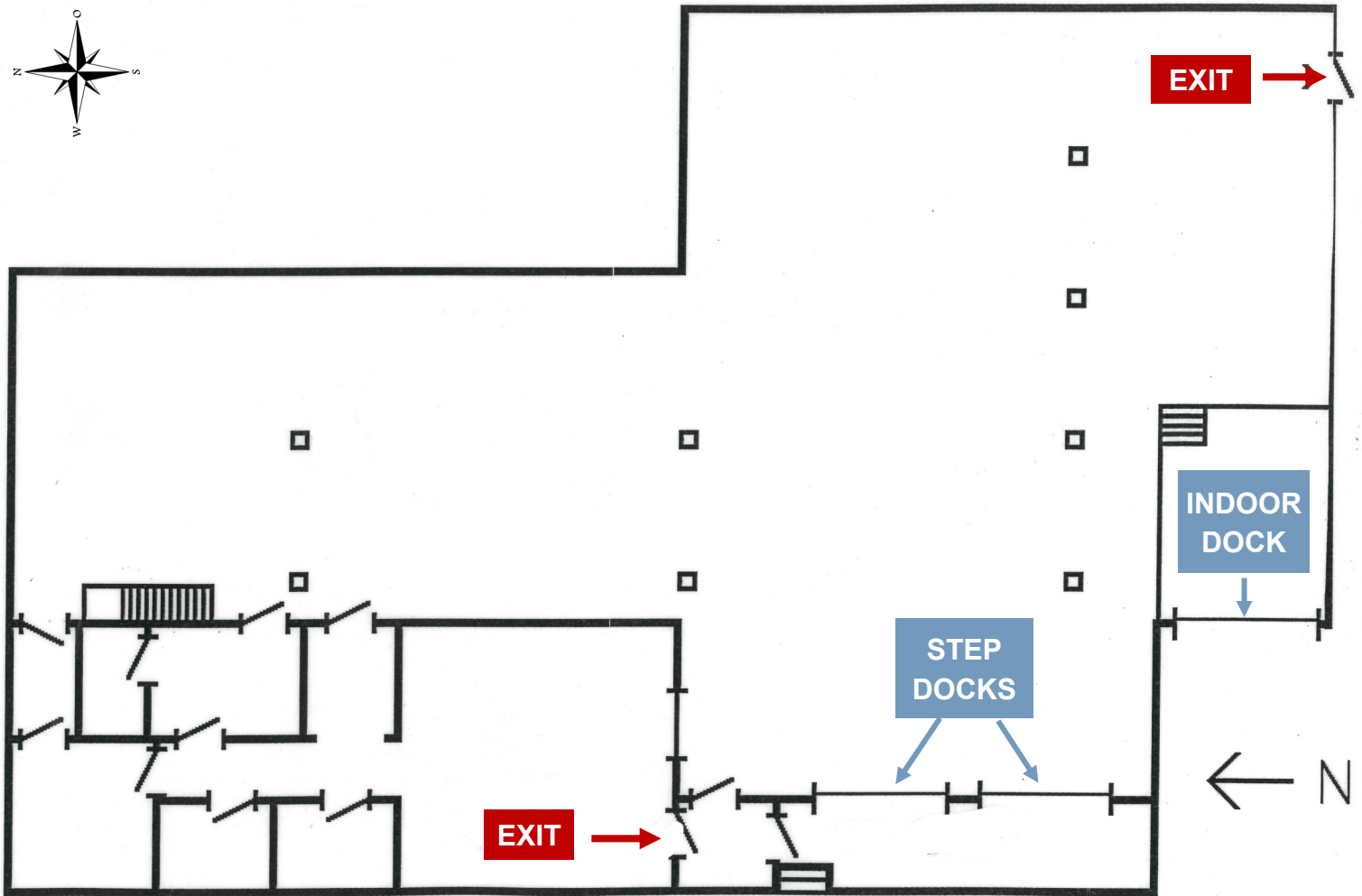
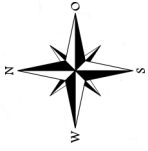

[www.GlobalCommercialRE.com](http://www.GlobalCommercialRE.com)

8585 East Ave., Mentor, Ohio 44060

**Real Estate Advisors Inc.**  
BROKER

Global Real Estate  
Advisors, Inc.

Neil Sawicki, SIOR, Broker

440-255-5552 x 221

440-339-8585 Cell

[Neil@GlobalCommercialRE.com](mailto:Neil@GlobalCommercialRE.com)

This information has been secured from sources we believe are reliable, but we make no representations or warranties, expressed or implied, as to the accuracy of the information. References to condition, square footage or age are approximate. Buyer or Tenant acknowledges that they are relying on their own investigations and are not relying on Broker provided information. Procuring broker shall only be entitled to a commission, calculated in accordance with the rates approved by our principal only if such procuring broker executes a brokerage agreement acceptable to us and our principal and the conditions as set forth in the brokerage agreement are fully and unconditionally satisfied. Although all information furnished regarding property for sale, rental, or financing is from sources deemed reliable, such information has not been verified and no express representation is made nor is any to be implied as to the accuracy thereof and it is submitted subject to errors, omissions, change of price, rental or other conditions, prior sale, lease or financing, or withdrawal without notice and to any special conditions imposed by our principal.