

Retail For Lease

**1,000 SF - 3,000 SF**  
Downtown Wheat Ridge  
Retail District Ridge at 38



# Shops at West 38th

7400 W. 38th Avenue | Wheat Ridge, Colorado 80033

## Property Overview

- 3,000 SF of retail space available for lease in the emerging commercial district of Ridge at 38
- High traffic and visible corner on West 38th Avenue off of Wadsworth Boulevard
- Great parking, access and way findings into the retail center
- Strong new residential density from existing and new development projects nearing completion
- Monument signage with store front signage available
- Easy access to major commuter routes I-70 and I-76

**Lease Rate: \$16.00/SF NNN**

## Property Facts

Available SF:	3,000 SF
Building SF:	9,600 SF
Parking Ratio:	2.50/1,000
2019 Expenses:	\$6.87/SF (Est.)

For more information:

**Paul Cattin, MICP**

303 565 3030  
pcattin@shamesmakovsky.com

**Todd Silverman, CCIM**

303 565 3031  
tsilverman@shamesmakovsky.com

NO WARRANTY OR REPRESENTATION, EXPRESS OR IMPLIED, IS MADE AS TO THE ACCURACY OF THE INFORMATION CONTAINED HEREIN, AND THE SAME IS SUBMITTED SUBJECT TO ERRORS, OMISSIONS, CHANGE OF PRICE, RENTAL OR OTHER CONDITIONS, PRIOR SALE, LEASE OR FINANCING, OR WITHDRAWAL WITHOUT NOTICE, AND OF ANY SPECIAL LISTING CONDITIONS IMPOSED BY OUR PRINCIPALS NO WARRANTIES OR REPRESENTATIONS ARE MADE AS TO THE CONDITION OF THE PROPERTY OR ANY HAZARDS CONTAINED THEREIN ARE ANY TO BE IMPLIED.

1400 Glenarm Place, Suite 100  
Denver, CO 80202  
303 534 5005

[naishamesmakovsky.com](http://naishamesmakovsky.com)

Retail For Lease  
**1,000 SF - 3,000 SF**  
 7400 W. 38th Avenue  
 Wheat Ridge, Colorado



**Floor Plan**

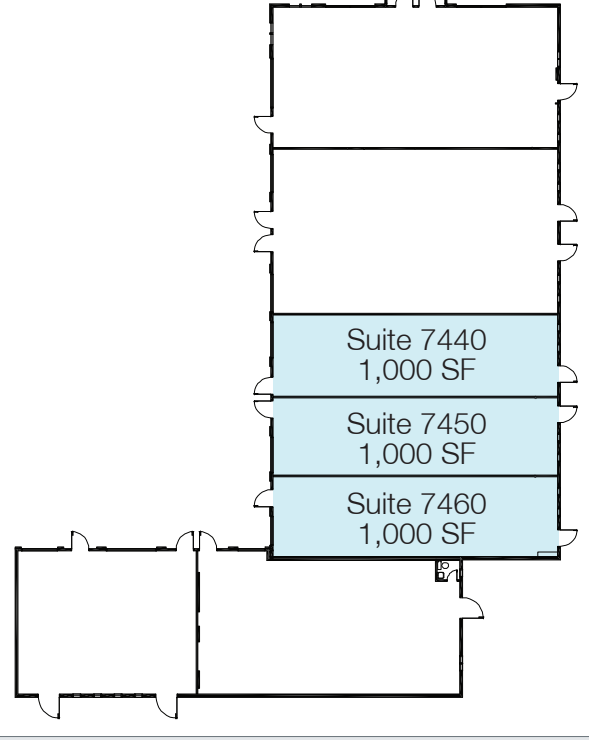

**Demographics**

	1 Mile	3 Mile	5 Mile
Population	12,213	132,884	357,880
Households	5,736	59,018	148,969
Avg Household Income	\$67,432	\$70,558	\$73,963

\*Source: SitesUSA

For more information:

**Paul Cattin, MICP**  
 303 565 3030  
 pcattin@shamesmakovsky.com

**Todd Silverman, CCIM**  
 303 565 3031  
 tsilverman@shamesmakovsky.com



1400 Glenarm Place, Suite 100  
 Denver, CO 80202  
 303 534 5005  
 naishamesmakovsky.com