

FOR LEASE > 46,299 SF FREESTANDING INDUSTRIAL BUILDING
PACIFIC RIM BUSINESS CENTER
2220 NIELS BOHR COURT, SAN DIEGO, CA 92154



LEASE RATE: \$0.48/SF NNN, PER MONTH

PROPERTY FEATURES

- > 46,299 SF Corporate Distribution/Manufacturing Facility
- > ESFR Sprinkler System
- > 26'-28' Clear Height
- > 2,900 SF Office
- > 9 Dock-High Doors
- > Secure Private Yard
- > 1 Oversized Grade Ramp Door
- > Freestanding/No Shared Truck Court
- > Direct Access to SR-905
- > Walking Distance to Numerous Amenities & Bordering Crossing
- > 2.2/1,000 SF Parking Ratio
- > \$0.48 SF, NNN Per Month



FOR MORE
INFORMATION
PLEASE
CONTACT

CHRIS HOLDER
858.677.5372
chris.holder@colliers.com
Lic. No. 00894854

MARK LEWKOWITZ
858.677.5361
mark.lewkowitz@colliers.com
Lic. No. 01785338

FOR LEASE > 46,299 SF FREESTANDING INDUSTRIAL BUILDING
PACIFIC RIM BUSINESS CENTER
2220 NIELS BOHR COURT, SAN DIEGO, CA 92154

SITE PLAN

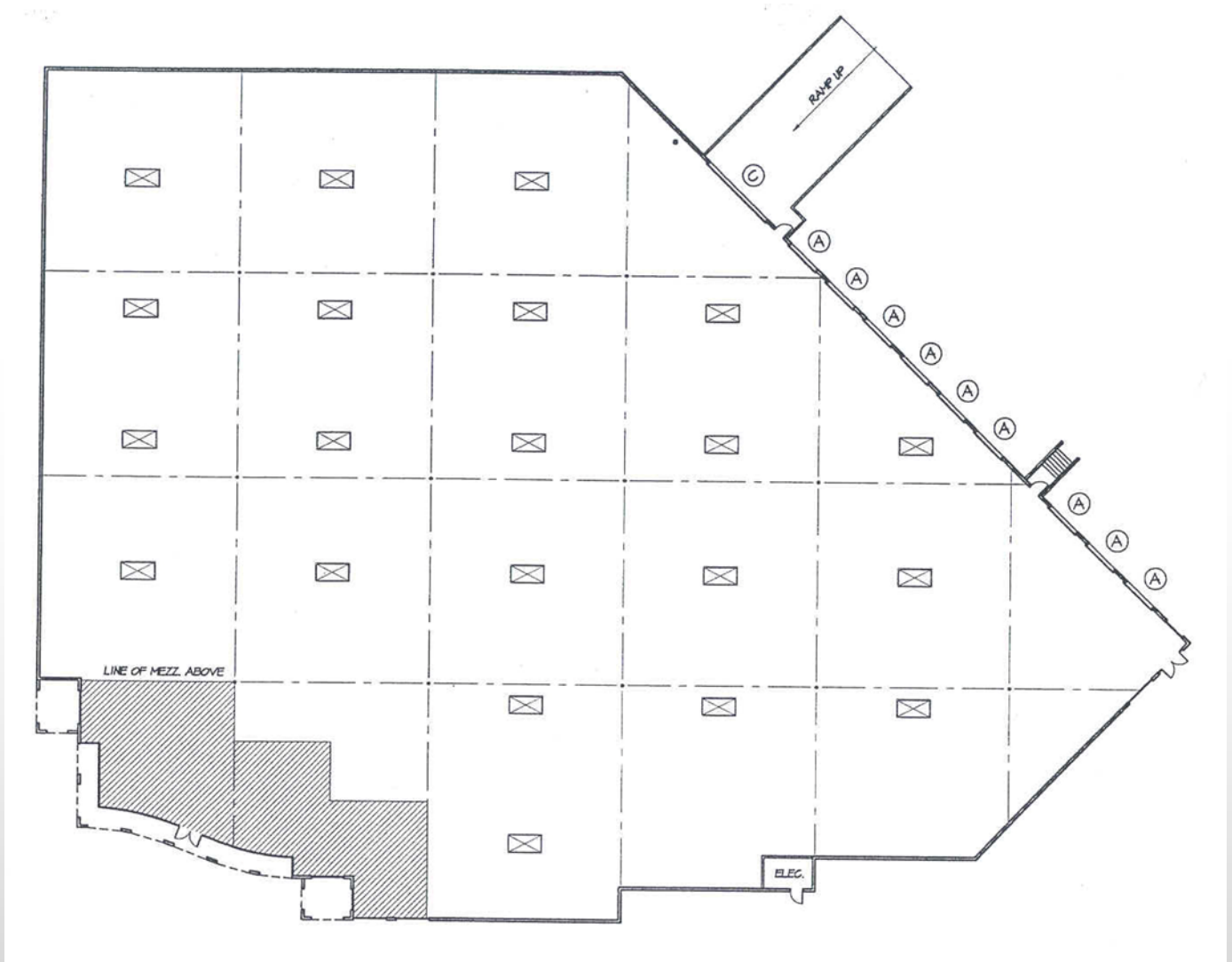

FOR MORE
INFORMATION
PLEASE
CONTACT

CHRIS HOLDER
858.677.5372
chris.holder@colliers.com
Lic. No. 00894854

MARK LEWKOWITZ
858.677.5361
mark.lewkowitz@colliers.com
Lic. No. 01785338

FOR LEASE > 46,299 SF FREESTANDING INDUSTRIAL BUILDING

PACIFIC RIM BUSINESS CENTER

2220 NIELS BOHR COURT, SAN DIEGO, CA 92154

REAR VIEW OF FACILITY



FOR MORE INFORMATION
PLEASE CONTACT

CHRIS HOLDER
858.677.5372

chris.holder@colliers.com
Lic. No. 00894854

MARK LEWKOWITZ
858 677 5361

mark.lewkowitz@colliers.com
Lic. No. 01785338

COLLIERS INTERNATIONAL

4660 La Jolla Village Drive, Suite 100
San Diego, CA 92122
P: 858 455 1515 | F: 858 546 9146
www.colliers.com/sandiego

Colliers
INTERNATIONAL

This document has been prepared by Colliers International for advertising and general information only. Colliers International makes no guarantees, representations or warranties of any kind, expressed or implied, regarding the information including, but not limited to, warranties of content, accuracy and reliability. Any interested party should undertake their own inquiries as to the accuracy of the information. Colliers International excludes unequivocally all inferred or implied terms, conditions and warranties arising out of this document and excludes all liability for loss and damages arising there from. Colliers International is a worldwide affiliation of independently owned and operated companies.

FOR LEASE > 46,299 SF FREESTANDING INDUSTRIAL BUILDING

PACIFIC RIM BUSINESS CENTER

2220 NIELS BOHR COURT, SAN DIEGO, CA 92154



FOR MORE
INFORMATION
PLEASE
CONTACT

CHRIS HOLDER
858.677.5372
chris.holder@colliers.com
Lic. No. 00894854

MARK LEWKOWITZ
858 677 5361
mark.lewkowitz@colliers.com
Lic. No. 01785338

COLLIERS INTERNATIONAL
4660 La Jolla Village Drive, Suite 100
San Diego, CA 92122
P: 858 455 1515 | F: 858 546 9146
www.colliers.com/sandiego



This document has been prepared by Colliers International for advertising and general information only. Colliers International makes no guarantees, representations or warranties of any kind, expressed or implied, regarding the information including, but not limited to, warranties of content, accuracy and reliability. Any interested party should undertake their own inquiries as to the accuracy of this information. Colliers International excludes unequivocally all inferred or implied terms, conditions and warranties arising out of this document and excludes all liability for loss and damages arising there from. Colliers International is a worldwide affiliation of independently owned and operated companies.