

# Chicago Gateway Business

## ±4,187 SF OFFICE CONDO FOR SUBLEASE

1845 Chicago Avenue, Unit D | Riverside, CA 92501



- Professional mixed-use business campus with high-quality finishes and lush landscaping
- Strategically located in Hunter Park with great access to the CA-60, CA-91 and I-215 freeways
- Excellent visibility along Chicago Avenue
- Walking distance to numerous restaurants
- Abundant parking on-site
- 4:1,000 parking ratio
- Furniture can be available with Sublease
- Master Lease Expires March 31, 2020

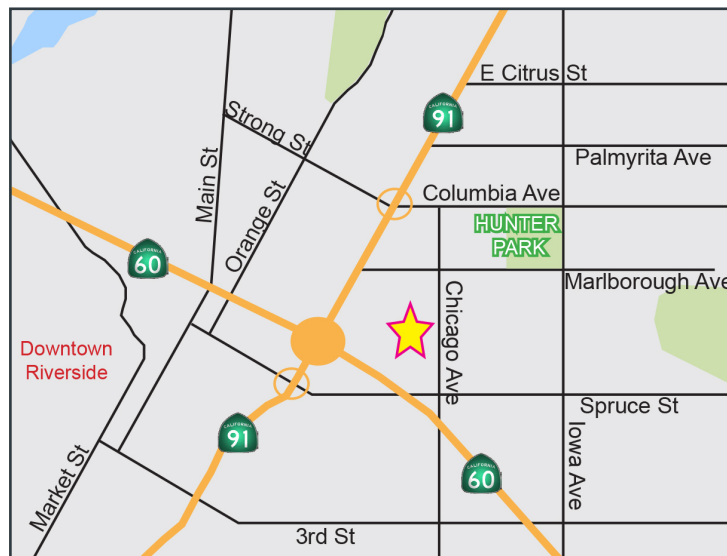

### THOMAS P. PIERIK, SIOR

Senior Vice President

(951) 276-3610

tpierik@lee-associates.com

CALBRE# 00982027

# Chicago Gateway Business

## ±4,187 SF OFFICE CONDO FOR SUBLEASE

1845 Chicago Avenue, Unit D | Riverside, CA 92501

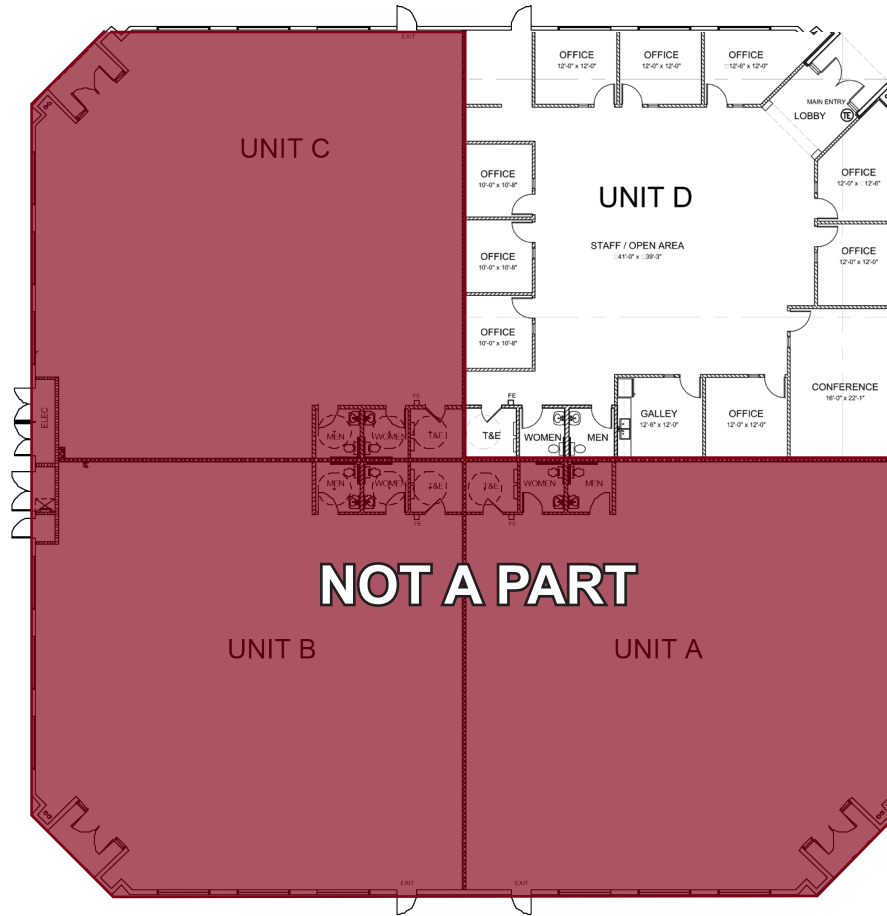

**THOMAS P. PIERIK, SIOR**

Senior Vice President  
(951) 276-3610

tpierik@lee-associates.com  
CALBRE# 00982027