

 COLEMAN HIGHLINE



501 EARTHQUAKES WAY, SAN JOSE

Restaurant/Retail Pad
1,157± SF Suite

Ryan Warner
Lic. #01397580
rwarner@moinc.net
408.477.2505

Matt Perez
Lic. #02017798
mperez@moinc.net
408.477.2516



HUNTER STORM



- Retail Suite: 1,157± USF/1,432± RSF in New Restaurant/Retail Pad
- Next to the Home of the San Jose Earthquakes – Avaya Stadium
- Spacious Outdoor Area Shared with Co-Tenant Specialty's Café and Slice House & Hops
- Adjacent to 1.5 Million SF of Class-A Office
- Roku occupying over 700,000 SF of adjacent offices, Verizon leasing 640,000 SF
- 1,565 Residential units approved
- Located near I-280, I-880 and Hwy. 87
- Across from Mineta San Jose International Airport
- Short walk to Caltrain and Public Transportation options.
- Free Parking On Site
- Coleman Avenue Traffic: 45,000+ ADT

Site Plan

SITE PLAN TRANCHE 1-3

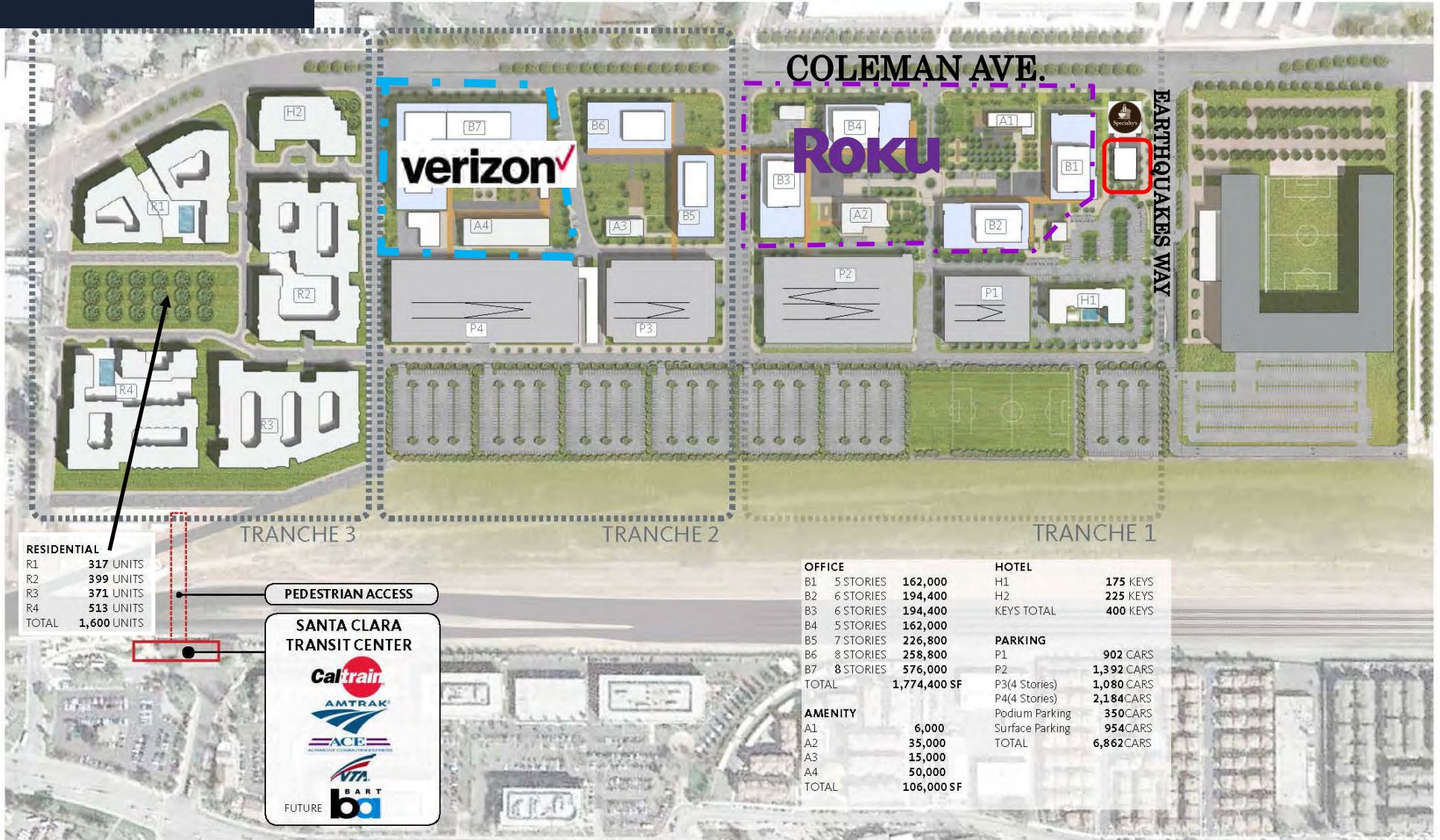

COLEMAN AVE.

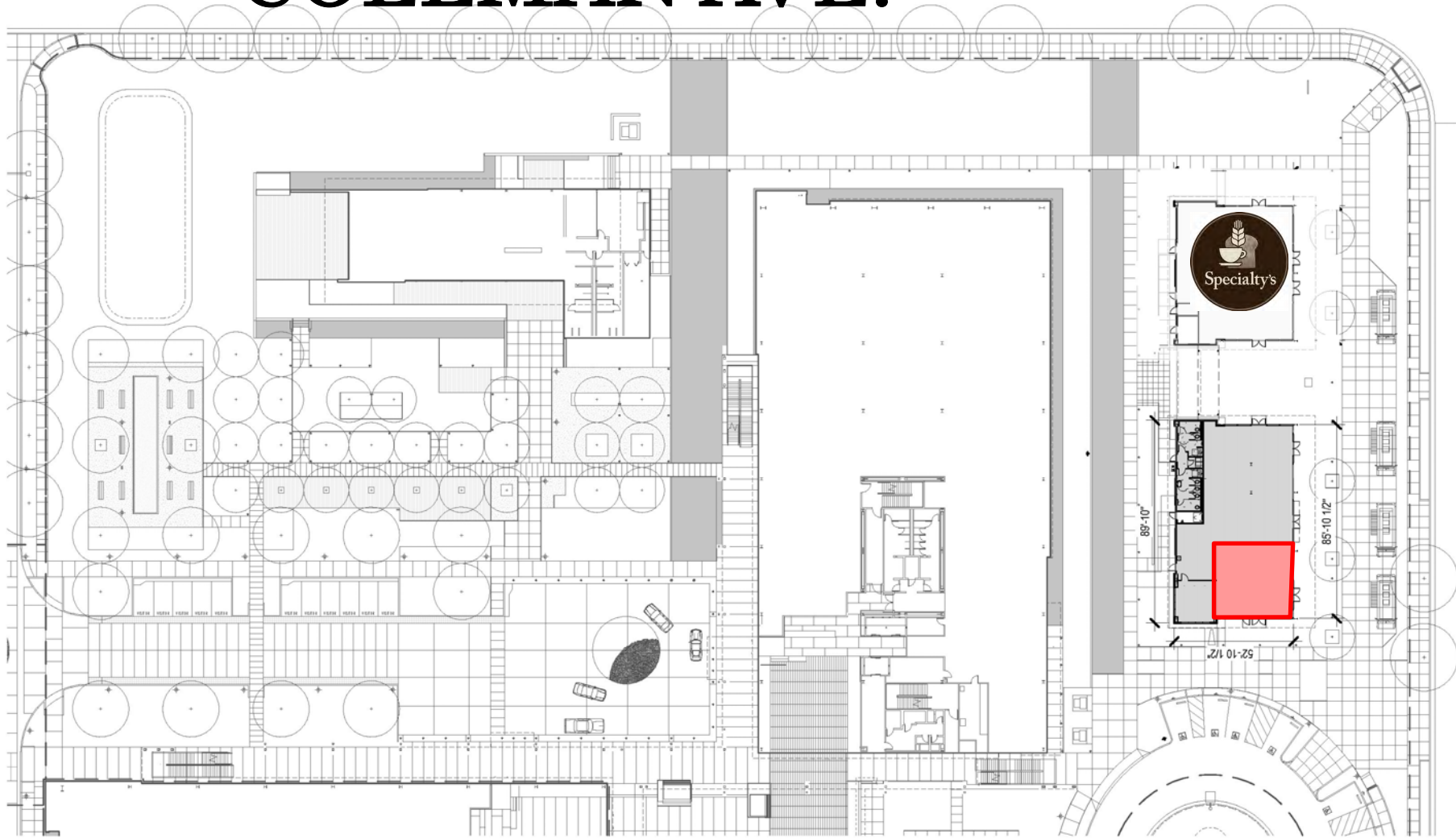

EARTHQUAKES WAY

COLEMAN HIGHLINE

SITE PLAN

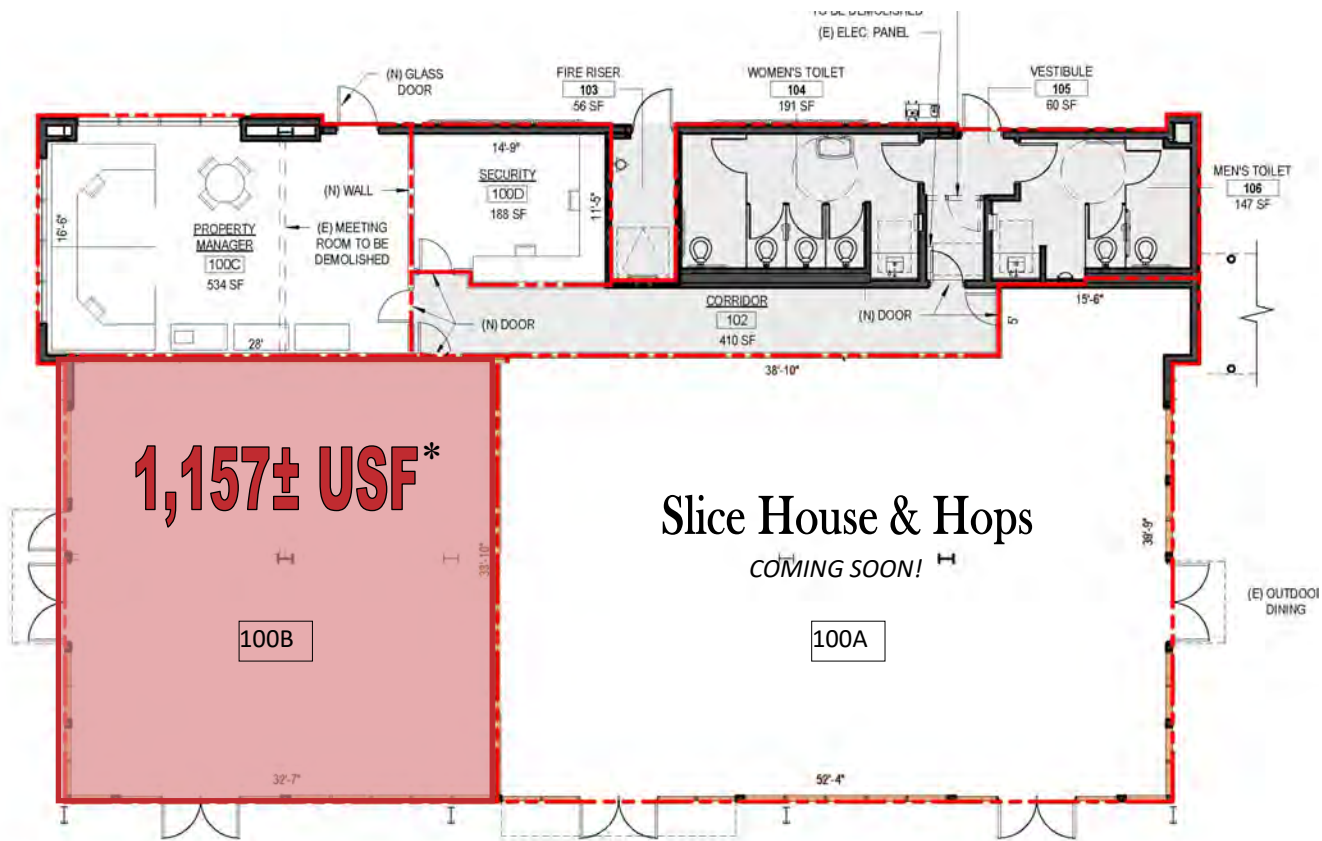

1,157± USF*

Slice House & Hops
COMING SOON!

COLEMAN HIGHLINE: BUILDING A
CAP PHASE I, LLC PROJECT NO. _____

*1,432± RSF



Vicinity Map

Estimated Demographics

	1 Mile	2 Mile	3 Mile
Populations:	11,314	67,182	183,592
Avg. HH Income	\$121,602	\$114,966	\$109,776
Current Employees	16,247	97,529	22,341

Meacham/Oppenheimer, Inc.
 Corfac International
 8 N. San Pedro St., Suite 300
 San Jose, California 95110
 Tel: 408.378.5900
 www.moinc.net

Ryan Warner
 Lic. #01397580
 rwarner@moinc.net
 408.477.2505

Matt Perez
 Lic. #02017798
 mperez@moinc.net
 408.477.2516

