

FOR SALE, LEASE, OR BUILD TO SUIT

FROM ± 1.31 TO ± 4.84 ACRES OF COMMERCIAL LAND

874 - 884 SOUTH CONGRESS AVENUE
PALM SPRINGS, FL 33411



PROPERTY HIGHLIGHTS

- Adjacent to brand new DEFY, Ultimate Extreme Air Experience
- Over 500 Feet of frontage on Congress Avenue
- Preliminary plans ready for a $\pm 4,800$ SF Restaurant and 25,928 SF of Retail Space
- Over \$3 million in infrastructure improvements already in place including utilities, detention, paving, curb cuts and parking
- 1/2 mile from the new Penske Auto Dealership
- Located just south of Summit Blvd with frontage along Congress Ave
- Zoned CG - General Commercial - Palm Springs
- Located in close proximity to Palm Beach International Airport
- Ideal for wide variety of uses including retail, medical, office space
- Parcel ID #s 70-43-44-05-25-003-0000, 70-43-44-05-25-002-0000, and 70-43-44-05-25-004-0000
- 2019 Annual Real Estate Taxes - \$33,117
- 1/4 mile from Trump International

SALE PRICE - \$2,840,000

LEASE RATE - SUBJECT TO SIZE, IMPROVEMENTS, CREDIT, TERM, ETC.



CONTACT

KIRK NELSON

First Vice President
+1 561 227 1803
kirk.nelson@cbre.com

ROBERT SMITH

Executive Vice President
+1 561 478 0330
robert.c.smith@cbre.com

CBRE, Inc.
Licensed Real Estate Broker

CBRE

FOR SALE, LEASE OR BUILD TO SUIT
FROM ±1.31 TO ± 4.84 ACRES
OF COMMERCIAL LAND

874 - 884 SOUTH CONGRESS AVENUE
 PALM SPRINGS, FL 33411

SITE PLAN

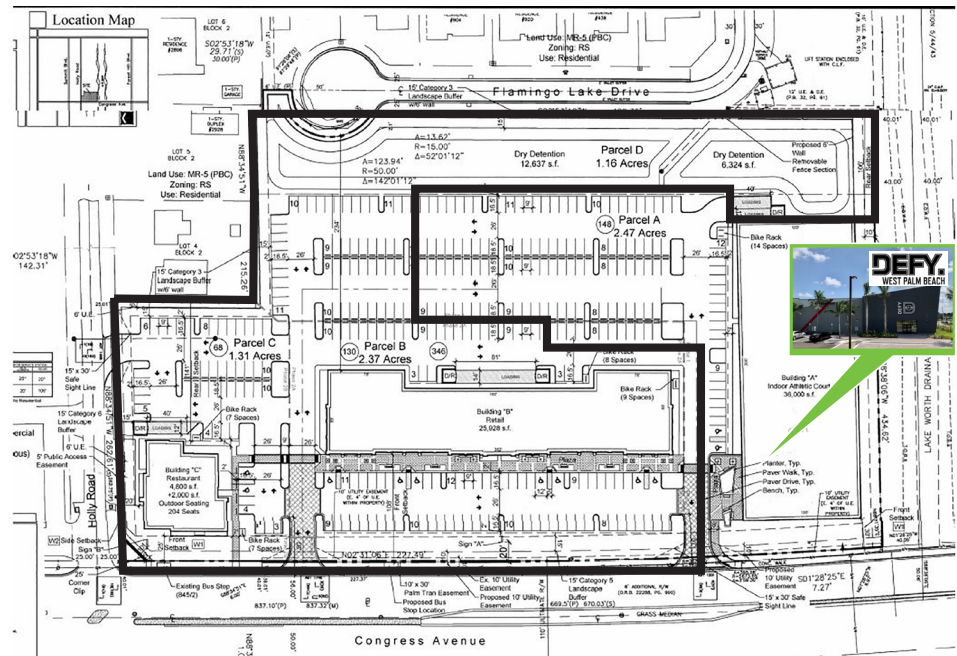

AERIAL MAP



CONTACT

KIRK NELSON

First Vice President
 +1 561 227 1803
 kirk.nelson@cbre.com

ROBERT SMITH

Executive Vice President
 +1 561 478 0330
 robert.c.smith@cbre.com

© 2019 CBRE, Inc. All rights reserved. This information has been obtained from sources believed reliable, but has not been verified for accuracy or completeness. You should conduct a careful, independent investigation of the property and verify all information. Any reliance on this information is solely at your own risk. CBRE and the CBRE logo are service marks of CBRE, Inc. All other marks displayed on this document are the property of their respective owners, and the use of such logos does not imply any affiliation with or endorsement of CBRE. Photos herein are the property of their respective owners. Use of these images without the express written consent of the owner is prohibited.

CBRE, Inc.
 Licensed Real Estate Broker

CBRE