



11626 Cedar Park Ave

Baton Rouge, Louisiana 70809

Property Highlights

- Property is in Excellent Condition
- 1,320 SF of Climate Controlled Warehouse
- Landlord Will Negotiate Adding 551 SF of WH depending on deal terms
- 870 SF Office Area
- 14' Eave Height

Lease Rate

\$10.50 SF/yr (NNN)



For more information

Erin Caballero, CCIM

O: 225 297 7868 | C: 225 241 6530
erinc@latterblum.com

Walt Ketchings

O: 225 297 7705 | C: 225 241 3110
wketchings@latterblum.com

CALL OR EMAIL FOR MORE INFORMATION

NO WARRANTY OR REPRESENTATION, EXPRESS OR IMPLIED, IS MADE AS TO THE ACCURACY OF THE INFORMATION CONTAINED HEREIN, AND THE SAME IS SUBMITTED SUBJECT TO ERRORS, OMISSIONS, CHANGE OF PRICE, RENTAL OR OTHER CONDITIONS, PRIOR SALE, LEASE OR FINANCING, OR WITHDRAWAL WITHOUT NOTICE, AND OF ANY SPECIAL LISTING CONDITIONS IMPOSED BY OUR PRINCIPALS NO WARRANTIES OR REPRESENTATIONS ARE MADE AS TO THE CONDITION OF THE PROPERTY OR ANY HAZARDS CONTAINED THEREIN ARE ANY TO BE IMPLIED. LICENSED IN LOUISIANA.

1700 City Farm Drive
Baton Rouge, LA 70806
225 295 0800 tel
latterblum.com

October 28, 2020



AVAILABLE SF:	2,190 SF
LEASE RATE:	\$10.50 SF/yr (NNN)
LEASE RATE PER MONTH:	\$1,916.25/month
ESTIMATED NNN:	\$2.47/SF
LOT SIZE:	0.155 Acres
GRADE LEVEL DOORS:	2
ZONING:	M1

Property Overview

Stand alone office-warehouse located within Industriplex Business Park. Approx. 870 SF of office and Approx. 1,320 SF of warehouse. Warehouse includes one roll-up door in front of the building and one roll-up door with direct access to the 876 SF secure and gated driveway. Warehouse is climate controlled with 14' eave heights.

Building footprint is easily designed to add approx. 551 SF of WH square footage- landlord willing to negotiate improvements based on deal terms. The office space consists of a lobby/reception area, restroom, and a large room (19 x 29) that can be used for multiples uses. NNN is approx. \$2.47/SF

Location Overview

Cedar Park Ave is located within Industriplex Business Park, a centrally located industrial corridor that connects directly to Airline Hwy and Siegen Ln.

Additional Photos



Property Floor Plan

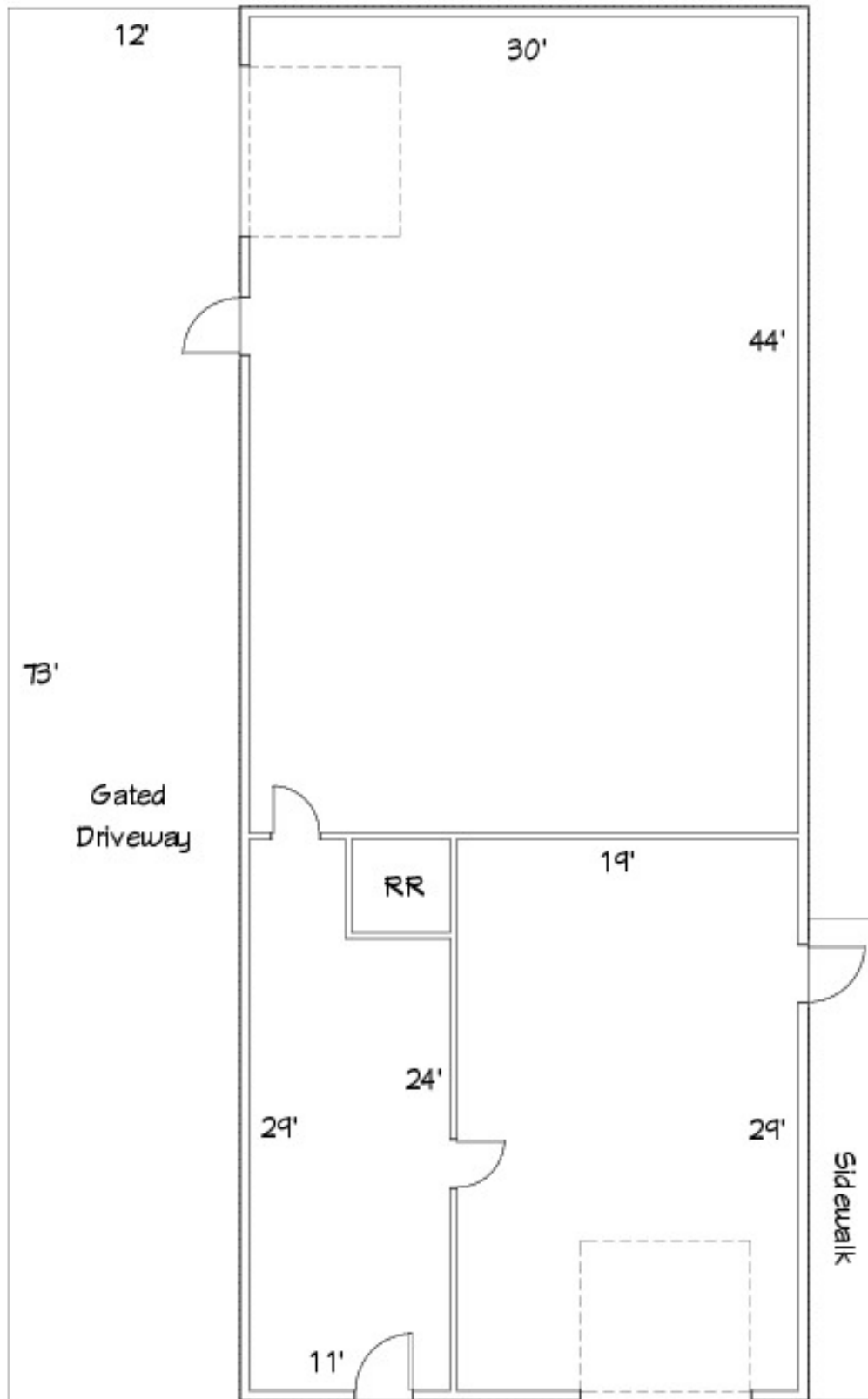

Location Maps

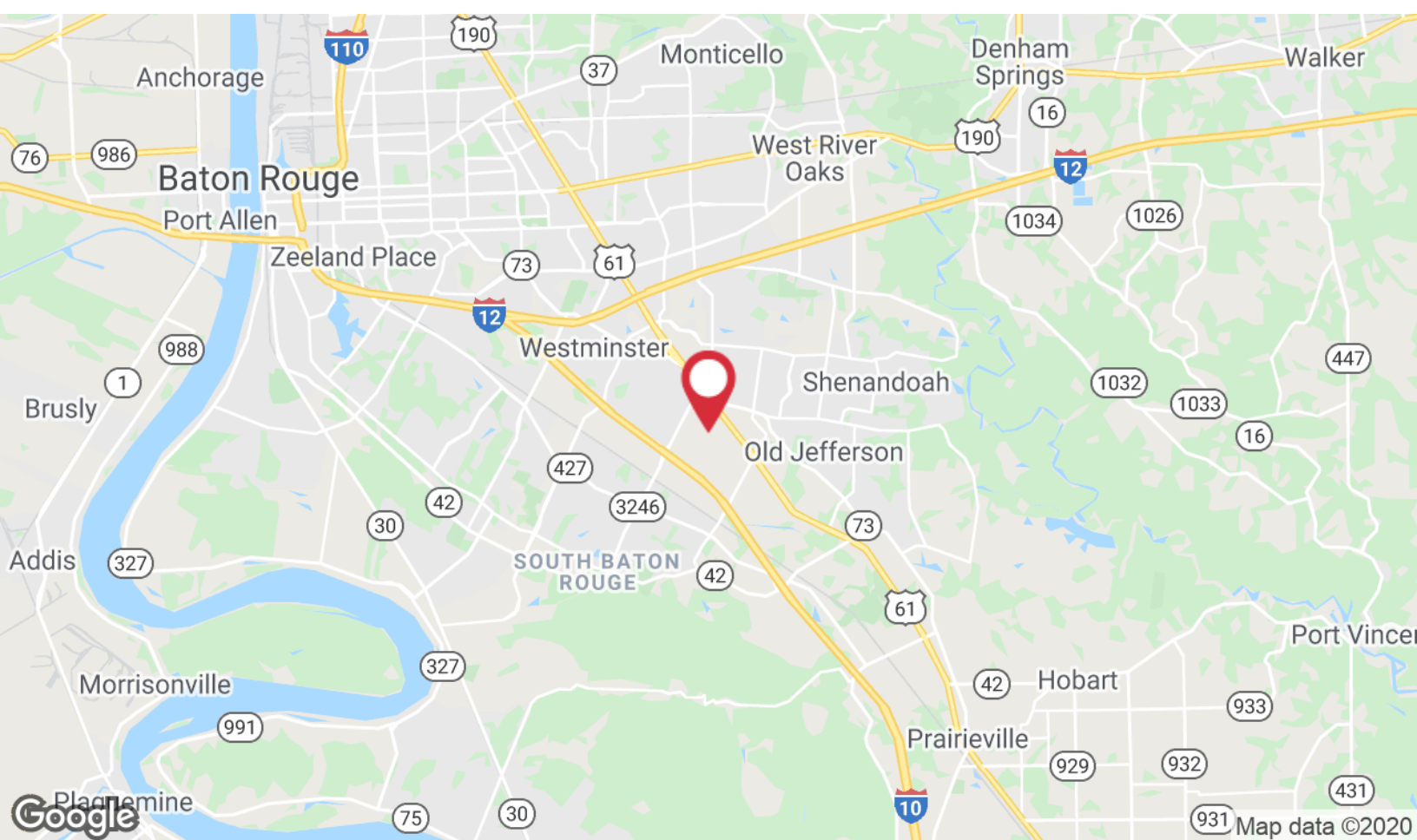

1700 City Farm Drive
Baton Rouge, LA 70806
225 295 0800 tel
latterblum.com