

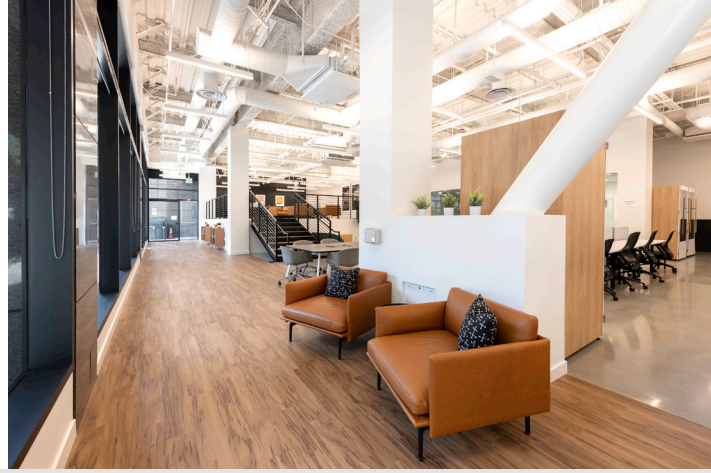

## Rodeo Drive. Modern Flex.

Two partial floors available. Knotel matches, tailors, and manages the space to fit your unique needs, all on flexible terms.



## 131 SOUTH RODEO DRIVE

7,654 RSF

6,969 RSF

Partial 1st

Partial 2nd

60 capacity

47 capacity

March 2020

March 2020

- Building signage available
- Onsite parking & parking garage available
- Brand new creative space. High open ceilings with large windows and street frontage. High end lighting, open concept with private breakout rooms. Offices have glass fronts and creative finishes



# Match. Tailor. Manage.

Knotel's flexible workspace platform adapts to your needs, giving you not only the right space but the right experience, strategy, and design to move your company forward.

**LEVEL:** Partial 1st  
**RSF:** 7,654  
**Max Pers:** 60

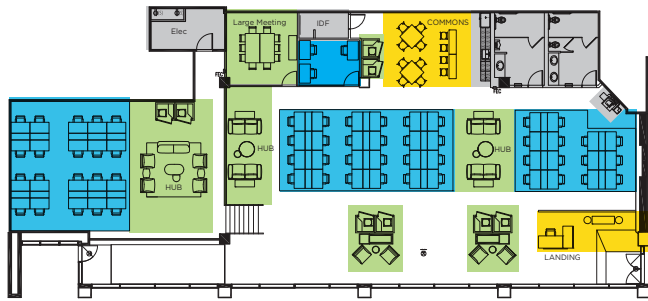

**LEVEL:** Partial 2nd  
**RSF:** 6,969  
**Max Pers:** 47

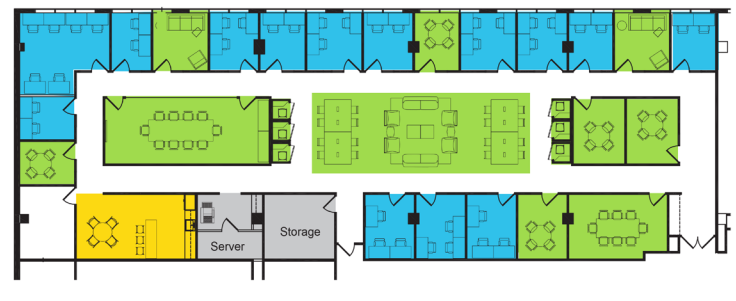

- Workseats**
  - Desks 58
  - Team room 1
- Closed**
  - Medium meeting 1
  - Large meeting 1
  - Hub 4
  - Phone booths 8
- Open**
  - Reception 1
  - Commons 1
- Support**
  - Wellness 1
  - Storage 1
  - IDF 1
  - Restrooms 2

- Workseats**
  - Desks 39
- Closed**
  - Small meeting 5
  - Medium meeting 1
  - Large meeting 1
  - Phone booths 6
  - Collaboration 4
- Open**
  - Commons 1
- Support**
  - Storage 1
  - IDF 1
  - Pantry 1

## 131 SOUTH RODEO DRIVE

To book a tour or for more information, contact:

**Tom Sheets**  
 tom.sheets@cushwake.com  
 +1.310.525.1919  
 License #01252183

**Quint Carroll**  
 quint.carroll@cushwake.com  
 +1.310.525.1931  
 License #01914692



Let's talk about your workspace | 775 527 3814 | lasales@knotel.com | knotel.com