



PILOT
PROPERTY GROUP

10,386 SQ. FT. (1-3 UNITS): 13204 WEST STAR

PROPERTY OVERVIEW:

Industrial Warehouse (Single user presently, 3 overhead doors, possibility of 3 separate users)
Separate utilities if needed.

- Property Type:..... Industrial/Warehouse
- Cross Streets:..... 23 Mile/Schoenherr
- Total Square Footage:..... 10,386
- Building Name:..... Milo's Seating Co.
- Minimum Sq. Ft. Available:.... 2,000 - 3,190
- Maximum Sq. Ft. Available:.... 10,386
- Sale Price:..... \$950,000
- Lot Size:..... 100 x 306
- Parcel Size:..... 0.70
- Year Built:..... 1997
- Zoning:..... L. Industrial
- Ceiling Height:..... 18 Ft.
- Power:..... 220/440
- Heat Type:..... Radiant/FA
- Parking Spaces:..... 20-25
- Property Taxes:..... \$10,600

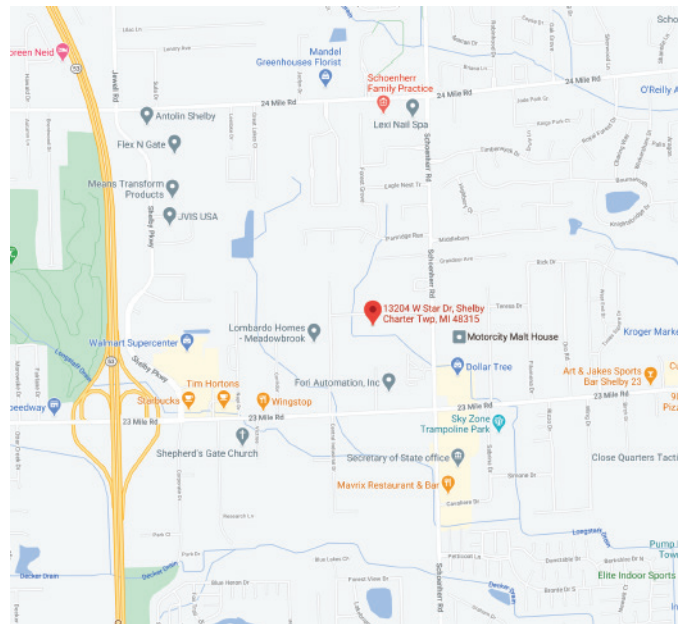

AGENT CONTACT INFO

BOYD KRAFT O: 586.254.0900 • C: 586.243.3488 • boyd@pilotpg.com

Matching the right people to the right place.



Matching the right people to the right place.



Matching the right people to the right place.

Image/Sketch for Parcel: 23-07-14-427-003

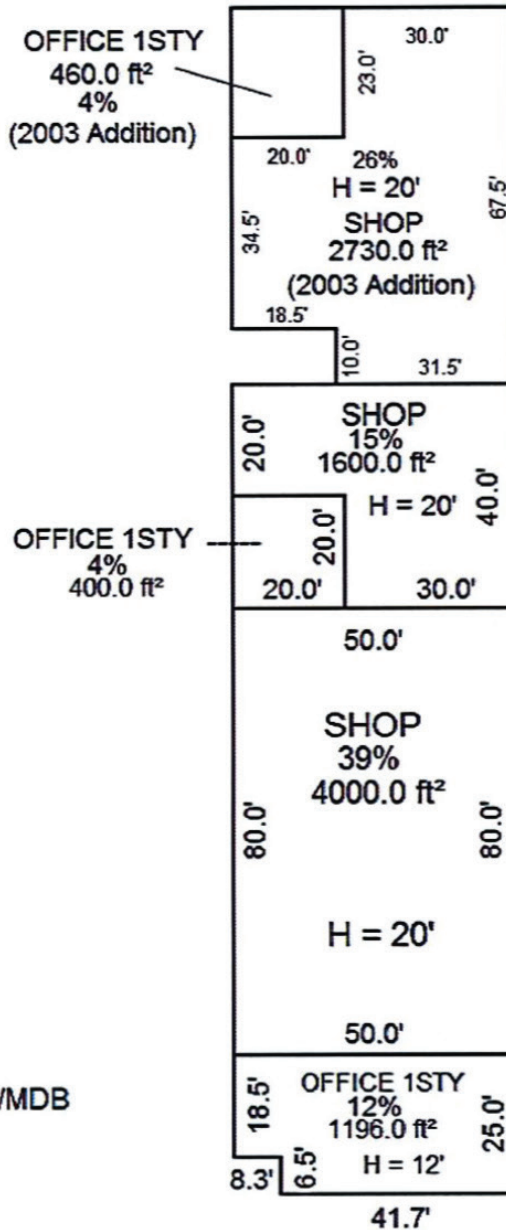

TOTAL S.F. = 10,386

Effective Year Built: 1999

**Office Heat = Package
Shop = Radiant
No Sprinklers
Concrete = 9,550 sf**

Field Visit: 6/19/03 KS/MDB
Field Visit 7/02 MDB
Drawn 2/03 mdb

Sketch by Apex Sketch

Matching the right people to the right place.



Property Analyzer

Macomb County, Michigan

Show search results for 07-14-...

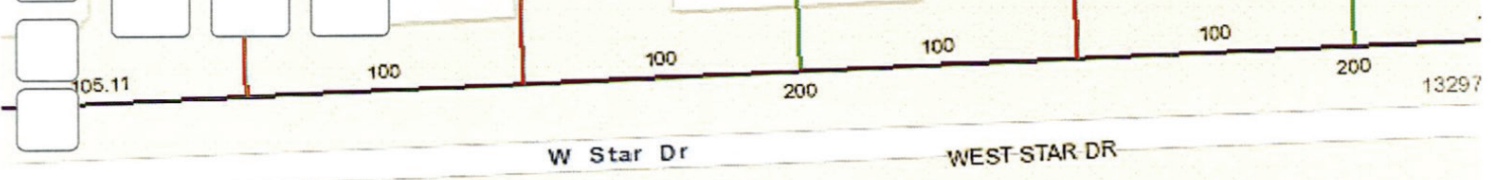

Matching the right people to the right place.