



FOR SALE

1535 River Park Drive

Sacramento, CA

\$80/SF
7 per 1,000
parking

Property Highlights

- Building size: ±30,935 GSF on two floors
- Land Area: 2.27 acres
- Abundant Parking: 210 spaces (±7 spaces/1,000 SF)
- New roof
- Recently painted
- Year Built: 1980
- Zoning: OB-R-P
- Sale Price: \$2,000,000
- \$80 per Square Foot

The Location

- Prominent location with freeway visibility
- Easy access to Business 80 & Highway 160
- Close proximity to Arden Fair Regional Mall & numerous restaurants



Kris Kalmbach

Senior Director

916 288 4421

kris.kalmbach@cushwake.com

LIC# 1436668

400 Capitol Mall, Suite 1800

Sacramento, CA

916 288 4800

cushmanwakefield.com

FOR SALE
1535 River Park Drive
Sacramento, CA



FLOOR PLANS

1ST FLOOR: ±14,593 RSF

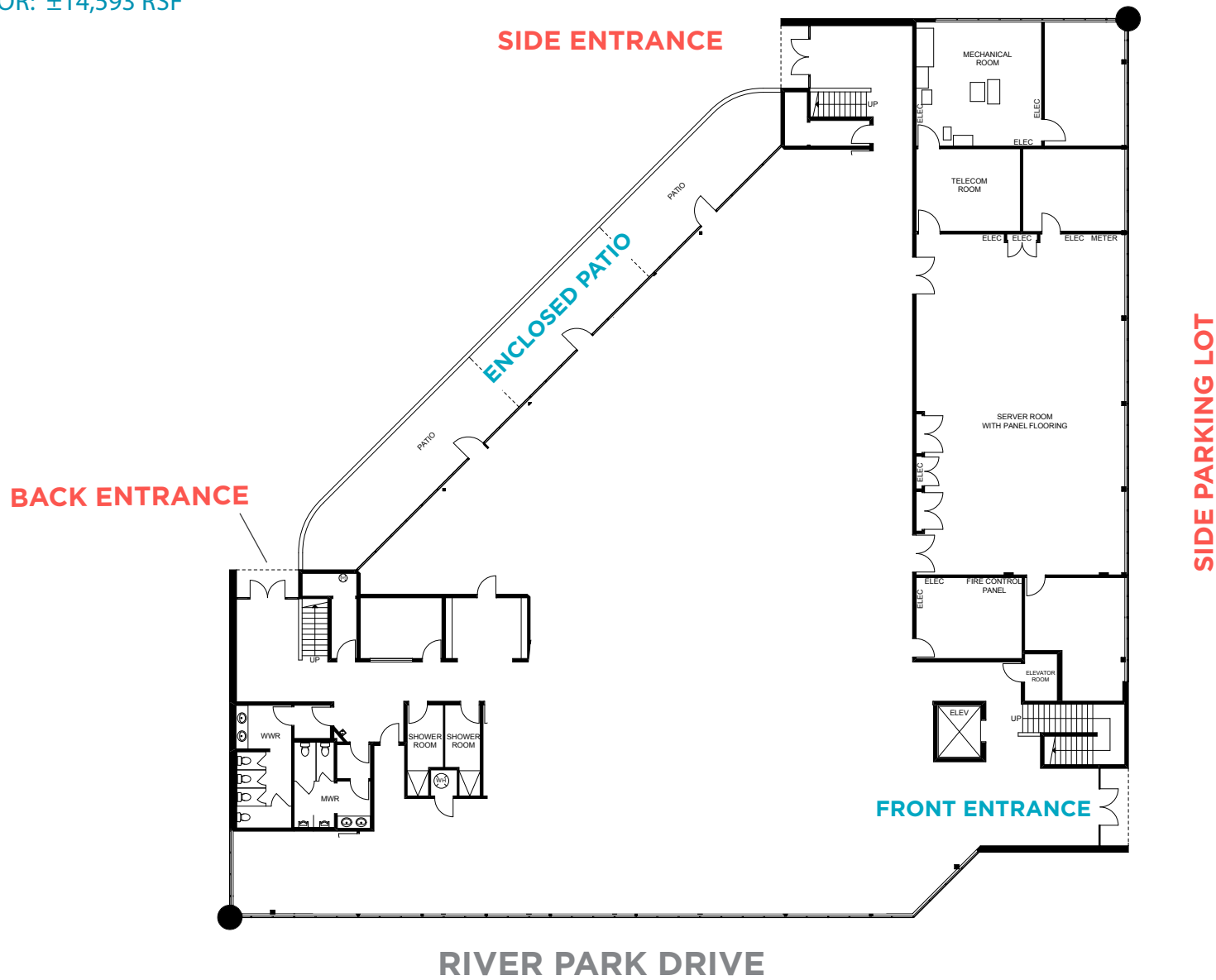

FOR SALE
1535 River Park Drive
Sacramento, CA



FLOOR PLANS

2ND FLOOR: ±14,505 RSF

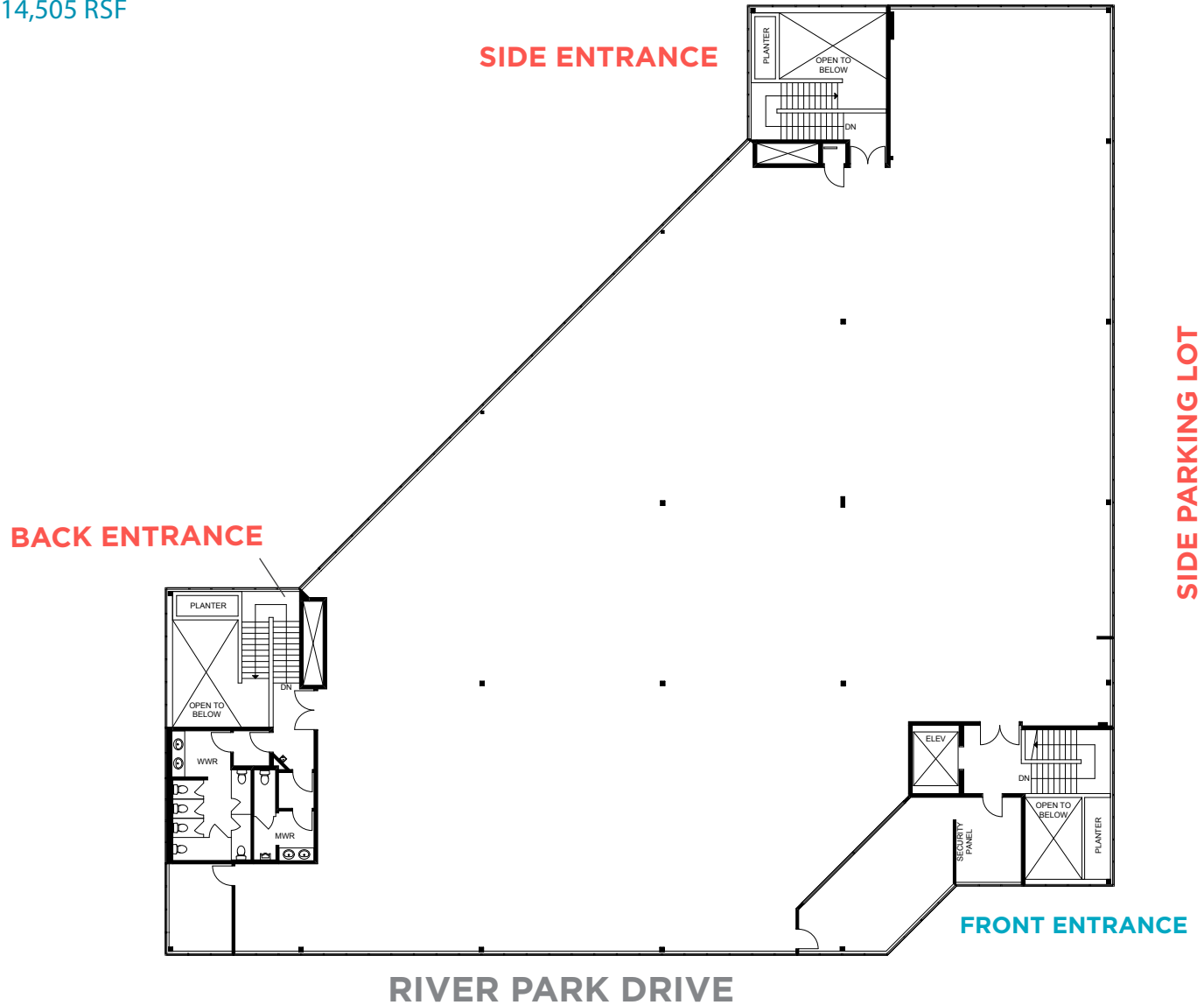

FOR SALE
1535 River Park Drive
Sacramento, CA



GALLERY



FOR SALE
1535 River Park Drive
 Sacramento, CA



POINT WEST PLAZA
 KOHL'S
 OLD NAVY
 HOBBY LOBBY
 PIER 1 IMPORTS
 PETCO

ARDEN MALL
 MACY'S
 JCPENNEY
 APPLE
 COACH
 MICHAEL KORS
 ARMANI EXCHANGE
 SEARS
 NORDSTROM
 LULUEMON
 SEASON 52
 MAGGIANO'S
 MAC

MARKET SQUARE
 UNITED ARTIST THEATRE
 BARNES & NOBLE
 CALIFORNIA PIZZA KITCHEN
 ULTA
 PLUTO'S
 URBAN OUTFITTERS

HBA HOWBOUTARDEN
 CENTURY THEATRES
 NORDSTROM RACK
 HOMEGOODS
 THE CONTAINER STORE
 STARBUCKS
 CARTERS
 PINKBERRY
 TOMATINA
 MOD PIZZA
 JAMBA JUICE

CAL EXPO
 80+ EVENTS PER YEAR
 4M+ ANNUAL VISITORS



★ **PROPERTY**

Howe Avenue

Arden Way

Kris Kalmbach
 Senior Director
 916.288.4421
 kris.kalmbach@cushwake.com
 LIC #1436668

400 Capitol Mall, Suite 1800
 Sacramento, CA 95814
 main 916.288.4800
cushmanwakefield.com

Cushman & Wakefield Copyright 2015. No warranty or representation, express or implied, is made to the accuracy or completeness of the information contained herein, and same is submitted subject to errors, omissions, change of price, rental or other conditions, withdrawal without notice, and to any special listing conditions imposed by the property owner(s). As applicable, we make no representation as to the condition of the property (or properties) in question.