

8580

AVENIDA DE LA FUENTE

SOUTH OTAY MESA BUSINESS PARK



FOR SALE OR LEASE: ±3,969 SQUARE FOOT INDUSTRIAL CONDOMINIUM

PATRICK CONNORS

Associate | 858.458.3359

pconnors@voitco.com | Lic. #02009924

4180 La Jolla Village Drive, Suite 100 | La Jolla, CA 92037 | 858.453.0505 P | 858.408.3976 F | Lic. #01991785 | www.voitco.com

Voit

REAL ESTATE SERVICES

SOUTH OTAY MESA BUSINESS PARK

8580 AVENIDA DE LA FUENTE,
SAN DIEGO, CA 92154

FOR SALE
OR LEASE

PROPERTY FEATURES

- » ±3,969 SF Industrial Condominium
- » \$0.90 PSF/IG
- » Grade Loading Doors [2]
- » Shared dock well [1]
- » Restrooms [2]
- » 20' Clear Height
- » ±1.58/1000 Parking Ratio

AVAILABILITY

- » Suite D: ±3,969 SF
- » \$550,000 (\$138.57 PSF)
- » \$0.90 PSF/IG

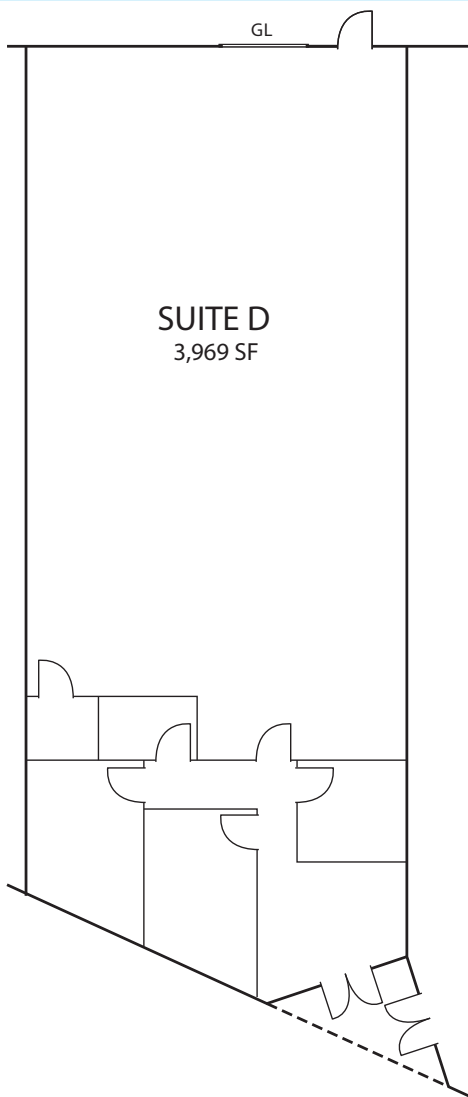

PATRICK CONNORS, *Associate*

858.458.3359 | pconnors@voitco.com | Lic. #02009924

4180 La Jolla Village Drive, Suite 100, La Jolla, CA 92037 | 858.453.0505 | 858.408.3976 Fax | Lic #01991785 | www.voitco.com

Licensed Real Estate Salespersons by the CA Bur of Real Estate. The information contained herein has been obtained from sources we deem reliable. While we have no reason to doubt its accuracy, we do not guarantee it. ©2017 Voit Real Estate Services, Inc. All Rights Reserved. Real People. Real Solutions.® is a registered trademark of Voit Real Estate Services.

Voit

REAL ESTATE SERVICES