

# FOR LEASE | INDUSTRIAL/WAREHOUSE SPACE

121 BROADWAY , DOVER, NH 03820



## PROPERTY DETAILS

- Walking distance to downtown Dover.
- Ideal space for warehousing or manufacturing.
- 6 cranes with 38' clear heights.
- Less than 2 miles to the Spaulding Turnpike and 10 miles to I-95.
- On site café serving breakfast and lunch (7:30AM - 2:00PM)
- Professionally managed.





# FOR LEASE | INDUSTRIAL/WAREHOUSE SPACE

121 BROADWAY, DOVER, NH 03820



## PROPERTY DETAILS

AVAILABLE SIZE	28,000± SF
AVAILABLE	May 1, 2021
LOT SIZE	17.16± AC
ZONING	Industrial
CEILING HEIGHT	38'
UTILITIES	Natural gas; Unutil Municipal water and sewer
HVAC	Gas-fired radiant heat
ELECTRICAL	277/480 Volt/3 Phase/2500 Amp
SPRINKLER	Wet System
PARKING	Ample on-site
LOADING DOCKS	2 Loading docs (8' x 10') 1 Overhead drive-through door (16' x 18')
CRANES	Six Cranes (Four 20 Ton /Two 50 Ton)
ROOF	Insulated rubber membrane over reinforced metal roof deck
UTILITY EXPENSES	Tenant responsible for electric and gas.
NNN EXPENSES (EST.)	Taxes: \$0.78/SF CAM: \$2.18/SF Total: \$2.96/SF
LEASE RATE	\$7.50/SF NNN

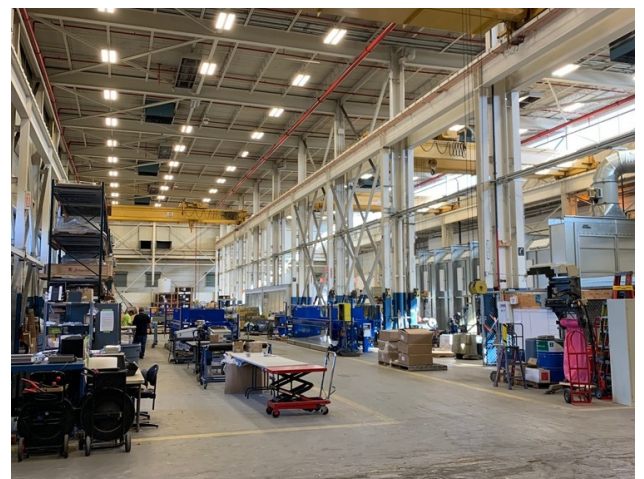

# FOR LEASE | INDUSTRIAL/WAREHOUSE SPACE

121 BROADWAY, DOVER, NH 03820



## AERIAL & FLOOR PLAN

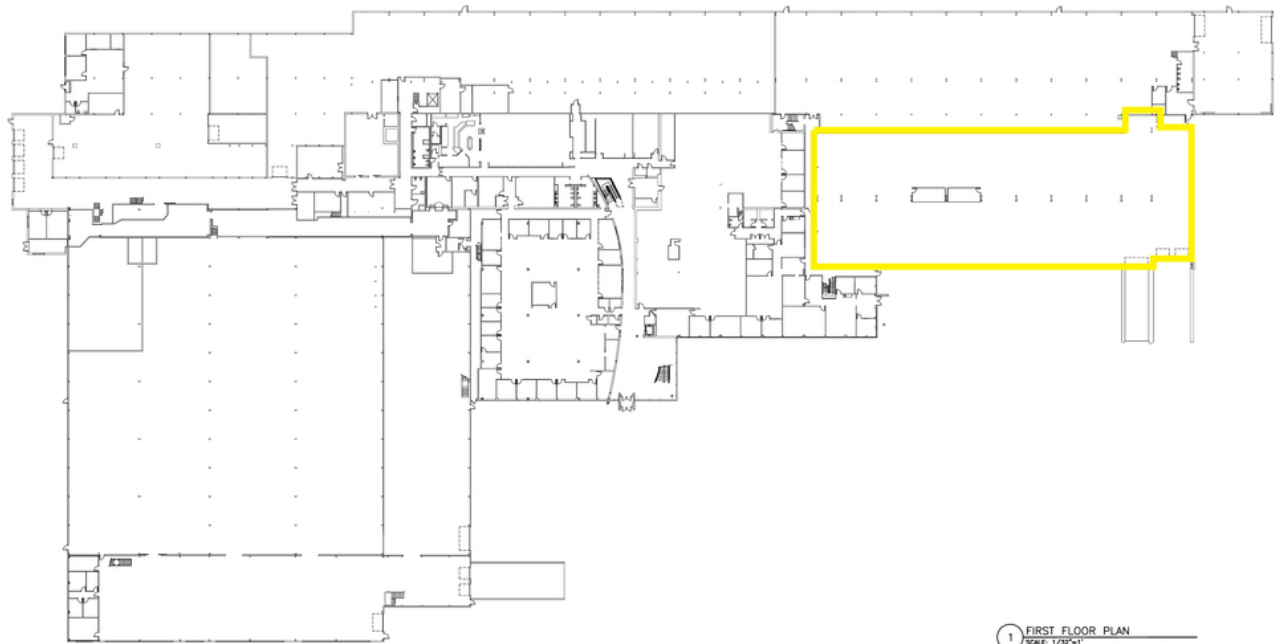



# FOR LEASE | INDUSTRIAL/WAREHOUSE SPACE

121 BROADWAY, DOVER, NH 03820

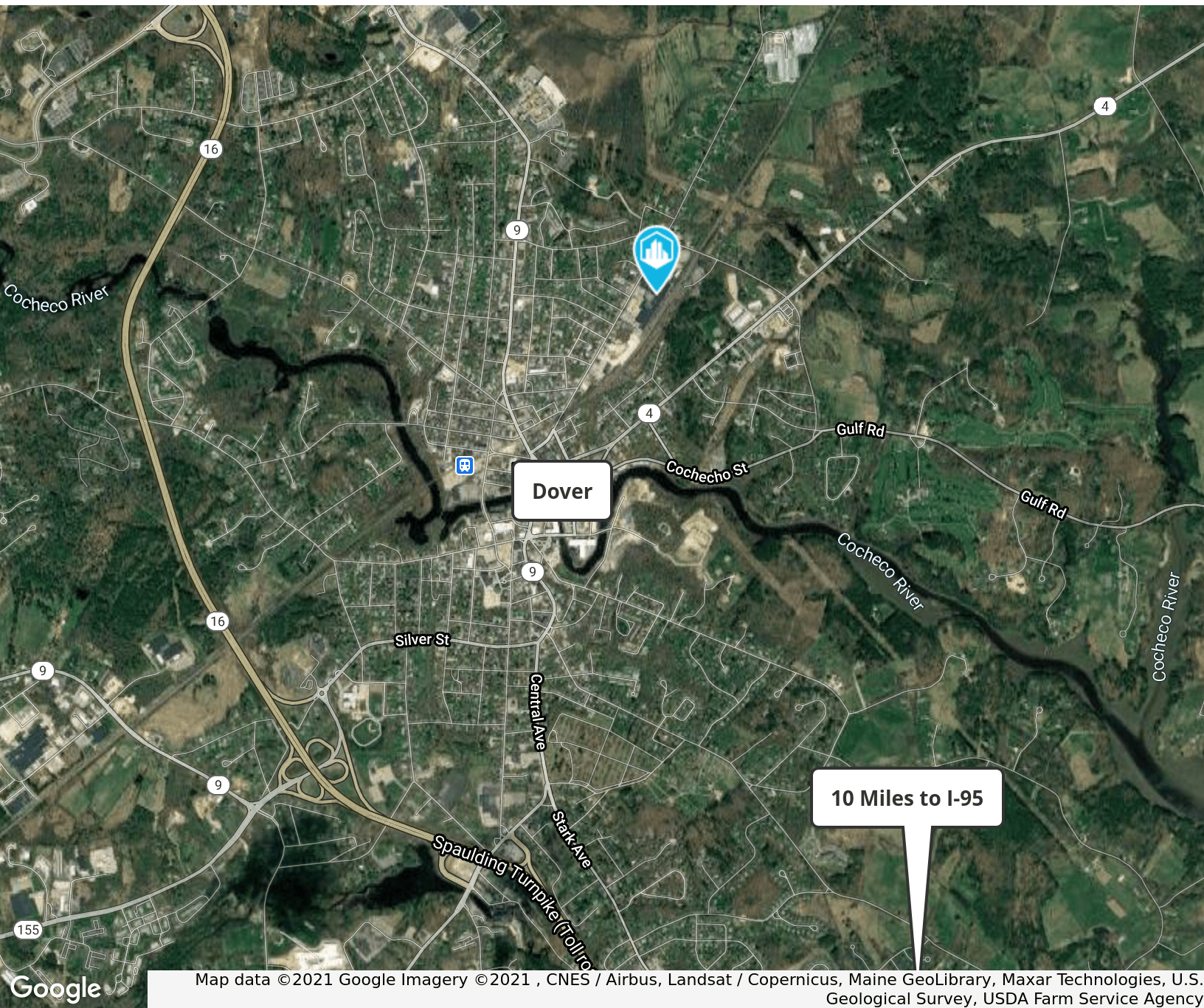

## CONTACT US



**KENT WHITE**  
Principal Broker | Partner  
+1 603.570.2699 D  
+1 603.781.6546 C  
kwhite@boulos.com



**CAITLIN BURKE**  
Associate  
+1 603.570.2680 D  
+1 978.302.8197 C  
cburke@boulos.com

2021 Boulos Holdings, LLC d/b/a The Boulos Company. All rights reserved. This information has been obtained from sources believed reliable, but has not been verified for accuracy or completeness. You should conduct a careful, independent investigation of the property and verify all information. Any reliance on this information is solely at your own risk. The Boulos Company and The Boulos Company logo are service marks of The Boulos Company, Inc. and Boulos Holdings, LLC. All other marks displayed on this document are the property of their respective owners. Photos herein are the property of their respective owners. Use of these images without the express written consent of the owner is prohibited.