

Office Space for LEASE

±2,146 SF



FEATURES:

Located in an attractive office complex with an elegant lobby and lush landscaping!

Twelve minutes from Phoenix Sky Harbor Airport, this first floor office includes the following features:

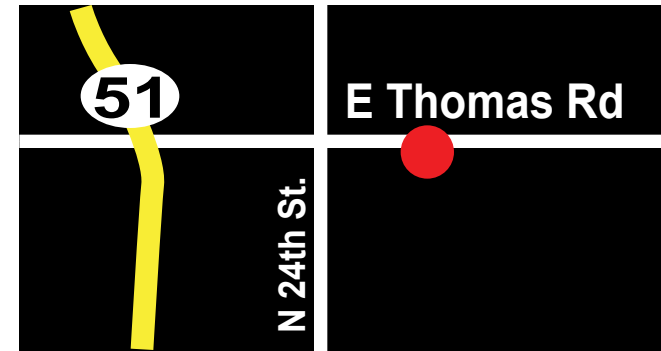

2601 E Thomas Road | Suites 132/135 | Phoenix, Arizona 85028

For more information or to schedule a tour, please contact John or Suzanne:



John Quatrini
Associate Broker
C 602.859.0506
O 480.443.3992
jq@shellcommercial.com



Suzanne Enright
Sales/Leasing Real Estate Agent
C 602.471.2981
O 480.443.3992
suzanne@shellcommercial.com

SHELL

Commercial Investment Real Estate

480.443.3992

shellcommercial.com

16410 N 91st St Ste 112
Scottsdale, AZ 85260

2601 E Thomas Road | Suites 132/135 | Phoenix, Arizona 85028

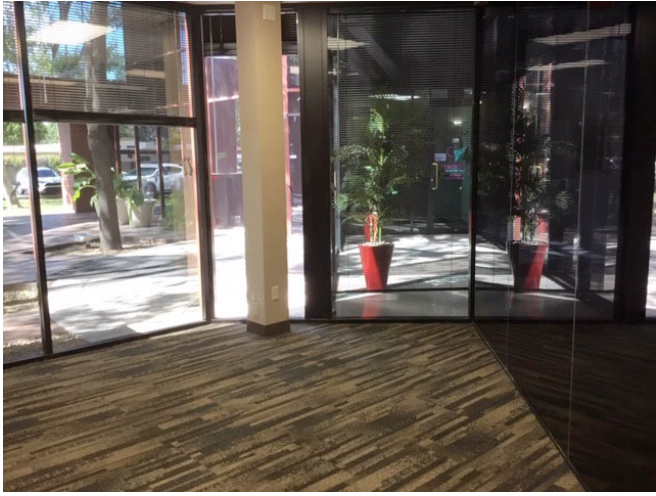

- Reception, Conference room
- Six (6) offices + 3 work stations
- Contemporary look and feel!

2601 E Thomas Road | Suite 132/135

± 2,146 RENTABLE SQ. FT.

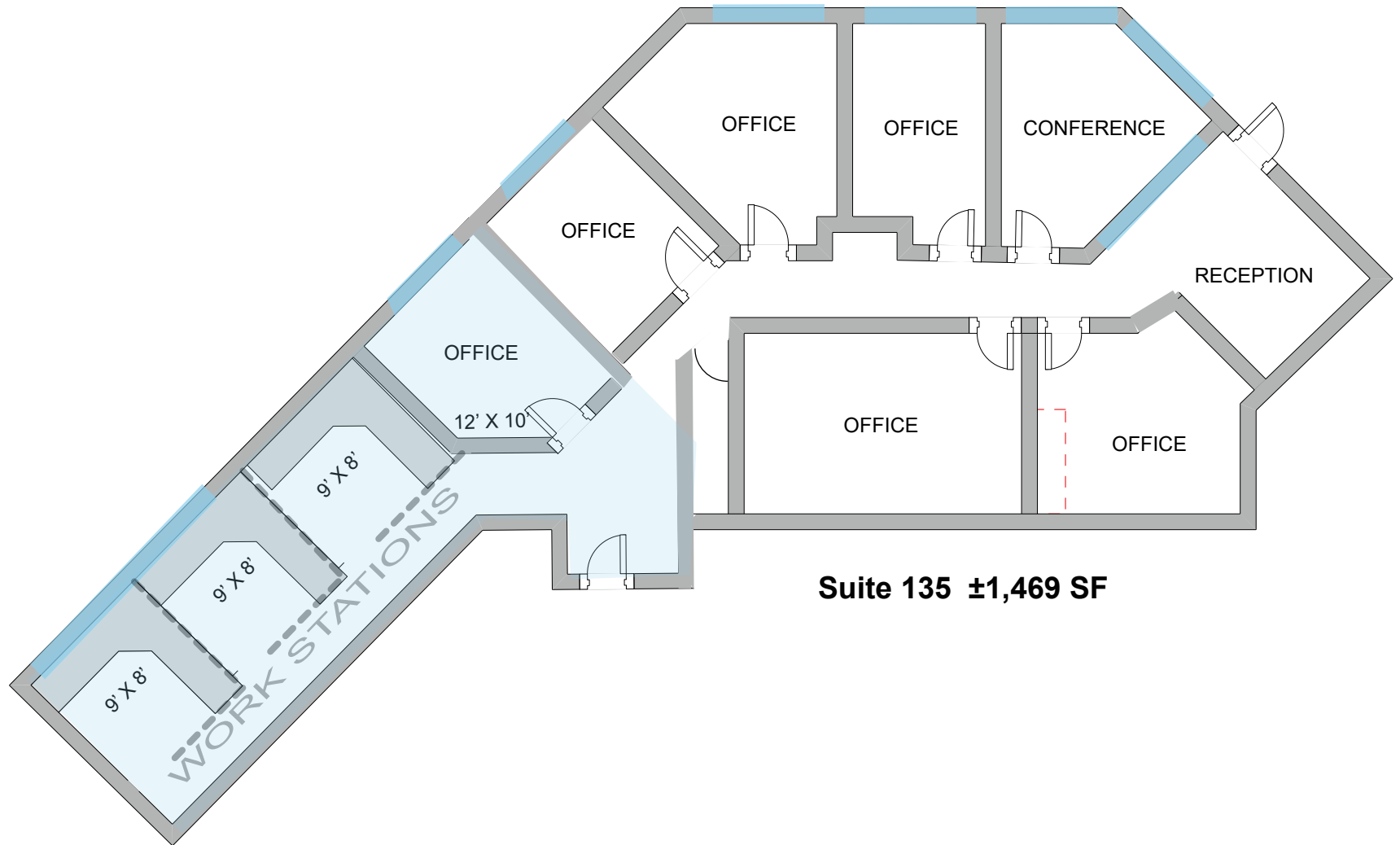

Suite 132
±677 SF

Suite 135 ±1,469 SF

NOT TO SCALE

All information furnished regarding property for sale, rental or financing is from sources deemed reliable, but no warranty or representation is made to the accuracy thereof and same is submitted to errors, omissions, change of price, rental or other conditions, prior to sale, lease or financing or withdrawal without notice. No liability of any kind is to be imposed on the broker herein. This information has been secured from sources deemed reliable, however, we make no warranties as to its accuracy.

PHOENIX

N 24th Street

E Thomas Road

