

## Fostoria Business Park - Building B

4455-4497 S 134th Place  
Suite 4477  
Tukwila, WA

5,233 total SF

450 office SF

\$0.68 shell

\$0.75 office add-on

\$0.2358 NNN (approximate)

2 dock high doors

± 20' clear height

125 amps 480v 3-phase power  
approximately

Immediate access to I-5, I-405,  
and SR-599

206 area code

Seattle mailing address

No B&O tax

Available now



[fostoriabusinesspark.com](http://fostoriabusinesspark.com)

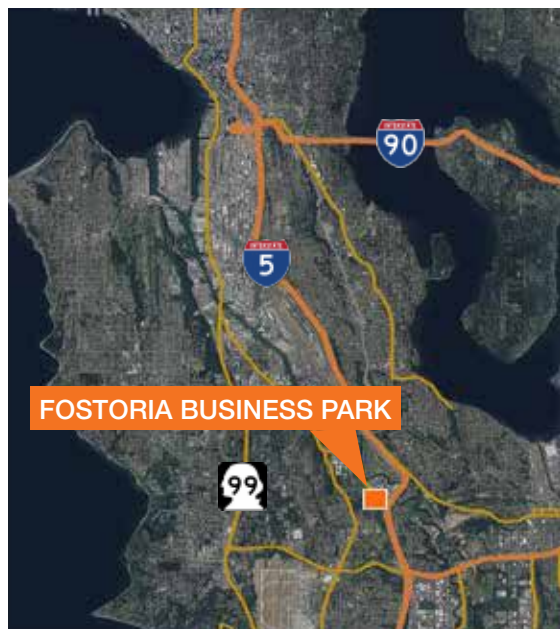

### Contact

**Evan Lugar**

206.248.6505

[elugar@kiddermathews.com](mailto:elugar@kiddermathews.com)

**Tony Miltenberger, SIOR**

206.248.7307

[tonym@kiddermathews.com](mailto:tonym@kiddermathews.com)

## Fostoria Business Park - Building B

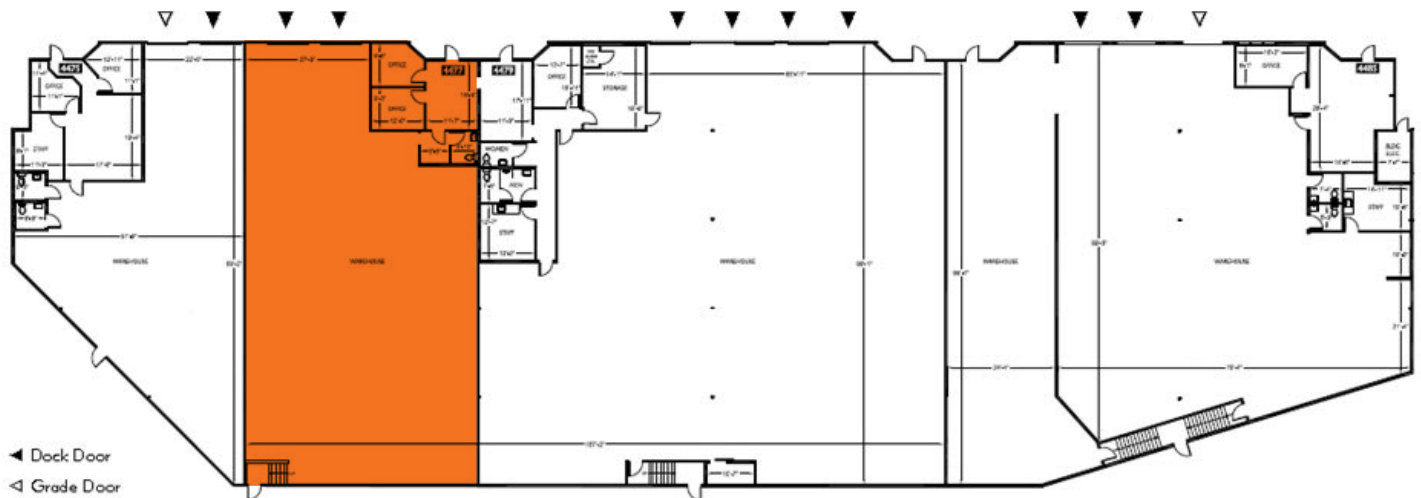

### Contact

**Evan Lugar**  
206.248.6505  
elugar@kiddermathews.com

**Tony Miltenberger, SIOR**  
206.248.7307  
tonym@kiddermathews.com

## Fostoria Business Park - Building B



### Contact

**Evan Lugar**  
206.248.6505  
elugar@kiddermathews.com

**Tony Miltenberger, SIOR**  
206.248.7307  
tonym@kiddermathews.com