

PRIME RETAIL SPACE ADJACENT TO KOHL'S

Anderson, SC 29621 | 130 Fritz Drive | Clemson Blvd & Beltline Blvd | #1261

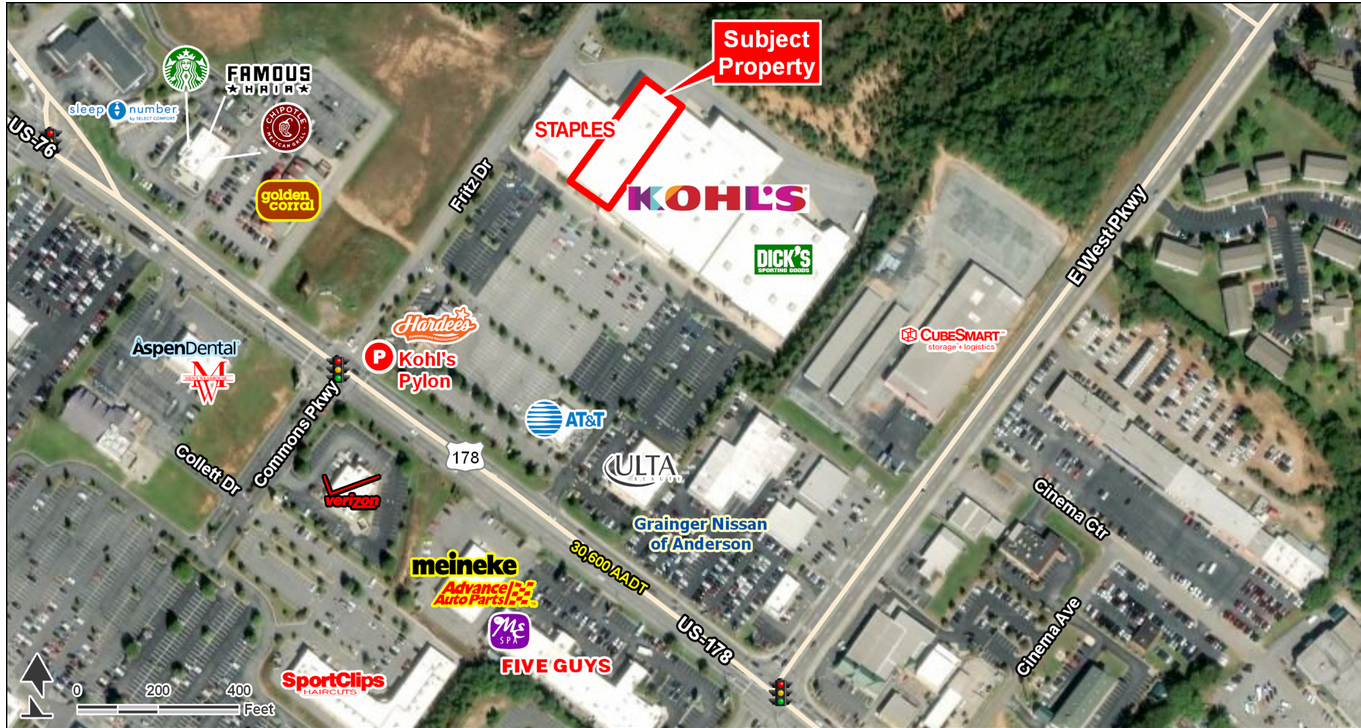

- 24,200 SF junior anchor space available at Midtowne Park, a 173,868 SF community center anchored by Kohl's, Dick's Sporting Goods, Staples and Ulta
- Midtowne Park is located in the heart of Anderson's retail corridor which has limited anchor and junior anchor space available
- Visible and directly accessible from N Main St./U.S. Route 76
- Pylon signage available

DEMOGRAPHICS	1 MILE	3 MILES	5 MILES	TRAFFIC COUNTS	
2019 Population Density	4,352	32,403	66,877	Clemson Blvd	30,600 AADT
2019 Daytime Population	5,958	24,937	45,850	E West Pkwy	11,300 AADT
2019 Average HH Income	\$59,993	\$67,413	\$65,519		
2019 Median HH Income	\$50,053	\$50,302	\$46,823		

AVAILABLE SF:
24,200 SF

FRONTAGE:
APPROX 98' 3"

ZONING:
COMMERCIAL

RATES:
CALL FOR DETAILS

AREA ANCHORS



FOR MORE INFORMATION, CONTACT EXCLUSIVE AGENT(S):
 DAWN PRINCE HOOVER • dawn.princehoover@tscg.com • 704.335.5455
 JACK BRENNAN • jack.brennan@tscg.com • 704.335.5455



PRIME RETAIL SPACE ADJACENT TO KOHL'S

Anderson, SC 29621 | 130 Fritz Drive | Clemson Blvd & Beltline Blvd | #1261

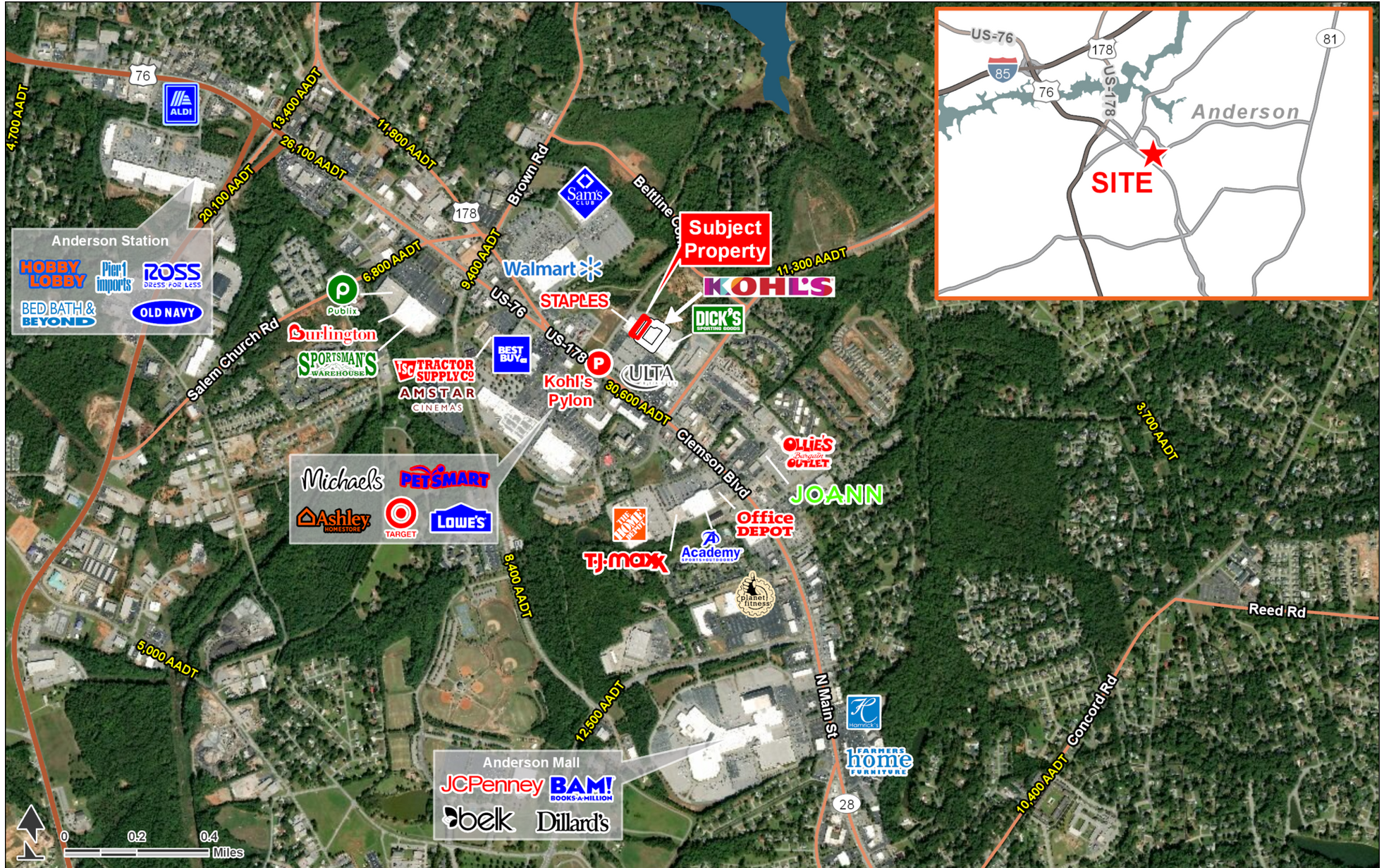

FOR MORE INFORMATION, CONTACT EXCLUSIVE AGENT(S):
 DAWN PRINCE HOOVER • dawn.princehoover@tscg.com • 704.335.5455
 JACK BRENNAN • jack.brennan@tscg.com • 704.335.5455



Demographics: Esri 2018 No warranty expressed or implied has been made as to the accuracy of the information provided herein, no liability assumed for error or omissions.

PRIME RETAIL SPACE ADJACENT TO KOHL'S

Anderson, SC 29621 | 130 Fritz Drive | Clemson Blvd & Beltline Blvd | #1261



FOR MORE INFORMATION, CONTACT EXCLUSIVE AGENT(S):
 DAWN PRINCE HOOVER • dawn.princehoover@tscg.com • 704.335.5455
 JACK BRENNAN • jack.brennan@tscg.com • 704.335.5455

Stan Johnson Co.
 THE NET LEASE AUTHORITY™

CHAINLINKS
 RETAIL ADVISORS

Demographics: Esri 2018 No warranty expressed or implied has been made as to the accuracy of the information provided herein, no liability assumed for error or omissions.

PRIME RETAIL SPACE ADJACENT TO KOHL'S

Anderson, SC 29621 | 130 Fritz Drive | Clemson Blvd & Beltline Blvd | #1261

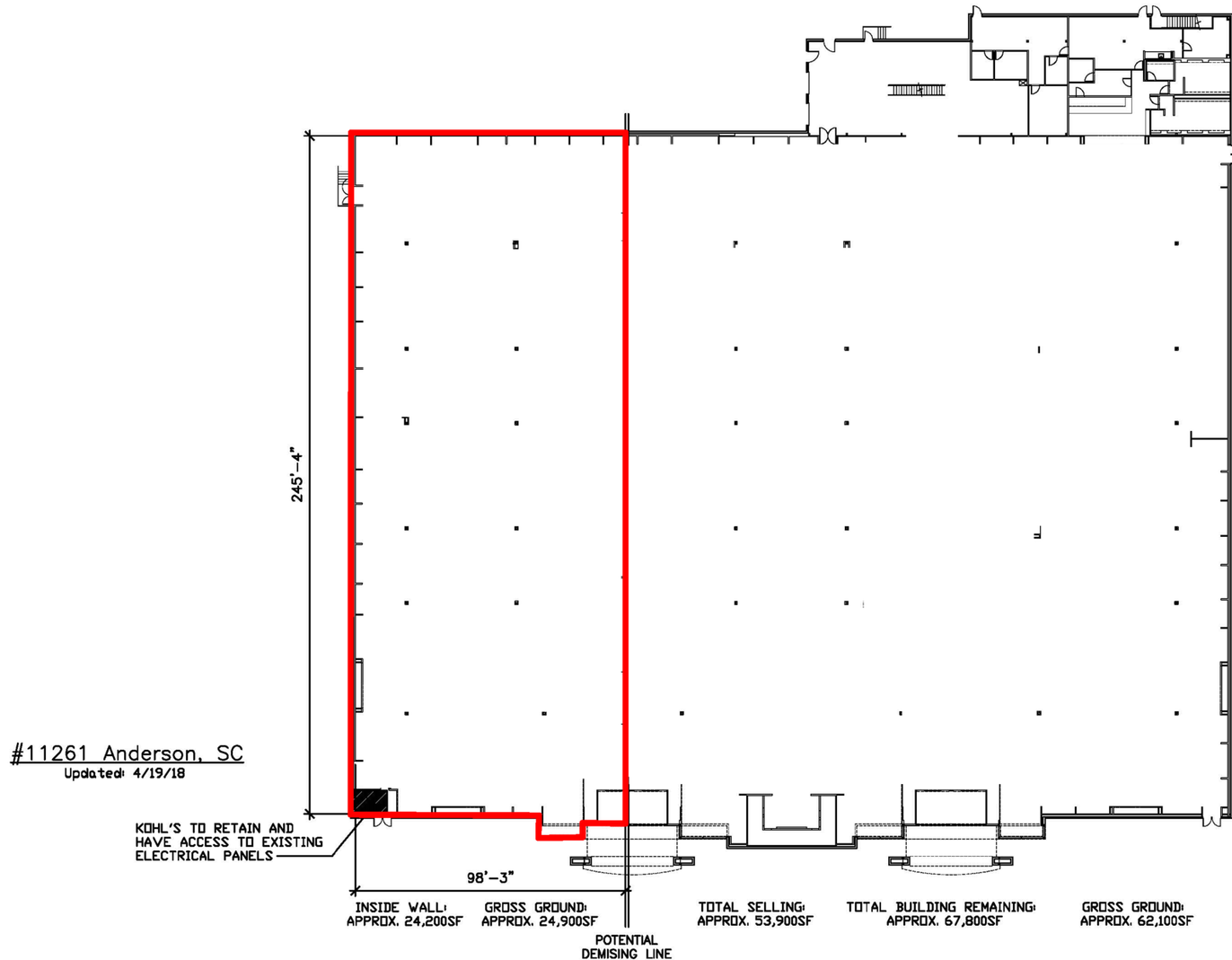

FOR MORE INFORMATION, CONTACT EXCLUSIVE AGENT(S):

DAWN PRINCE HOOVER • dawn.princehoover@tscg.com • 704.335.5455

JACK BRENNAN • jack.brennan@tscg.com • 704.335.5455

