



SAURAGE ROTENBERG™
COMMERCIAL REAL ESTATE

LAND FOR SALE

HWY. 44 DEVELOPMENT

HWY. 44, GONZALES, LA 70737

+/- 3.63 ACRES



OFFERING SUMMARY

| | |
|--------------------|-----------------------|
| Sale Price: | \$1,265,000 |
| Lot Size: | +/- 3.63 Acres |
| Price / SF | \$8.00 |
| Zoning: | COMMERCIAL |

PROPERTY HIGHLIGHTS

- Fully Cleared Land on Hwy. 44
- High Traffic / High Visibility
- Approximately 120' + 116' Frontage on Hwy. 44
- Outside of City Limits
- Center of Projected Growth
- Adjacent to Lowes Shopping Complex

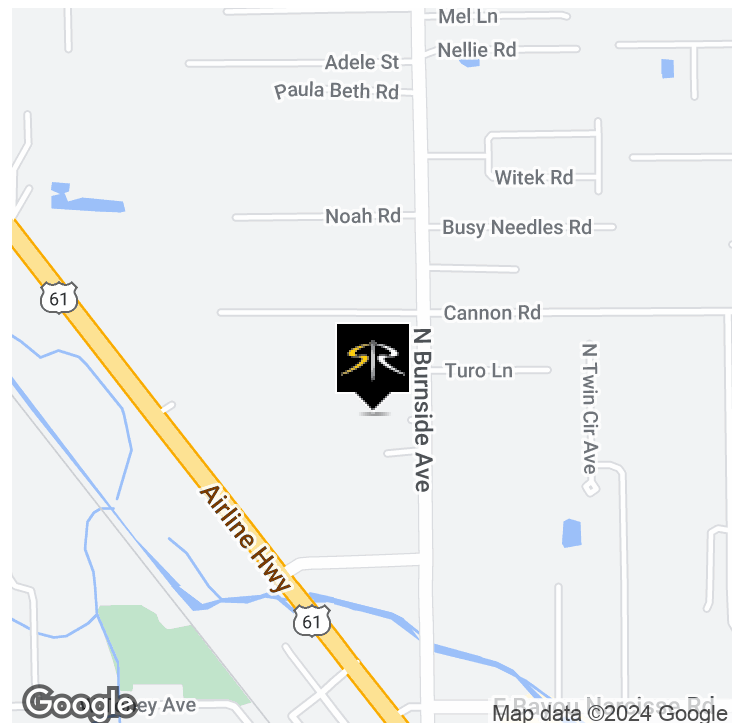

BILL JEANSONNE

Commercial Investment Specialist
(D)225.802.2932
bill@sr-cre.com

DON HANNA

Commercial Sales & Leasing
(D)225.802.5450
don@sr-cre.com

SAURAGE ROTENBERG COMMERCIAL REAL ESTATE, LLC

5135 Bluebonnet Boulevard
Baton Rouge, LA 70809
225.766.0000 | sauragerotenberg.com

The information contained herein has either been given to us by property owners or is from sources deemed reliable and is believed to be correct, it is not in any way warranted or guaranteed by Saurage Rotenberg Commercial Real Estate. This information is submitted subject to errors, omissions, changes in price, rental or other conditions, withdrawal without notice, and to any special listing conditions imposed by the principals. Licensed in Louisiana & Mississippi.



SAURAGE ROTENBERG™
COMMERCIAL REAL ESTATE

FOR SALE

HWY. 44 DEVELOPMENT

HWY. 44, GONZALES, LA 70737

+/- 3.63 ACRES



BILL JEANSONNE

Commercial Investment Specialist

(D)225.802.2932

bill@sr-cre.com

DON HANNA

Commercial Sales & Leasing

(D)225.802.5450

don@sr-cre.com

SAURAGE ROTENBERG COMMERCIAL REAL ESTATE, LLC

5135 Bluebonnet Boulevard

Baton Rouge, LA 70809

225.766.0000 | sauragerotenberg.com

The information contained herein has either been given to us by property owners or is from sources deemed reliable and is believed to be correct, it is not in any way warranted or guaranteed by Saurage Rotenberg Commercial Real Estate. This information is submitted subject to errors, omissions, changes in price, rental or other conditions, withdrawal without notice, and to any special listing conditions imposed by the principals. Licensed in Louisiana & Mississippi.



SAURAGE ROTENBERG™
COMMERCIAL REAL ESTATE

SURVEY

HWY. 44 DEVELOPMENT

HWY. 44, GONZALES, LA 70737

+/- 3.63 ACRES

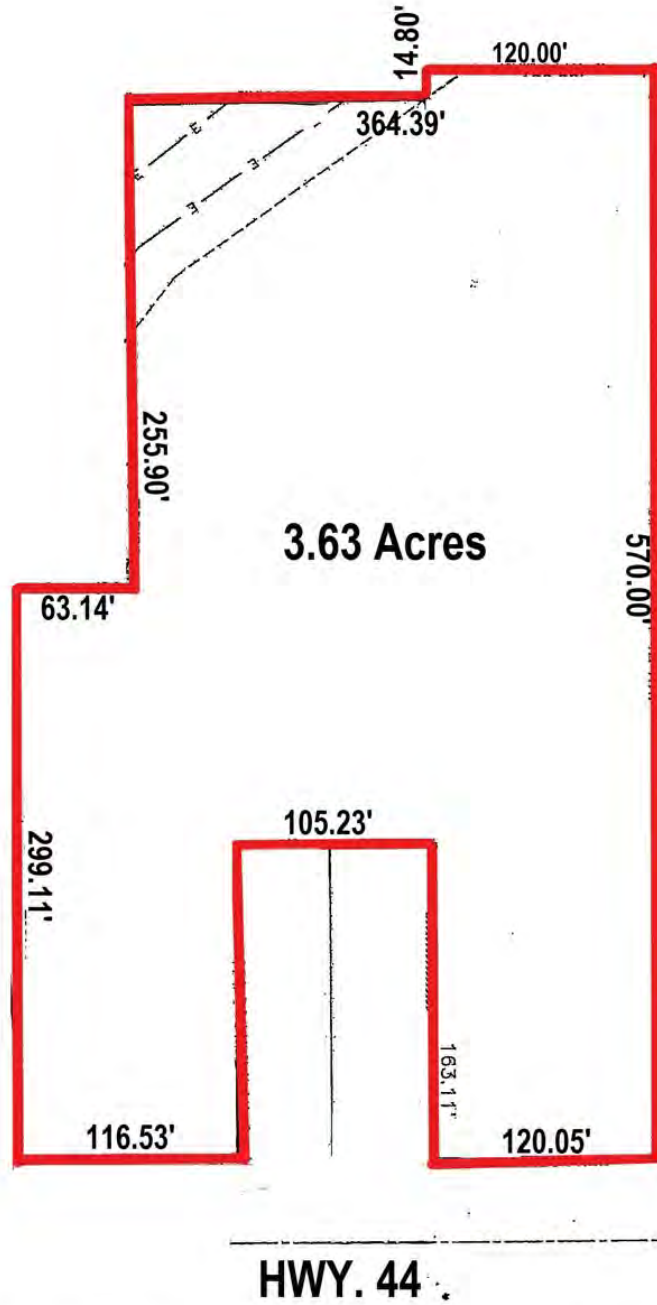

BILL JEANSONNE

Commercial Investment Specialist
(D)225.802.2932
bill@sr-cre.com

DON HANNA

Commercial Sales & Leasing
(D)225.802.5450
don@sr-cre.com

SAURAGE ROTENBERG COMMERCIAL REAL ESTATE, LLC

5135 Bluebonnet Boulevard
Baton Rouge, LA 70809
225.766.0000 | sauragerotenberg.com

The information contained herein has either been given to us by property owners or is from sources deemed reliable and is believed to be correct, it is not in any way warranted or guaranteed by Saurage Rotenberg Commercial Real Estate. This information is submitted subject to errors, omissions, changes in price, rental or other conditions, withdrawal without notice, and to any special listing conditions imposed by the principals. Licensed in Louisiana & Mississippi.



SAURAGE ROTENBERG™
COMMERCIAL REAL ESTATE

RETAIL MAP

HWY. 44 DEVELOPMENT

HWY. 44, GONZALES, LA 70737

+/- 3.63 ACRES

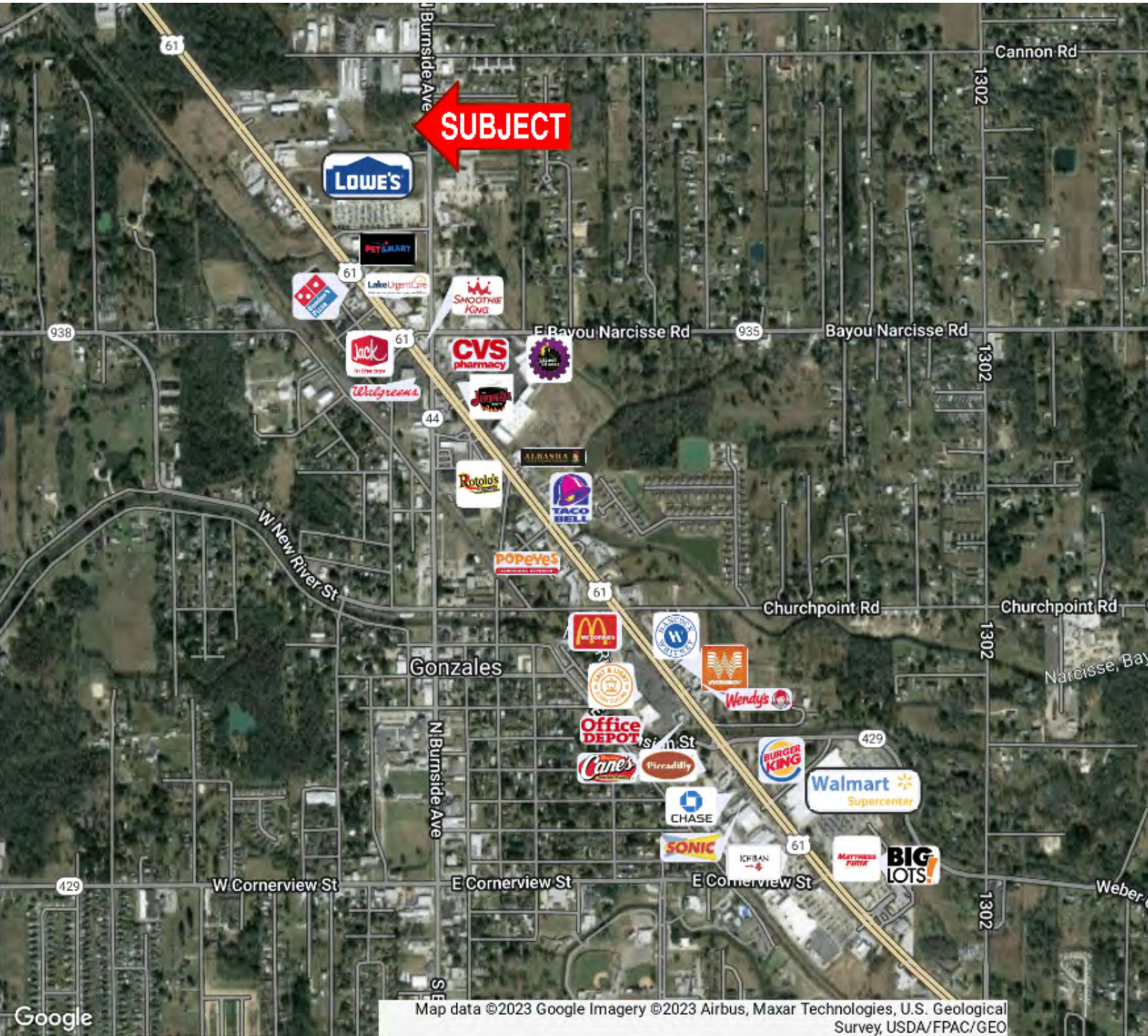

Map data ©2023 Google Imagery ©2023 Airbus, Maxar Technologies, U.S. Geological Survey, USDA/FPAC/GEO

BILL JEANSONNE

Commercial Investment Specialist
(D)225.802.2932
bill@sr-cre.com

DON HANNA

Commercial Sales & Leasing
(D)225.802.5450
don@sr-cre.com

SAURAGE ROTENBERG COMMERCIAL REAL ESTATE, LLC

5135 Bluebonnet Boulevard
Baton Rouge, LA 70809
225.766.0000 | sauragerotenberg.com

The information contained herein has either been given to us by property owners or is from sources deemed reliable and is believed to be correct, it is not in any way warranted or guaranteed by Saurage Rotenberg Commercial Real Estate. This information is submitted subject to errors, omissions, changes in price, rental or other conditions, withdrawal without notice, and to any special listing conditions imposed by the principals. Licensed in Louisiana & Mississippi.



SAURAGE ROTENBERG™
COMMERCIAL REAL ESTATE

TRAFFIC COUNT MAP HWY. 44 DEVELOPMENT

HWY. 44, GONZALES, LA 70737

+/- 3.63 ACRES

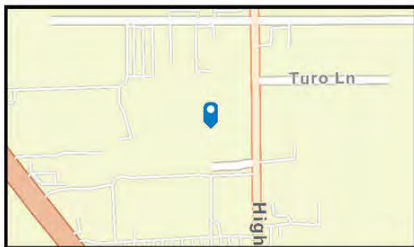
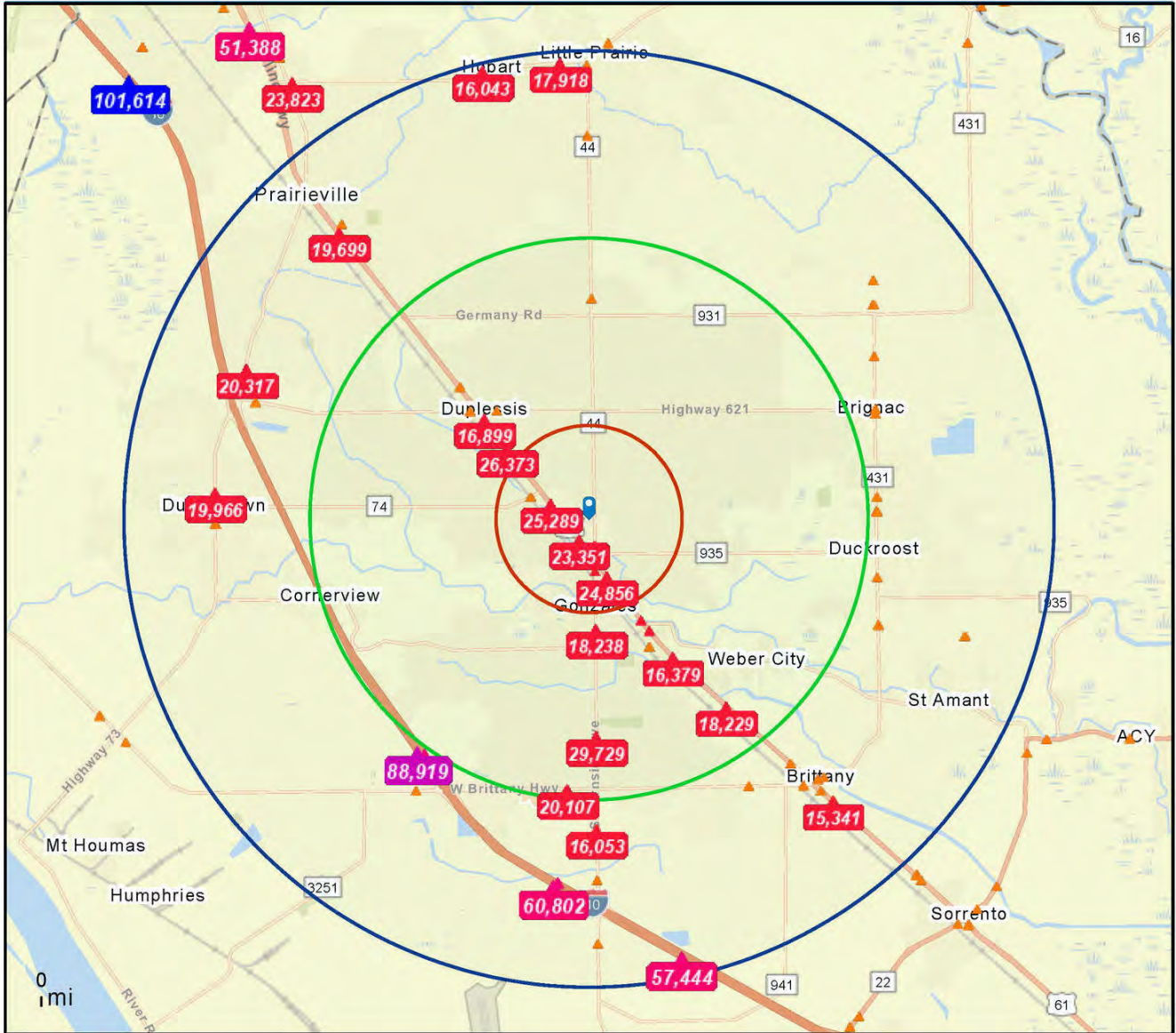

- Average Daily Traffic Volume**
- ▲ Up to 6,000 vehicles per day
 - ▲ 6,001 - 15,000
 - ▲ 15,001 - 30,000
 - ▲ 30,001 - 50,000
 - ▲ 50,001 - 100,000
 - ▲ More than 100,000 per day



Source: ©2023 Kalibrate Technologies (Q3 2023).

BILL JEANSONNE
Commercial Investment Specialist
(D)225.802.2932
bill@sr-cre.com

DON HANNA
Commercial Sales & Leasing
(D)225.802.5450
don@sr-cre.com

SAURAGE ROTENBERG COMMERCIAL REAL ESTATE, LLC
5135 Bluebonnet Boulevard
Baton Rouge, LA 70809
225.766.0000 | sauragerotenberg.com

The information contained herein has either been given to us by property owners or is from sources deemed reliable and is believed to be correct, it is not in any way warranted or guaranteed by Saurage Rotenberg Commercial Real Estate. This information is submitted subject to errors, omissions, changes in price, rental or other conditions, withdrawal without notice, and to any special listing conditions imposed by the principals. Licensed in Louisiana & Mississippi.



SAURAGE ROTENBERG™
COMMERCIAL REAL ESTATE

DRIVE TIME MAP: 5, 10, 15 MINUTES HWY. 44 DEVELOPMENT

HWY. 44, GONZALES, LA 70737

+/- 3.63 ACRES

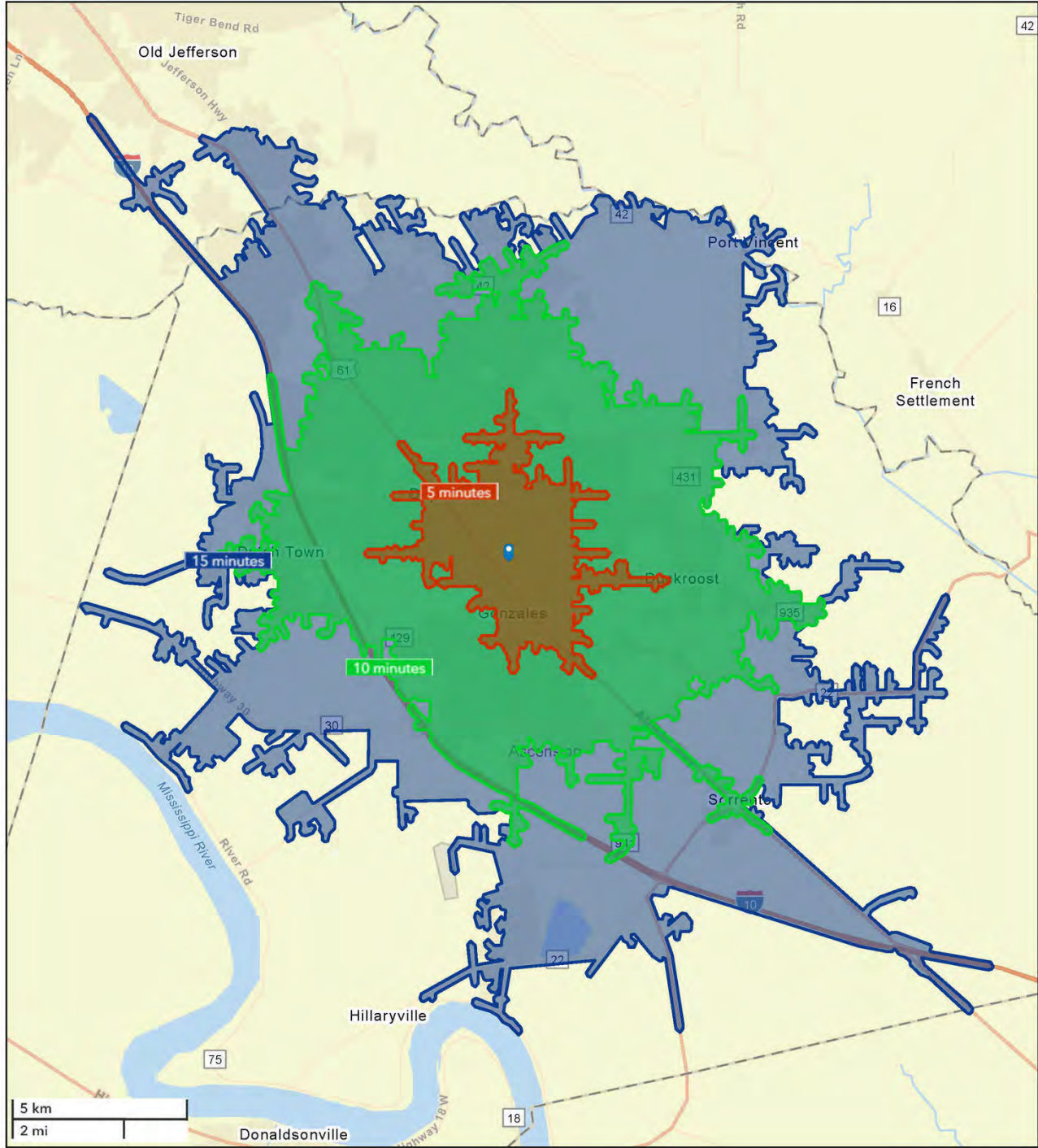

December 01, 2023

BILL JEANSONNE

Commercial Investment Specialist
(D)225.802.2932
bill@sr-cre.com

DON HANNA

Commercial Sales & Leasing
(D)225.802.5450
don@sr-cre.com

SAURAGE ROTENBERG COMMERCIAL REAL ESTATE, LLC

5135 Bluebonnet Boulevard
Baton Rouge, LA 70809
225.766.0000 | sauragerotenberg.com

The information contained herein has either been given to us by property owners or is from sources deemed reliable and is believed to be correct, it is not in any way warranted or guaranteed by Saurage Rotenberg Commercial Real Estate. This information is submitted subject to errors, omissions, changes in price, rental or other conditions, withdrawal without notice, and to any special listing conditions imposed by the principals. Licensed in Louisiana & Mississippi.



SAURAGE ROTENBERG™
COMMERCIAL REAL ESTATE

DEMOGRAPHICS - 1 MILE RADIUS
HWY. 44 DEVELOPMENT
HWY. 44, GONZALES, LA 70737

+/- 3.63 ACRES



Demographic and Income Profile

12449 Highway 44, Gonzales, Louisiana, 70737
Ring: 1 mile radius

Prepared by Esri
Latitude: 30.35703
Longitude: -90.92188

| Summary | Census 2010 | Census 2020 | 2023 | 2028 | | | | |
|--------------------------------------|--------------------|--------------------|-----------------|-------------|---------|-------------|--------|---------|
| Population | 2,974 | 3,218 | 3,266 | 3,321 | | | | |
| Households | 1,114 | 1,243 | 1,273 | 1,304 | | | | |
| Families | 761 | 807 | 832 | 848 | | | | |
| Average Household Size | 2.66 | 2.58 | 2.56 | 2.54 | | | | |
| Owner Occupied Housing Units | 711 | 756 | 884 | 917 | | | | |
| Renter Occupied Housing Units | 402 | 487 | 389 | 387 | | | | |
| Median Age | 34.7 | 36.8 | 37.4 | 38.8 | | | | |
| Trends: 2023-2028 Annual Rate | Area | State | National | | | | | |
| Population | 0.33% | -0.02% | 0.30% | | | | | |
| Households | 0.48% | 0.18% | 0.49% | | | | | |
| Families | 0.38% | 0.08% | 0.44% | | | | | |
| Owner HHs | 0.74% | 0.36% | 0.66% | | | | | |
| Median Household Income | 1.81% | 2.08% | 2.57% | | | | | |
| Households by Income | | 2023 | 2028 | | | | | |
| | | Number | Percent | Number | Percent | | | |
| <\$15,000 | | 45 | 3.5% | 40 | 3.1% | | | |
| \$15,000 - \$24,999 | | 72 | 5.7% | 59 | 4.5% | | | |
| \$25,000 - \$34,999 | | 174 | 13.7% | 157 | 12.0% | | | |
| \$35,000 - \$49,999 | | 282 | 22.2% | 267 | 20.5% | | | |
| \$50,000 - \$74,999 | | 265 | 20.8% | 272 | 20.9% | | | |
| \$75,000 - \$99,999 | | 144 | 11.3% | 162 | 12.4% | | | |
| \$100,000 - \$149,999 | | 190 | 14.9% | 214 | 16.4% | | | |
| \$150,000 - \$199,999 | | 77 | 6.0% | 106 | 8.1% | | | |
| \$200,000+ | | 23 | 1.8% | 26 | 2.0% | | | |
| Median Household Income | | \$54,184 | | \$59,278 | | | | |
| Average Household Income | | \$75,019 | | \$83,693 | | | | |
| Per Capita Income | | \$29,963 | | \$33,654 | | | | |
| Population by Age | Census 2010 | Census 2020 | | 2023 | | 2028 | | |
| | Number | Percent | Number | Percent | Number | Percent | Number | Percent |
| 0 - 4 | 226 | 7.6% | 228 | 7.1% | 217 | 6.6% | 216 | 6.5% |
| 5 - 9 | 199 | 6.7% | 216 | 6.7% | 221 | 6.8% | 223 | 6.7% |
| 10 - 14 | 195 | 6.6% | 229 | 7.1% | 198 | 6.1% | 229 | 6.9% |
| 15 - 19 | 202 | 6.8% | 216 | 6.7% | 199 | 6.1% | 190 | 5.7% |
| 20 - 24 | 219 | 7.4% | 185 | 5.7% | 181 | 5.5% | 192 | 5.8% |
| 25 - 34 | 459 | 15.4% | 459 | 14.3% | 497 | 15.2% | 426 | 12.8% |
| 35 - 44 | 372 | 12.5% | 417 | 13.0% | 467 | 14.3% | 494 | 14.9% |
| 45 - 54 | 464 | 15.6% | 377 | 11.7% | 367 | 11.2% | 387 | 11.7% |
| 55 - 64 | 325 | 10.9% | 445 | 13.8% | 435 | 13.3% | 403 | 12.1% |
| 65 - 74 | 185 | 6.2% | 269 | 8.4% | 310 | 9.5% | 351 | 10.6% |
| 75 - 84 | 97 | 3.3% | 140 | 4.4% | 141 | 4.3% | 167 | 5.0% |
| 85+ | 31 | 1.0% | 36 | 1.1% | 33 | 1.0% | 42 | 1.3% |
| Race and Ethnicity | Census 2010 | Census 2020 | | 2023 | | 2028 | | |
| | Number | Percent | Number | Percent | Number | Percent | Number | Percent |
| White Alone | 2,126 | 71.5% | 1,889 | 58.7% | 1,897 | 58.1% | 1,870 | 56.3% |
| Black Alone | 649 | 21.8% | 855 | 26.6% | 862 | 26.4% | 893 | 26.9% |
| American Indian Alone | 15 | 0.5% | 15 | 0.5% | 15 | 0.5% | 15 | 0.5% |
| Asian Alone | 10 | 0.3% | 17 | 0.5% | 17 | 0.5% | 19 | 0.6% |
| Pacific Islander Alone | 0 | 0.0% | 1 | 0.0% | 1 | 0.0% | 1 | 0.0% |
| Some Other Race Alone | 125 | 4.2% | 233 | 7.2% | 252 | 7.7% | 278 | 8.4% |
| Two or More Races | 50 | 1.7% | 208 | 6.5% | 223 | 6.8% | 245 | 7.4% |
| Hispanic Origin (Any Race) | 255 | 8.6% | 393 | 12.2% | 426 | 13.0% | 467 | 14.1% |

Data Note: Income is expressed in current dollars.

Source: Esri forecasts for 2023 and 2028. U.S. Census Bureau, 2020 decennial Census in 2020 geographies.

December 01, 2023

BILL JEANSONNE
Commercial Investment Specialist
(D)225.802.2932
bill@sr-cre.com

DON HANNA
Commercial Sales & Leasing
(D)225.802.5450
don@sr-cre.com

SAURAGE ROTENBERG COMMERCIAL REAL ESTATE, LLC
5135 Bluebonnet Boulevard
Baton Rouge, LA 70809
225.766.0000 | sauragerotenberg.com

The information contained herein has either been given to us by property owners or is from sources deemed reliable and is believed to be correct, it is not in any way warranted or guaranteed by Saurage Rotenberg Commercial Real Estate. This information is submitted subject to errors, omissions, changes in price, rental or other conditions, withdrawal without notice, and to any special listing conditions imposed by the principals. Licensed in Louisiana & Mississippi.



SAURAGE ROTENBERG™
COMMERCIAL REAL ESTATE

DEMOGRAPHICS - 1 MILE RADIUS
HWY. 44 DEVELOPMENT
HWY. 44, GONZALES, LA 70737

+/- 3.63 ACRES



Demographic and Income Profile

12449 Highway 44, Gonzales, Louisiana, 70737
Ring: 1 mile radius

Prepared by Esri
Latitude: 30.25273
Longitude: -90.93186

Trends 2023-2028

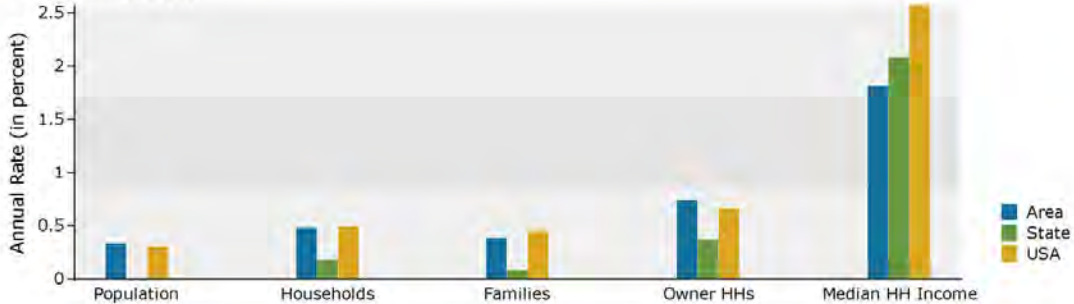

Population by Age

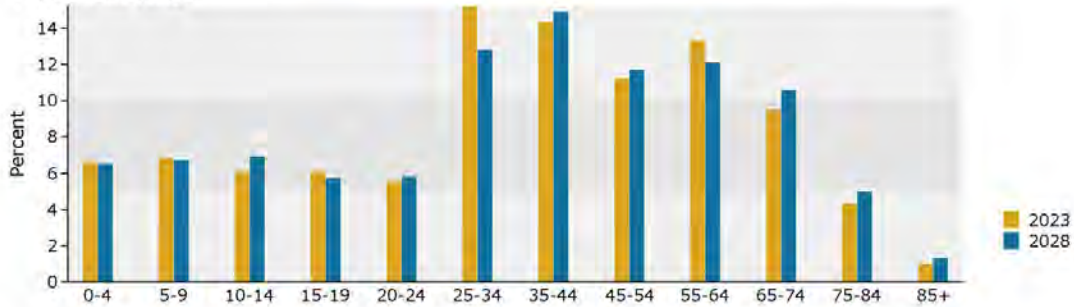

2023 Household Income

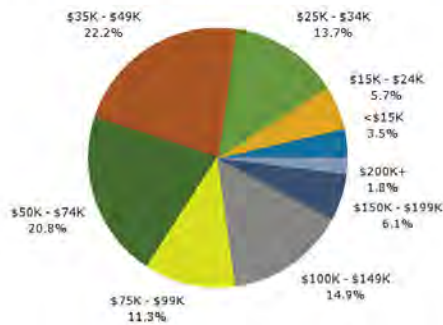

2023 Population by Race

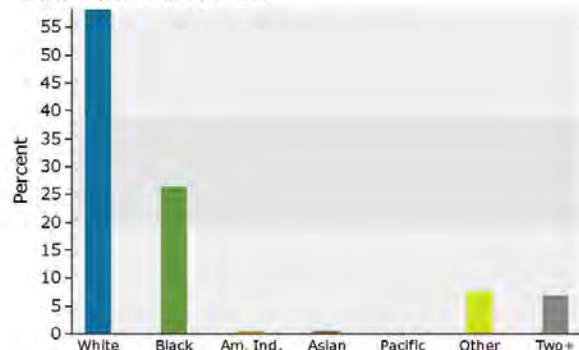

2023 Percent Hispanic Origin: 13.0%

Source: Esri forecasts for 2023 and 2028. U.S. Census Bureau 2020 decennial Census in 2020 geographies.

December 01, 2023

BILL JEANSONNE
Commercial Investment Specialist
(D)225.802.2932
bill@sr-cre.com

DON HANNA
Commercial Sales & Leasing
(D)225.802.5450
don@sr-cre.com

SAURAGE ROTENBERG COMMERCIAL REAL ESTATE, LLC
5135 Bluebonnet Boulevard
Baton Rouge, LA 70809
225.766.0000 | sauragerotenberg.com

The information contained herein has either been given to us by property owners or is from sources deemed reliable and is believed to be correct, it is not in any way warranted or guaranteed by Saurage Rotenberg Commercial Real Estate. This information is submitted subject to errors, omissions, changes in price, rental or other conditions, withdrawal without notice, and to any special listing conditions imposed by the principals. Licensed in Louisiana & Mississippi.



SAURAGE ROTENBERG™
COMMERCIAL REAL ESTATE

DEMOGRAPHICS - 3 MILE RADIUS
HWY. 44 DEVELOPMENT
HWY. 44, GONZALES, LA 70737

+/- 3.63 ACRES



Demographic and Income Profile

12449 Highway 44, Gonzales, Louisiana, 70737
Ring: 3 mile radius

Prepared by Esri
Latitude: 30.75273
Longitude: -90.52106

| Summary | Census 2010 | Census 2020 | 2023 | 2028 | | | | |
|--------------------------------------|--------------------|--------------|--------------------|---------|-------------|---------|-------------|---------|
| Population | 30,157 | 37,145 | 38,786 | 40,065 | | | | |
| Households | 11,112 | 14,091 | 14,808 | 15,413 | | | | |
| Families | 8,099 | 9,758 | 10,370 | 10,743 | | | | |
| Average Household Size | 2.70 | 2.62 | 2.60 | 2.59 | | | | |
| Owner Occupied Housing Units | 8,302 | 10,142 | 10,964 | 11,518 | | | | |
| Renter Occupied Housing Units | 2,810 | 3,949 | 3,844 | 3,895 | | | | |
| Median Age | 34.1 | 35.7 | 37.0 | 37.6 | | | | |
| Trends: 2023-2028 Annual Rate | | | | | | | | |
| | Area | State | National | | | | | |
| Population | 0.65% | -0.02% | 0.30% | | | | | |
| Households | 0.80% | 0.18% | 0.49% | | | | | |
| Families | 0.71% | 0.08% | 0.44% | | | | | |
| Owner HHs | 0.99% | 0.36% | 0.66% | | | | | |
| Median Household Income | 2.40% | 2.08% | 2.57% | | | | | |
| Households by Income | | | | | | | | |
| | | 2023 | 2028 | | | | | |
| | | Number | Number | Percent | | | | |
| <\$15,000 | | 519 | 466 | 3.0% | | | | |
| \$15,000 - \$24,999 | | 1,353 | 1,123 | 7.3% | | | | |
| \$25,000 - \$34,999 | | 1,757 | 1,575 | 10.2% | | | | |
| \$35,000 - \$49,999 | | 2,421 | 2,333 | 15.1% | | | | |
| \$50,000 - \$74,999 | | 3,002 | 3,026 | 19.6% | | | | |
| \$75,000 - \$99,999 | | 1,912 | 2,098 | 13.6% | | | | |
| \$100,000 - \$149,999 | | 1,895 | 2,208 | 14.3% | | | | |
| \$150,000 - \$199,999 | | 1,177 | 1,616 | 10.5% | | | | |
| \$200,000+ | | 771 | 970 | 6.3% | | | | |
| Median Household Income | | \$58,803 | \$66,215 | | | | | |
| Average Household Income | | \$86,224 | \$98,678 | | | | | |
| Per Capita Income | | \$32,759 | \$37,772 | | | | | |
| Population by Age | | | | | | | | |
| | Census 2010 | | Census 2020 | | 2023 | | 2028 | |
| | Number | Percent | Number | Percent | Number | Percent | Number | Percent |
| 0 - 4 | 2,326 | 7.7% | 2,513 | 6.8% | 2,592 | 6.7% | 2,702 | 6.7% |
| 5 - 9 | 2,221 | 7.4% | 2,655 | 7.1% | 2,743 | 7.1% | 2,814 | 7.0% |
| 10 - 14 | 2,184 | 7.2% | 2,797 | 7.5% | 2,694 | 6.9% | 2,926 | 7.3% |
| 15 - 19 | 2,134 | 7.1% | 2,553 | 6.9% | 2,348 | 6.1% | 2,487 | 6.2% |
| 20 - 24 | 1,940 | 6.4% | 2,342 | 6.3% | 2,079 | 5.4% | 2,023 | 5.0% |
| 25 - 34 | 4,655 | 15.4% | 5,316 | 14.3% | 5,668 | 14.6% | 5,439 | 13.6% |
| 35 - 44 | 4,168 | 13.8% | 5,200 | 14.0% | 5,860 | 15.1% | 6,279 | 15.7% |
| 45 - 54 | 4,380 | 14.5% | 4,544 | 12.2% | 4,666 | 12.0% | 4,780 | 11.9% |
| 55 - 64 | 3,127 | 10.4% | 4,407 | 11.9% | 4,682 | 12.1% | 4,379 | 10.9% |
| 65 - 74 | 1,777 | 5.9% | 2,976 | 8.0% | 3,446 | 8.9% | 3,774 | 9.4% |
| 75 - 84 | 928 | 3.1% | 1,416 | 3.8% | 1,558 | 4.0% | 1,921 | 4.8% |
| 85+ | 316 | 1.0% | 425 | 1.1% | 449 | 1.2% | 543 | 1.4% |
| Race and Ethnicity | | | | | | | | |
| | Census 2010 | | Census 2020 | | 2023 | | 2028 | |
| | Number | Percent | Number | Percent | Number | Percent | Number | Percent |
| White Alone | 21,596 | 71.6% | 21,548 | 58.0% | 22,076 | 56.9% | 22,142 | 55.3% |
| Black Alone | 6,719 | 22.3% | 10,321 | 27.8% | 10,892 | 28.1% | 11,422 | 28.5% |
| American Indian Alone | 90 | 0.3% | 230 | 0.6% | 254 | 0.7% | 277 | 0.7% |
| Asian Alone | 212 | 0.7% | 304 | 0.8% | 322 | 0.8% | 355 | 0.9% |
| Pacific Islander Alone | 37 | 0.1% | 16 | 0.0% | 17 | 0.0% | 17 | 0.0% |
| Some Other Race Alone | 1,051 | 3.5% | 2,278 | 6.1% | 2,535 | 6.5% | 2,831 | 7.1% |
| Two or More Races | 450 | 1.5% | 2,448 | 6.6% | 2,690 | 6.9% | 3,021 | 7.5% |
| Hispanic Origin (Any Race) | 2,223 | 7.4% | 4,371 | 11.8% | 4,863 | 12.5% | 5,426 | 13.5% |

Data Note: Income is expressed in current dollars.

Source: Esri forecasts for 2023 and 2028. U.S. Census Bureau 2020 decennial Census in 2020 geographies.

December 01, 2023

BILL JEANSONNE
Commercial Investment Specialist
(D)225.802.2932
bill@sr-cre.com

DON HANNA
Commercial Sales & Leasing
(D)225.802.5450
don@sr-cre.com

SAURAGE ROTENBERG COMMERCIAL REAL ESTATE, LLC
5135 Bluebonnet Boulevard
Baton Rouge, LA 70809
225.766.0000 | sauragerotenberg.com

The information contained herein has either been given to us by property owners or is from sources deemed reliable and is believed to be correct, it is not in any way warranted or guaranteed by Saurage Rotenberg Commercial Real Estate. This information is submitted subject to errors, omissions, changes in price, rental or other conditions, withdrawal without notice, and to any special listing conditions imposed by the principals. Licensed in Louisiana & Mississippi.



SAURAGE ROTENBERG™
COMMERCIAL REAL ESTATE

DEMOGRAPHICS - 3 MILE RADIUS HWY. 44 DEVELOPMENT

HWY. 44, GONZALES, LA 70737

+/- 3.63 ACRES



Demographic and Income Profile

12449 Highway 44, Gonzales, Louisiana, 70737
Ring: 3 mile radius

Prepared by Esri
Latitude: 30.25273
Longitude: -90.92106

Trends 2023-2028

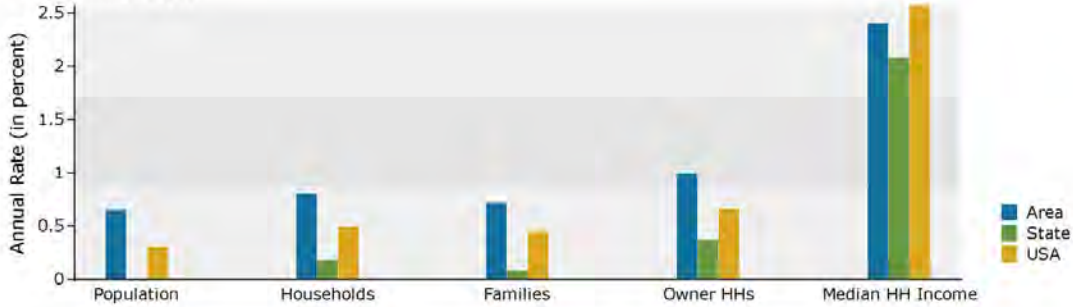

Population by Age

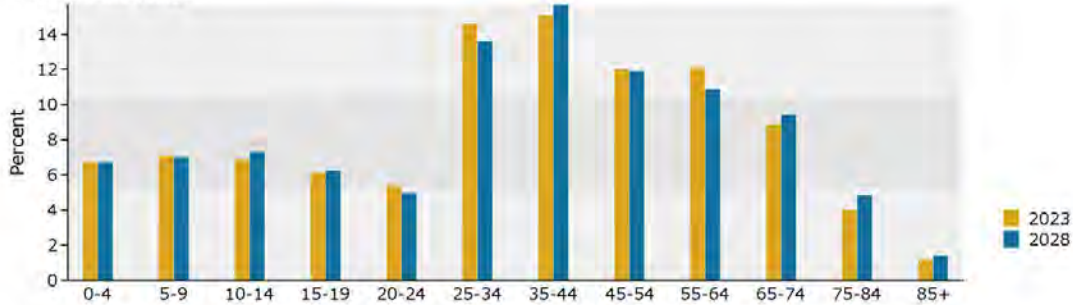

2023 Household Income



2023 Population by Race

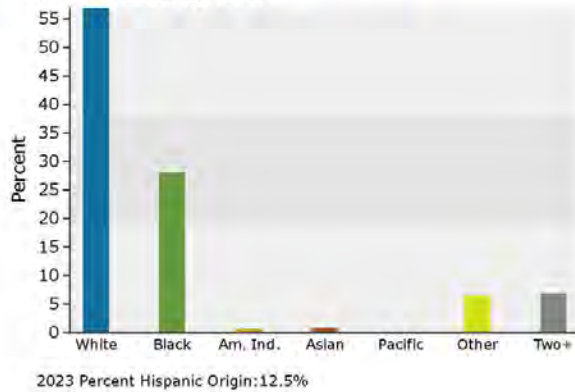

Source: Esri forecasts for 2023 and 2028. U.S. Census Bureau 2020 decennial Census in 2020 geographies.

December 01, 2023

BILL JEANSONNE

Commercial Investment Specialist
(D)225.802.2932
bill@sr-cre.com

DON HANNA

Commercial Sales & Leasing
(D)225.802.5450
don@sr-cre.com

SAURAGE ROTENBERG COMMERCIAL REAL ESTATE, LLC

5135 Bluebonnet Boulevard
Baton Rouge, LA 70809
225.766.0000 | sauragerotenberg.com

The information contained herein has either been given to us by property owners or is from sources deemed reliable and is believed to be correct, it is not in any way warranted or guaranteed by Saurage Rotenberg Commercial Real Estate. This information is submitted subject to errors, omissions, changes in price, rental or other conditions, withdrawal without notice, and to any special listing conditions imposed by the principals. Licensed in Louisiana & Mississippi.



SAURAGE ROTENBERG™
COMMERCIAL REAL ESTATE

DEMOGRAPHICS - 5 MILE RADIUS
HWY. 44 DEVELOPMENT
HWY. 44, GONZALES, LA 70737

+/- 3.63 ACRES



Demographic and Income Profile

12449 Highway 44, Gonzales, Louisiana, 70737
Ring: 5 mile radius

Prepared by Esri
Latitude: 30.35373
Longitude: -90.52105

| Summary | Census 2010 | Census 2020 | 2023 | 2028 |
|--------------------------------------|--------------------|--------------------|-----------------|-------------|
| Population | 69,594 | 83,353 | 86,938 | 90,374 |
| Households | 24,622 | 30,283 | 31,698 | 33,193 |
| Families | 18,898 | 22,389 | 23,537 | 24,544 |
| Average Household Size | 2.82 | 2.75 | 2.74 | 2.72 |
| Owner Occupied Housing Units | 19,803 | 23,911 | 25,593 | 26,879 |
| Renter Occupied Housing Units | 4,823 | 6,372 | 6,105 | 6,314 |
| Median Age | 33.8 | 35.7 | 36.5 | 37.1 |
| Trends: 2023-2028 Annual Rate | Area | State | National | |
| Population | 0.78% | -0.02% | 0.30% | |
| Households | 0.93% | 0.18% | 0.49% | |
| Families | 0.84% | 0.08% | 0.44% | |
| Owner HHs | 0.99% | 0.36% | 0.66% | |
| Median Household Income | 2.35% | 2.08% | 2.57% | |
| Households by Income | | 2023 | 2028 | |
| | | Number | Percent | Number |
| <\$15,000 | | 1,149 | 3.6% | 1,049 |
| \$15,000 - \$24,999 | | 2,195 | 6.9% | 1,829 |
| \$25,000 - \$34,999 | | 3,282 | 10.4% | 2,915 |
| \$35,000 - \$49,999 | | 4,178 | 13.2% | 3,957 |
| \$50,000 - \$74,999 | | 5,552 | 17.5% | 5,501 |
| \$75,000 - \$99,999 | | 4,427 | 14.0% | 4,731 |
| \$100,000 - \$149,999 | | 4,429 | 14.0% | 4,953 |
| \$150,000 - \$199,999 | | 4,130 | 13.0% | 5,434 |
| \$200,000+ | | 2,356 | 7.4% | 2,823 |
| Median Household Income | | \$71,866 | | \$80,699 |
| Average Household Income | | \$100,724 | | \$113,905 |
| Per Capita Income | | \$36,795 | | \$41,928 |
| Population by Age | Census 2010 | Census 2020 | 2023 | 2028 |
| | Number | Percent | Number | Percent |
| 0 - 4 | 5,468 | 7.9% | 5,686 | 6.8% |
| 5 - 9 | 5,655 | 8.1% | 6,351 | 7.6% |
| 10 - 14 | 5,623 | 8.1% | 6,905 | 8.3% |
| 15 - 19 | 5,102 | 7.3% | 6,037 | 7.2% |
| 20 - 24 | 4,062 | 5.8% | 4,685 | 5.6% |
| 25 - 34 | 10,133 | 14.6% | 11,104 | 13.3% |
| 35 - 44 | 10,794 | 15.5% | 12,237 | 14.7% |
| 45 - 54 | 9,973 | 14.3% | 10,785 | 12.9% |
| 55 - 64 | 6,969 | 10.0% | 9,532 | 11.4% |
| 65 - 74 | 3,611 | 5.2% | 6,395 | 7.7% |
| 75 - 84 | 1,668 | 2.4% | 2,862 | 3.4% |
| 85+ | 536 | 0.8% | 774 | 0.9% |
| Race and Ethnicity | Census 2010 | Census 2020 | 2023 | 2028 |
| | Number | Percent | Number | Percent |
| White Alone | 53,844 | 77.4% | 54,919 | 65.9% |
| Black Alone | 12,306 | 17.7% | 17,810 | 21.4% |
| American Indian Alone | 225 | 0.3% | 399 | 0.5% |
| Asian Alone | 612 | 0.9% | 1,006 | 1.2% |
| Pacific Islander Alone | 68 | 0.1% | 23 | 0.0% |
| Some Other Race Alone | 1,588 | 2.3% | 3,662 | 4.4% |
| Two or More Races | 951 | 1.4% | 5,533 | 6.6% |
| Hispanic Origin (Any Race) | 3,751 | 5.4% | 7,747 | 9.3% |

Data Note: Income is expressed in current dollars.

Source: Esri forecasts for 2023 and 2028. U.S. Census Bureau 2020 decennial Census in 2020 geographies.

December 01, 2023

BILL JEANSONNE
Commercial Investment Specialist
(D)225.802.2932
bill@sr-cre.com

DON HANNA
Commercial Sales & Leasing
(D)225.802.5450
don@sr-cre.com

SAURAGE ROTENBERG COMMERCIAL REAL ESTATE, LLC
5135 Bluebonnet Boulevard
Baton Rouge, LA 70809
225.766.0000 | sauragerotenberg.com

The information contained herein has either been given to us by property owners or is from sources deemed reliable and is believed to be correct, it is not in any way warranted or guaranteed by Saurage Rotenberg Commercial Real Estate. This information is submitted subject to errors, omissions, changes in price, rental or other conditions, withdrawal without notice, and to any special listing conditions imposed by the principals. Licensed in Louisiana & Mississippi.



SAURAGE ROTENBERG™
COMMERCIAL REAL ESTATE

DEMOGRAPHICS - 5 MILE RADIUS
HWY. 44 DEVELOPMENT
HWY. 44, GONZALES, LA 70737

+/- 3.63 ACRES



Demographic and Income Profile

12449 Highway 44, Gonzales, Louisiana, 70737
Ring: 5 mile radius

Prepared by Esri
Latitude: 30.25273
Longitude: -90.92188

Trends 2023-2028

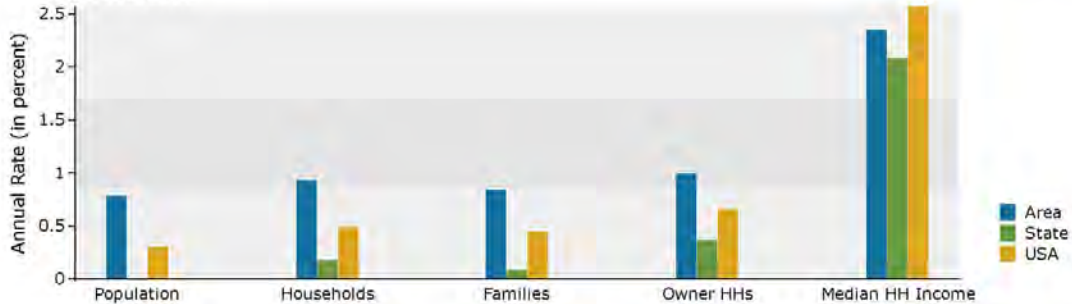

Population by Age

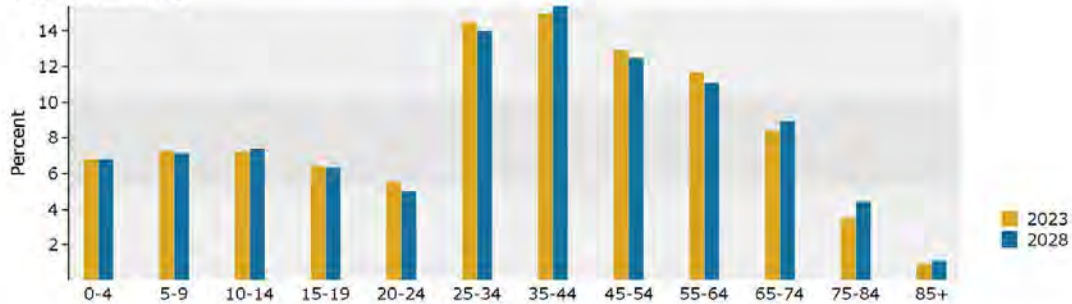

2023 Household Income

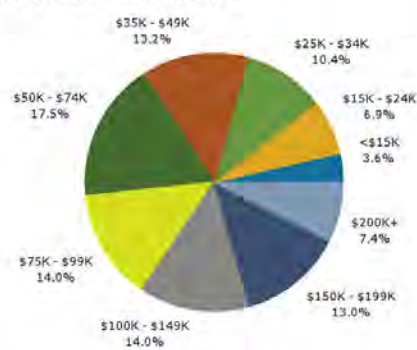

2023 Population by Race

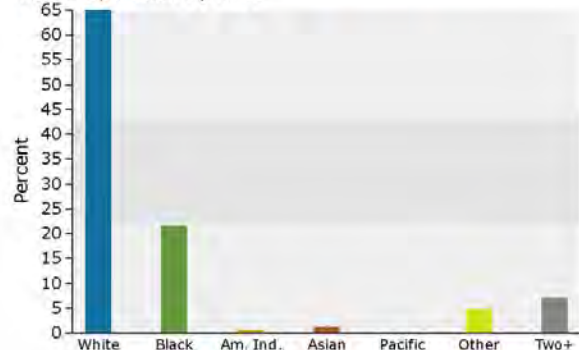

2023 Percent Hispanic Origin: 10.0%

Source: Esri forecasts for 2023 and 2028. U.S. Census Bureau 2020 decennial Census in 2020 geographies.

December 01, 2023

BILL JEANSONNE

Commercial Investment Specialist
(D)225.802.2932
bill@sr-cre.com

DON HANNA

Commercial Sales & Leasing
(D)225.802.5450
don@sr-cre.com

SAURAGE ROTENBERG COMMERCIAL REAL ESTATE, LLC

5135 Bluebonnet Boulevard
Baton Rouge, LA 70809
225.766.0000 | sauragerotenberg.com

The information contained herein has either been given to us by property owners or is from sources deemed reliable and is believed to be correct, it is not in any way warranted or guaranteed by Saurage Rotenberg Commercial Real Estate. This information is submitted subject to errors, omissions, changes in price, rental or other conditions, withdrawal without notice, and to any special listing conditions imposed by the principals. Licensed in Louisiana & Mississippi.



SAURAGE ROTENBERG™
COMMERCIAL REAL ESTATE

DEMOGRAPHIC SUMMARY: 1,3,5 MILES RADII
HWY. 44 DEVELOPMENT

HWY. 44, GONZALES, LA 70737

+/- 3.63 ACRES

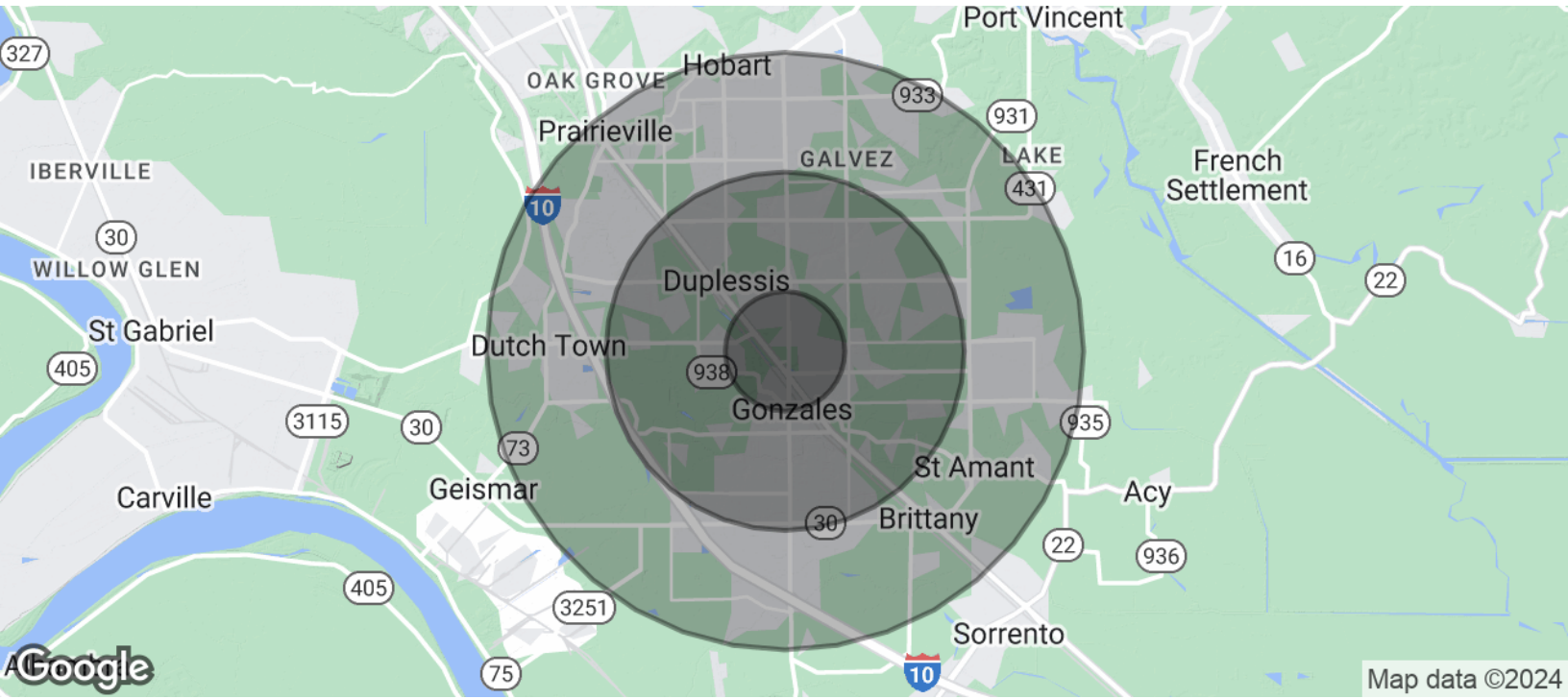

| POPULATION | 1 MILE | 3 MILES | 5 MILES |
|--------------------------------|---------------|----------------|----------------|
| Total Population | 3,097 | 33,625 | 76,128 |
| Average Age | 39.1 | 36.4 | 36.9 |
| Average Age (Male) | 37.9 | 34.9 | 35.6 |
| Average Age (Female) | 41.0 | 37.4 | 37.9 |
| HOUSEHOLDS & INCOME | 1 MILE | 3 MILES | 5 MILES |
| Total Households | 1,428 | 13,884 | 30,315 |
| # Of Persons Per HH | 2.2 | 2.4 | 2.5 |
| Average HH Income | \$69,857 | \$78,525 | \$91,506 |
| Average House Value | \$223,420 | \$208,859 | \$230,858 |

* Demographic data derived from 2020 ACS - US Census

BILL JEANSONNE
Commercial Investment Specialist
(D)225.802.2932
bill@sr-cre.com

DON HANNA
Commercial Sales & Leasing
(D)225.802.5450
don@sr-cre.com

SAURAGE ROTENBERG COMMERCIAL REAL ESTATE, LLC
5135 Bluebonnet Boulevard
Baton Rouge, LA 70809
225.766.0000 | sauragerotenberg.com

The information contained herein has either been given to us by property owners or is from sources deemed reliable and is believed to be correct, it is not in any way warranted or guaranteed by Saurage Rotenberg Commercial Real Estate. This information is submitted subject to errors, omissions, changes in price, rental or other conditions, withdrawal without notice, and to any special listing conditions imposed by the principals. Licensed in Louisiana & Mississippi.