

66

# East Walton Avenue



STREET  
CLEANING  
NO PARKING  
7AM - 1PM  
TUESDAYS  
APRIL 1 - OCT 31  
TOW ZONE

**PINK**  
SHIRTMAKER  
LONDON

**PINK**

**PINK**

**PINK**

BRANDY MELVILLE

eskandar

eskandar

#alifeinthepink

PINK SIGNATURE.





## 66 East Walton, Situated Between North Rush Street And North Michigan Avenue

sits amongst the worlds most exclusive luxury retailers, restaurants and hotels. This 2,285 SF retail gem is located directly across the street from the 900 North Michigan Shops and steps from renowned brands including Gucci, Dior, Versace and Tesla.



# Space Details

## LOCATION

North block between North Rush Street and North Michigan Avenue

## SPACE

Ground Floor: 2,285 SF

Lower Level: 1,500 SF (storage)

## CEILING HEIGHT

Ground Floor: 11 FT

## FRONTAGE

25 FT on East Walton Street

## NEIGHBORS

AllSaints, Aritzia, Barbour, Bloomingdales, Church's English Shoes, Dior, Eskandar, Icebreaker, lululemon athletica, Patagonia, Saint Laurent, Sprinkles, Swiss Fine Timing, Tesla, The Real Real, Versace, Reformation and Stadium Goods

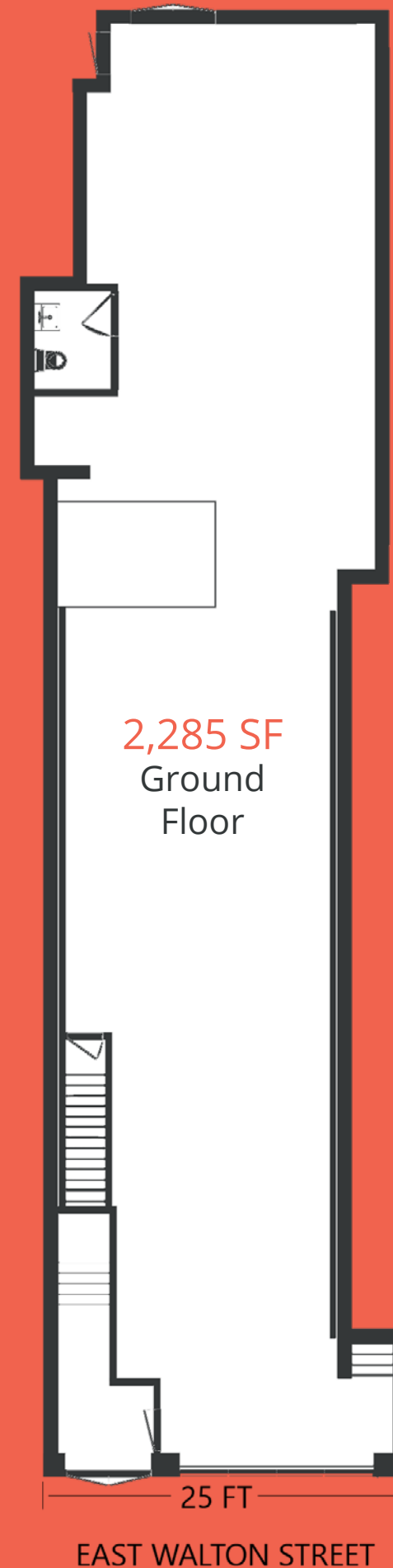



# Location

**THIS GOLD COAST RETAIL OPPORTUNITY** is within close proximity to Michigan Avenue. There are over ten hotels within a three block radius, including the Waldorf Astoria, The Drake, The Ritz-Carlton, The Thompson, Four Seasons and The Viceroy. Within a ½ mile radius there is a residential population of 35,844 and daytime population of 75,279 people.

## FOR MORE INFORMATION CONTACT

**Anthony Campagni**  
[ac@arcgrp.com](mailto:ac@arcgrp.com)  
 (630) 908-5695

**Elan Rasansky**  
[elan@arcgrp.com](mailto:elan@arcgrp.com)  
 (630) 908-5696

**A·R·C REAL ESTATE**  
 A-R-C Real Estate  
 200 S. Wacker Drive, Suite 1325  
 Chicago, IL 60606  
[arcgrp.com](http://arcgrp.com) | 630.908.5700