

1620 Fulton Street Retail/Restaurant Space for Lease

BED-STUY
BROOKLYN, NY

RETAIL

RETAIL

RETAIL

NEWMARK

1620 Fulton Street

Location

South block between Albany and Troy Avenue

Approximate Size

Ground Floor	3,565 SF
Basement	2,275 SF
Total SF	5,840 SF

Ceiling Height

Ground Floor	15 FT
--------------	-------

Frontage

Up to 75 FT

Possession

Immediate

Site Status

New Construction

Neighbors

Super Foodtown, Interfaith Medical Center, Fulton Park, Fine Fare Supermarket, United States Postal Service, Mercy College, Fulton Bikes, Applebee's Grill & Bar, Popeye's, McDonald's, St. Andrew's Playground and Dollar Tree

Comments

Brand new retail space at the base of The Garnet, a 130-unit residential development in historic Bed-Stuy

All uses considered

Easy venting ability for cooking

Ground Floor – Proposed Divisions

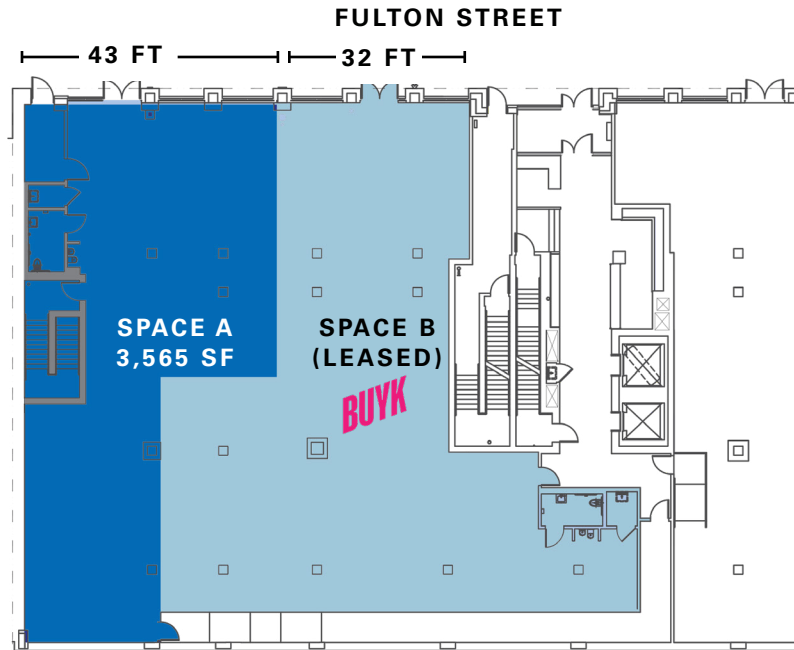

Basement

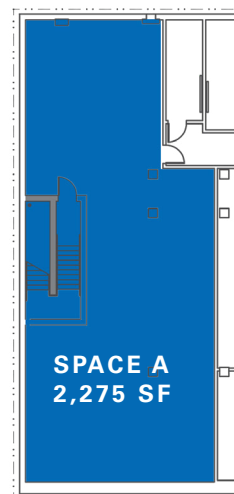

STOREFRONT RENDERINGS AND PHOTOS



AREA MAP



CONTACT

Marc Frankel
 t 212-372-2240
 marc.frankel@nmrk.com

Aric Trakhtenberg
 t 212-916-3386
 aric.trakhtenberg@nmrk.com

Jeffrey D Roseman
 t 212-372-2430
 jeffrey.roseman@nmrk.com

nmrk.com