

FOR LEASE

3713 Pacific Avenue
Tacoma, WA 98418



PACIFIC RETAIL

Blake Weber | Jameson Sullivan | Don Whittles

First Western Properties—Tacoma Inc. | 253.472.0404
6402 Tacoma Mall Blvd, Tacoma, WA 98409 | fwp-inc.com

3713 PACIFIC AVENUE:

SUITE C: 727 SF \$22.00 SF PLUS NNN
($\$7.60$ PSF)

SUITE E: 2,045 SF \$20.00 SF PLUS NNN
($\$7.60$) PSF

- Strip center on busy Pacific Avenue adjacent to Walgreens and other great retailers.
- Ease of Access to I-5, I-705 and SR-16



Population



Average HH Income

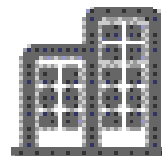

Daytime Population

Regis - 2019

Mile 1	17,333	\$63,631	11,529
Mile 3	118,807	\$67,494	137,575
Mile 5	258,829	\$76,917	238,620



SUITE E



LOCATION AERIAL & SITE PLAN

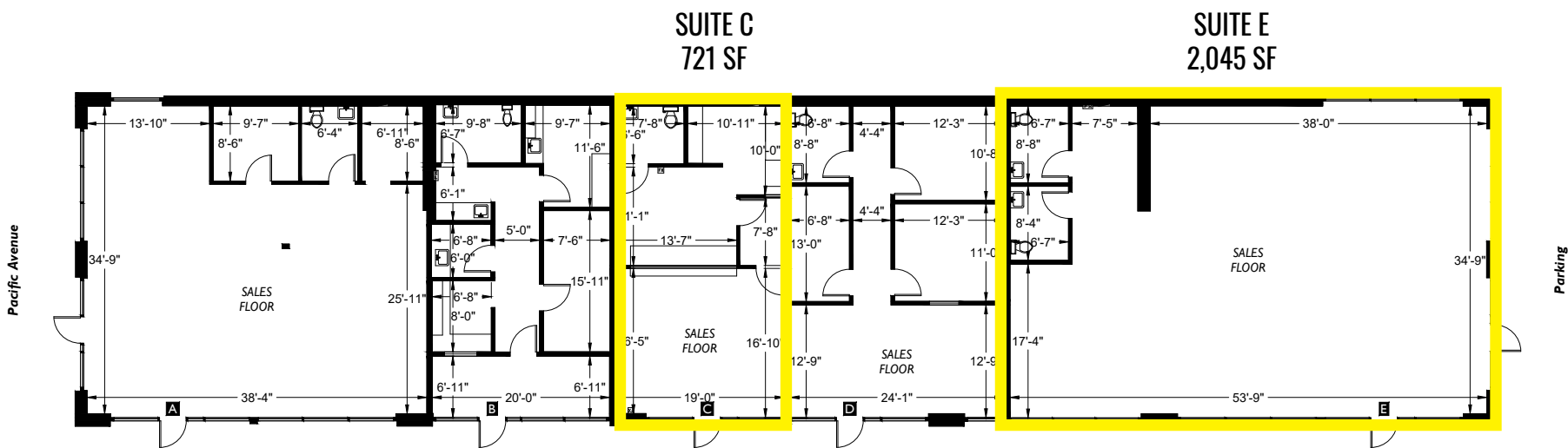
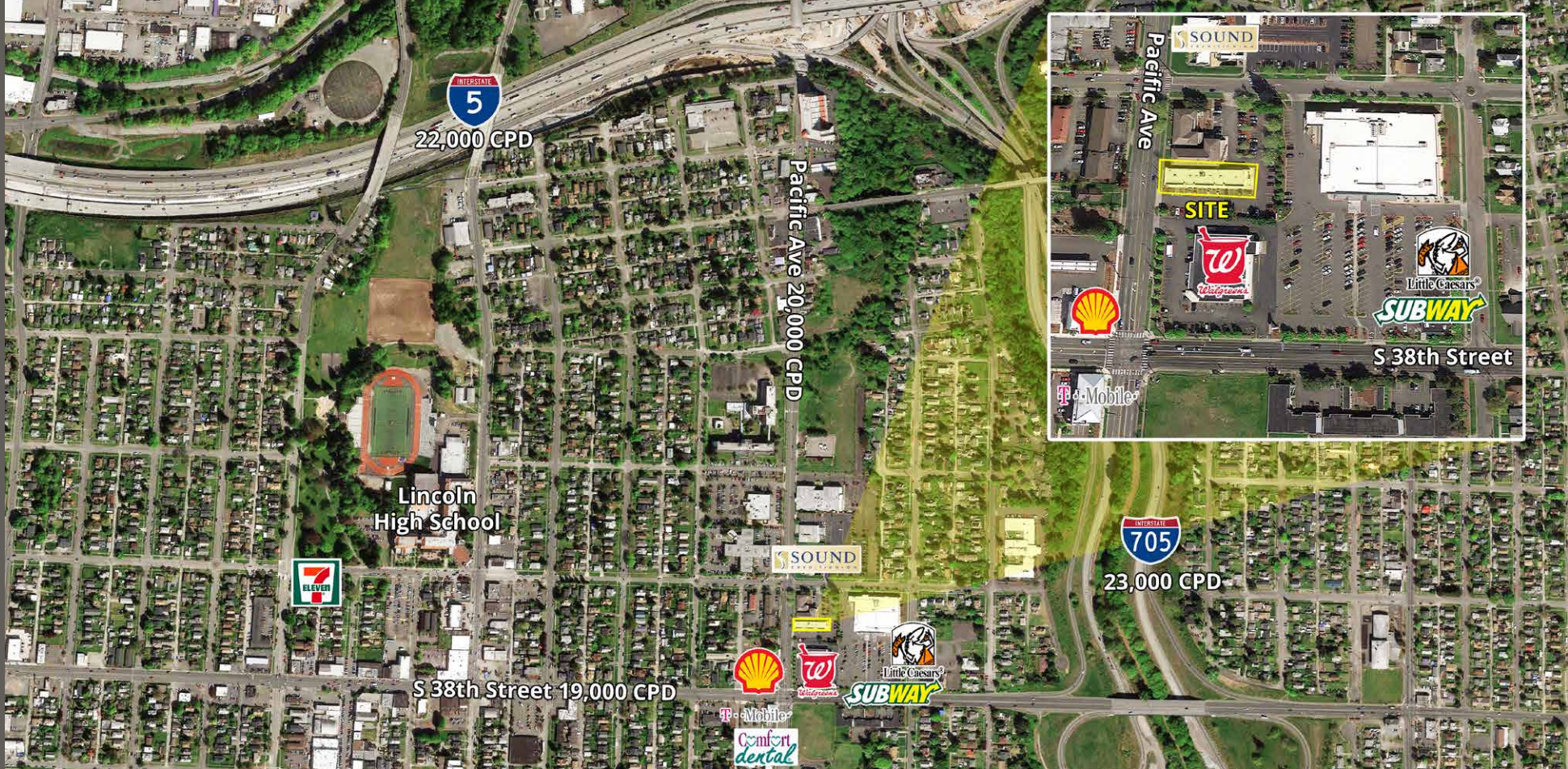

TACOMA | KIRKLAND | PORTLAND | SEATTLE



RETAIL FOCUSED. RESULTS DRIVEN.

BLAKE WEBER

253.284.3646
bweber@firstwesternproperties.com

JAMESON SULLIVAN

253.471.5508
jsullivan@firstwesternproperties.com

DON WHITTLES

253.471.5509
dwhittles@firstwesternproperties.com



First Western Properties—Tacoma Inc. | 253.472.0404
6402 Tacoma Mall Blvd, Tacoma, WA 98409 | fwp-inc.com

© First Western Properties, Inc. DISCLAIMER: The above information has been secured from sources believed to be reliable, however, no representations are made to its accuracy. Prospective tenants or buyers should consult their professional advisors and conduct their own independent investigation. Properties are subject to change in price and/or availability without notice.