



# Pad / Freestanding Drive-Thru Building Available

2170 South Power Road | Mesa, AZ



**Brad Douglass**  
 Director  
 +1 602 224 4406  
 bradley.douglass@cushwake.com

**Mark Bramlett**  
 Managing Director  
 +1 602 224 4492  
 mark.bramlett@cushwake.com

2555 E Camelback Rd Ste 400  
 Phoenix, Arizona 85016  
 ph: +1 602 954 9000  
 fx: +1 602 253 0528  
 cushmanwakefield.com

# Pad / Freestanding Drive-Thru Building Available

2170 South Power Road | Mesa, AZ



**Brad Douglass**  
 Director  
 +1 602 224 4406  
 bradley.douglass@cushwake.com

**Mark Bramlett**  
 Managing Director  
 +1 602 224 4492  
 mark.bramlett@cushwake.com

2555 E Camelback Rd Ste 400  
 Phoenix, Arizona 85016  
 ph: +1 602 954 9000  
 fx: +1 602 253 0528  
 cushmanwakefield.com

# Pad / Freestanding Drive-Thru Building Available

2170 South Power Road | Mesa, AZ

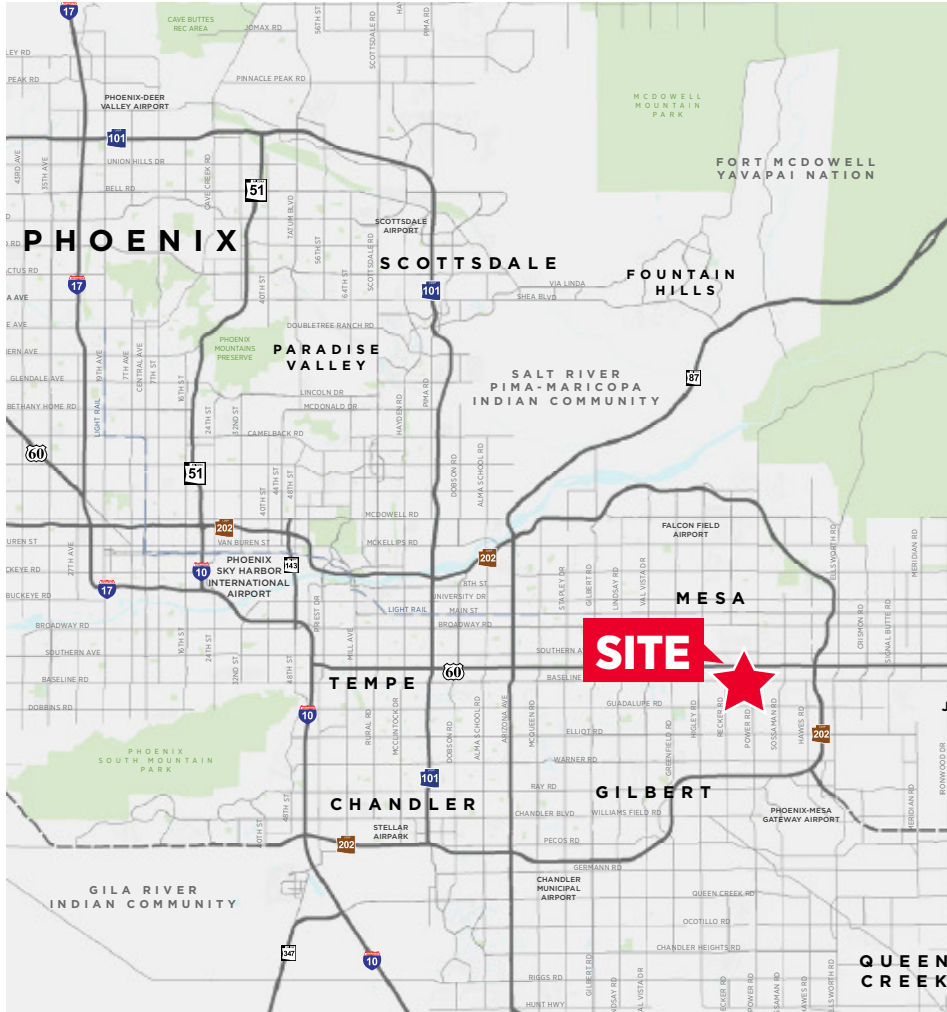

\* Source: ESRI, 2018 \*\* Source: Costar, 2018

## Property Information

Space Available: ±4,680 SF (Demisable)

### Highlights:

- End Cap Drive-Thru Available
- 0.92 Acres (40,001 SF)
- Ample Parking
- Established residential and retail development within submarket
- Call For Rates

### Zoning:

SC, City of Mesa

### Demographics: \*

#### Total Population 2018

1 Mile	3 Miles	5 Miles
12,521	99,516	283,465

#### Daytime Employment 2018

1 Mile	3 Miles	5 Miles
8,490	39,115	77,688

#### Average Household Income 2018

1 Mile	3 Miles	5 Miles
\$79,323	\$75,614	\$77,407

### Traffic Counts: \*\*

Power Rd North of Baseline Rd.:	33,938 VPD
Power Rd South of Baseline Rd.:	30,228 VPD
Baseline Rd East of Power Rd.:	13,404 VPD
Baseline Rd West of Power Rd.:	19,817 VPD
US 60 at Power Rd:	158,511 VPD

**Brad Douglass**  
 Director  
 +1 602 224 4406  
 bradley.douglass@cushwake.com

**Mark Bramlett**  
 Managing Director  
 +1 602 224 4492  
 mark.bramlett@cushwake.com

2555 E Camelback Rd Ste 400  
 Phoenix, Arizona 85016  
 ph: +1 602 954 9000  
 fx: +1 602 253 0528  
 cushmanwakefield.com

# Pad / Freestanding Drive-Thru Building Available

2170 South Power Road | Mesa, AZ



## Site Plan

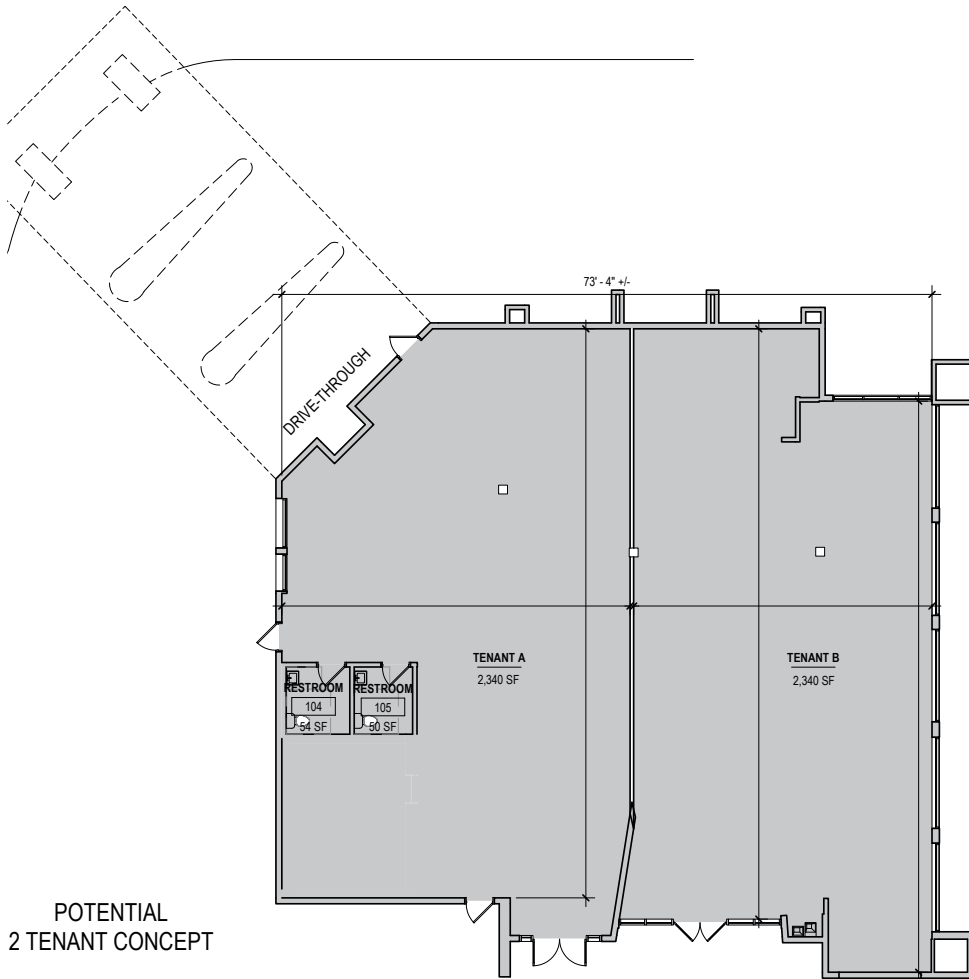

### Brad Douglass

Director  
+1 602 224 4406  
bradley.douglass@cushwake.com

### Mark Bramlett

Managing Director  
+1 602 224 4492  
mark.bramlett@cushwake.com

2555 E Camelback Rd Ste 400  
Phoenix, Arizona 85016  
ph: +1 602 954 9000  
fx: +1 602 253 0528  
cushmanwakefield.com