

# OAKLAND COUNTY AIRPORT

7455 N. ASTRO PARK DR.  
WATERFORD, MICHIGAN

AIRPLANE HANGAR FOR SALE

11,880 Square Feet Available



**SIGNATURE  
ASSOCIATES**  
KNOW SIGNATURE | KNOW RESULTS



## PROPERTY FEATURES

- 11,880 square feet available
- 1,450 square feet of recently refinished office space
- 8' – 26' clear height
- Hangar: 10,430 sq. ft. 19' x 75' door, can fit mid-size jets
- 3,000 gallon Jet A with self-service pump
- Private lobby
- New roof over office area
- Heated cement hangar door entrance
- Maintenance shop
- 30-year ground lease
- Sale price: \$649,000 (\$54.79/sq.ft.)

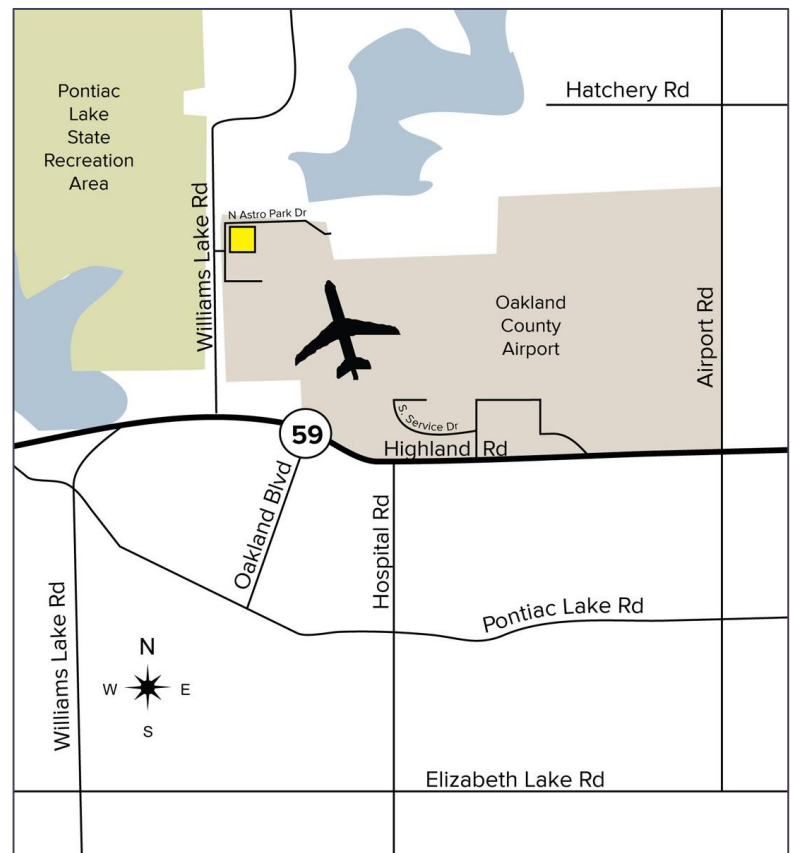

For more information, please contact:

**STEVE GORDON**

(248) 948 0101

sgordon@signatureassociates.com

**MARVIN PETROUS**

(248) 359 0647

mpetrous@signatureassociates.com

**SIGNATURE ASSOCIATES**

One Towne Square, Suite 1200

Southfield, MI 48076

www.signatureassociates.com

# 7455 N. Astro Park Dr. – Waterford, Michigan

## Airport Hangar For Sale

11,880  
Square Feet  
AVAILABLE

### Photos



For more information, please contact:

**STEVE GORDON**

(248) 948 0101

[sgordon@signatureassociates.com](mailto:sgordon@signatureassociates.com)

**MARVIN PETROUS**

(248) 359 0647

[mpetrous@signatureassociates.com](mailto:mpetrous@signatureassociates.com)

**SIGNATURE ASSOCIATES**

One Towne Square, Suite 1200

Southfield, MI 48076

[www.signatureassociates.com](http://www.signatureassociates.com)

# 7455 N. Astro Park Dr. – Waterford, Michigan

## Airport Hangar For Sale

11,880  
Square Feet  
AVAILABLE

### Site Plan

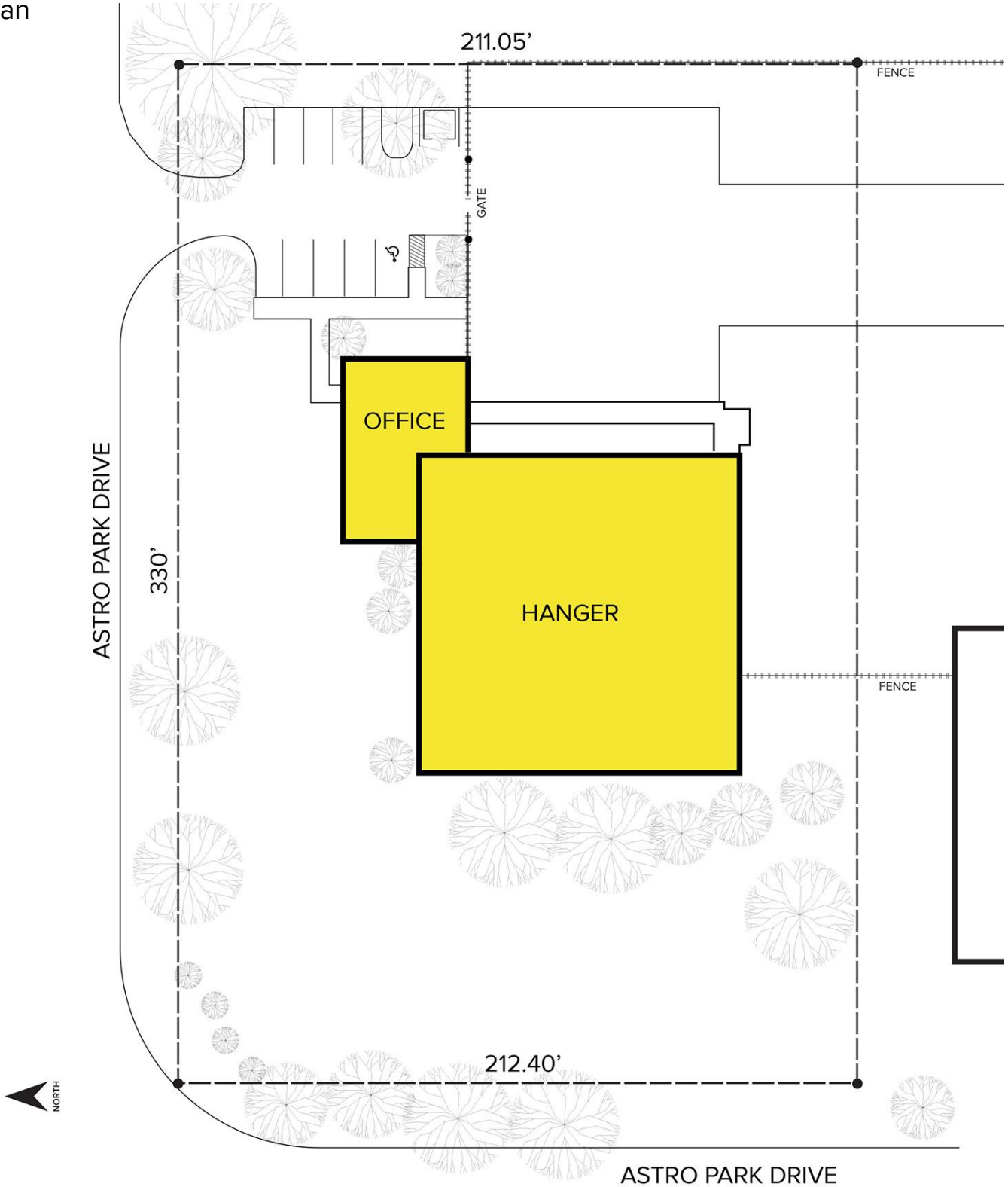

For more information, please contact:

**STEVE GORDON**

(248) 948 0101

sgordon@signatureassociates.com

**MARVIN PETROUS**

(248) 359 0647

mpetrous@signatureassociates.com

**SIGNATURE ASSOCIATES**

One Towne Square, Suite 1200

Southfield, MI 48076

www.signatureassociates.com

# 7455 N. Astro Park Dr. – Waterford, Michigan

## Airport Hangar For Sale

11,880  
Square Feet  
AVAILABLE

### Location



### AIRPORT FEATURES:

- Prime location within the Oakland County International Airport
- Open 24 hours a day
- Paved runways and taxiways
- The airport contributes over \$175 million to the County's economy each year
- Oakland County International Airport ranks as the world's 13<sup>th</sup> busiest general aviation airport averaging approx. 120,000 takeoffs and landings

For more information, please contact:

**STEVE GORDON**  
(248) 948 0101  
sgordon@signatureassociates.com

**MARVIN PETROUS**  
(248) 359 0647  
mpetrous@signatureassociates.com

**SIGNATURE ASSOCIATES**  
One Towne Square, Suite 1200  
Southfield, MI 48076  
www.signatureassociates.com