



Renovated



Coffee



Storefront



Office Spaces



RENTAL RATE

\$16 RSF NNN

Tenant Improvement Allowances Available

SPACE AVAILABLE

1,682 SF

NOW LEASING

THE HISTORIC WHARTON BUILDING

411 W 1st St, Spokane, WA 99201

NEIGHBORHOOD

Located on one of Spokane's most historic blocks, this location is a unique opportunity for one of a kind "main street" experience

AMENITIES

- ✓ 14' ceilings
- ✓ Refrigeration
- ✓ Stove
- ✓ Duct/Hood System

Information is deemed reliable but not guaranteed. Broker not responsible for changes errors or commissions. All square footages are for conveniences only. All information should be verified prior to leasing or purchasing property.



FLOOR PLAN

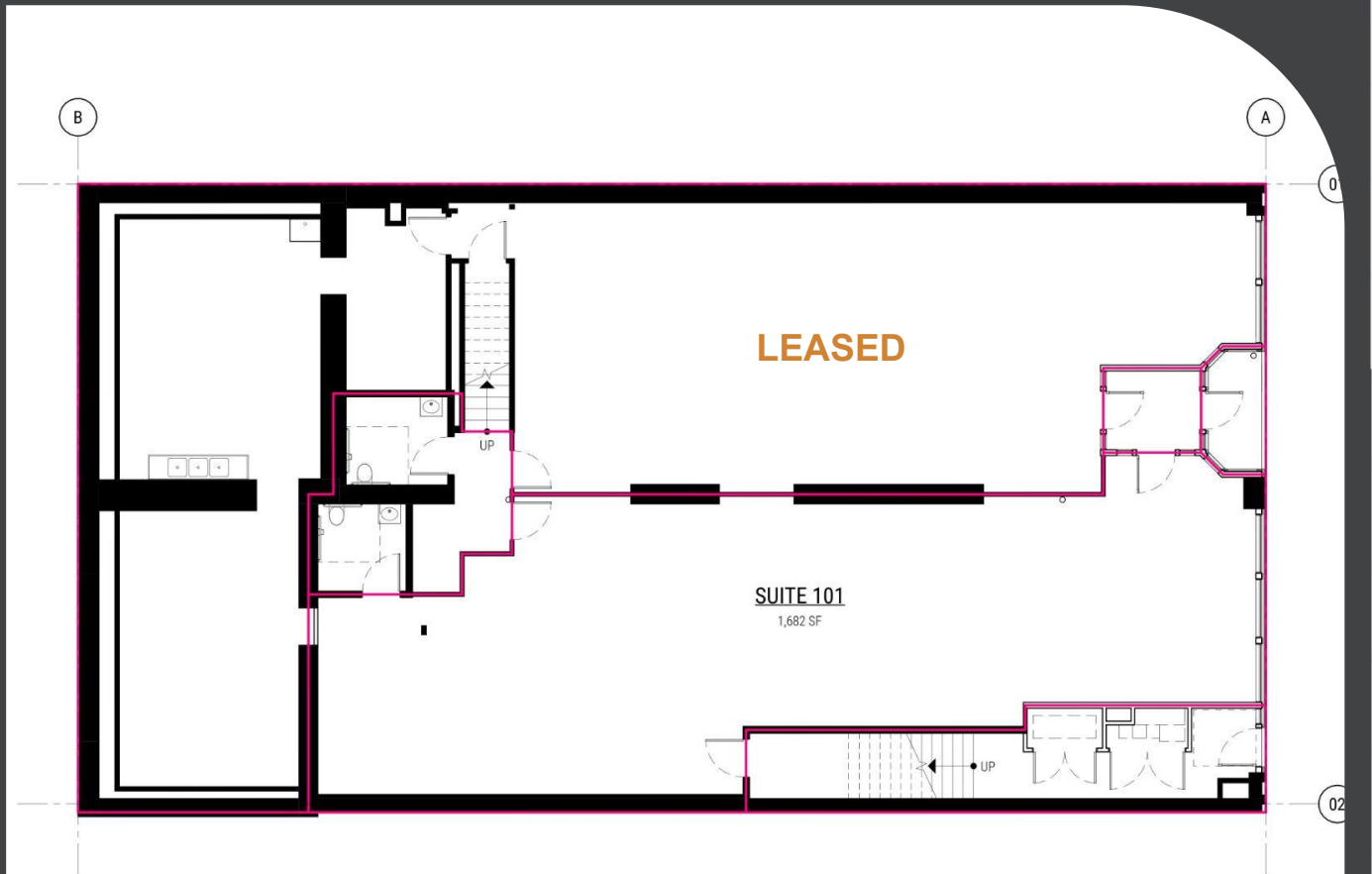

L1 _ STREET LEVEL FLOOR PLAN

SCALE: 1/8" = 1'-0"

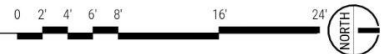

WHARTON BUILDING

411 W 1ST AVE - SPOKANE, WASHINGTON 99201

AVAILABLE SPACE

\$16 RSF NNN

1,682 SF

Information is deemed reliable but not guaranteed. Broker not responsible for changes errors or commissions. All square footages are for conveniences only. All information should be verified prior to leasing or purchasing property.

JUSTIN FOLKINS
509-991-8387

KYHRA STRAMPE
509-309-8444

CHRIS BATTEN
509-217-5508

kyhra@rencorprealty.com
LIC#23020129