

# NEC WESTERN AND BELMONT AVENUES

roscoe village / chicago, il



MID-AMERICA® URBAN

AVAILABLE NOW

CONCEPTUAL RENDERING



# NEC WESTERN AND BELMONT AVENUES

roscoe village / chicago, il

## SPACE DETAILS

### ADDRESS

2352 West Belmont Avenue  
Northeast Corner of North Western Avenue and  
West Belmont Avenue

### CO-TENANTS

Mariano's, Jewel-Osco, Starbucks,  
Potbelly, Walgreens, Unleashed By Petco,  
Party City, MOD Pizza

### AVAILABILITY

Retail A – 9,150 SF – In Lease  
Retail B – 3,500 SF – Aspen Dental  
Retail C – ± 4,500 SF – Wild Fork Foods  
± 2,750 SF – Available

### FEATURES

New +/-19,900 square foot shopping center with  
54 car parking spaces at signalized intersection  
Divisibility between 1,500 and 9,150 square feet  
Traffic counts at intersection in excess of 51,000  
vehicles daily

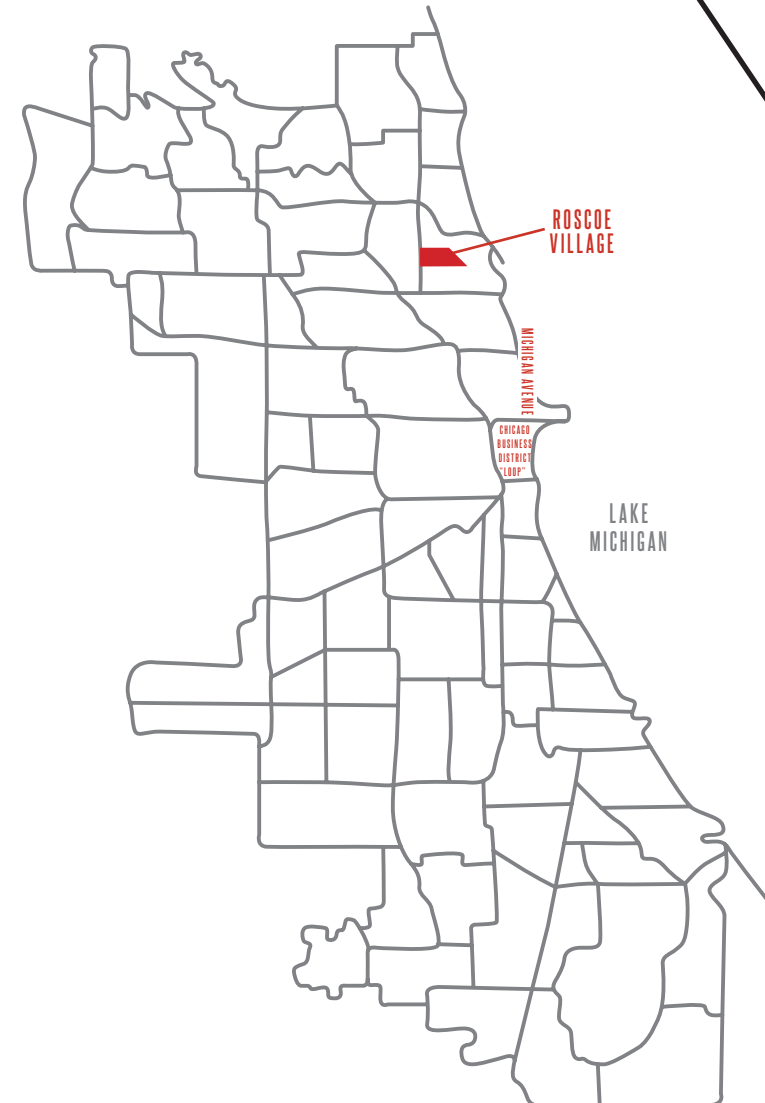

### DEMOGRAPHICS

	.5M	1M	1.5M
AVG HOUSEHOLD INCOME	\$128,945	\$131,560	\$124,336
POPULATION	11,120	47,059	128,561
DAYTIME POPULATION	6,208	23,763	66,366

# NEC WESTERN AND BELMONT AVENUES

roscoe village / chicago, il

CONCEPTUAL SITE PLAN

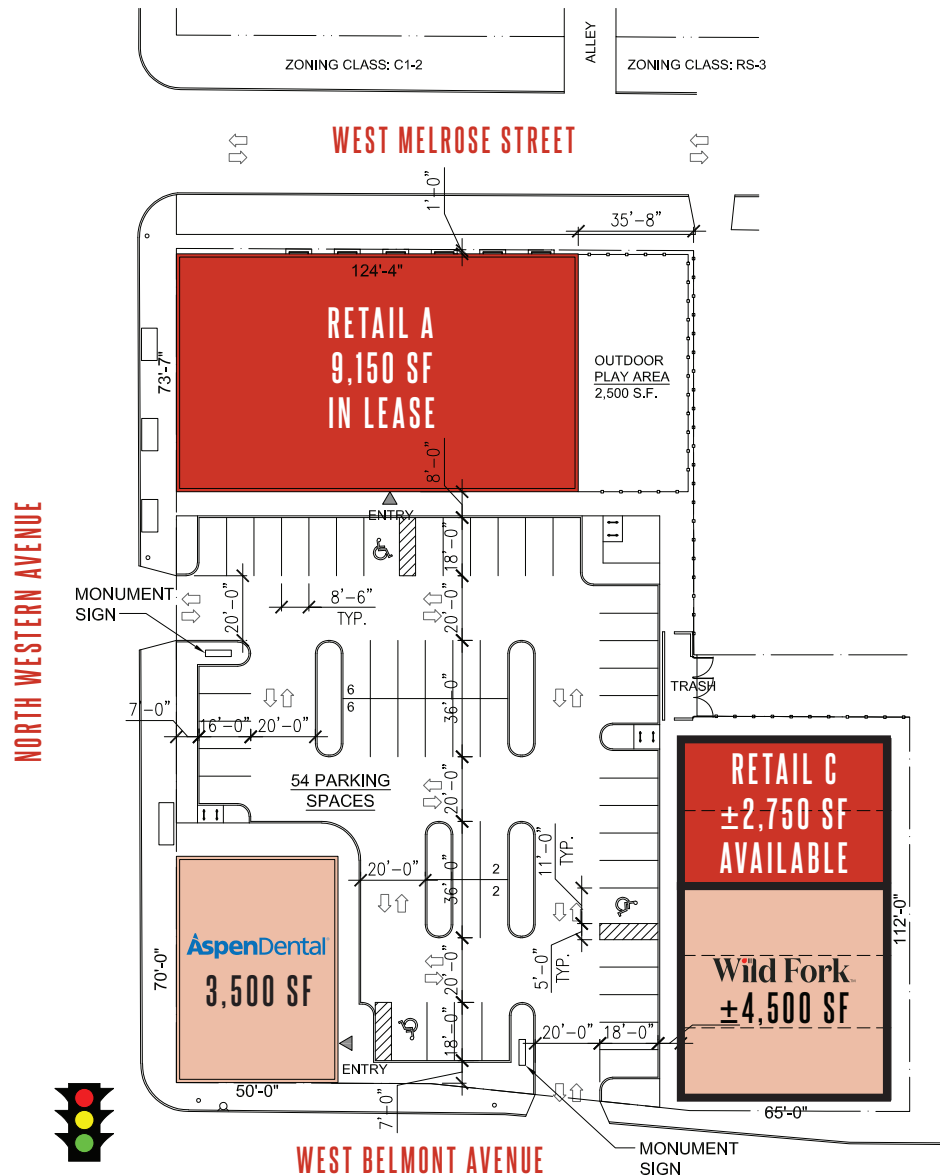

## SPACE DETAILS

- Retail A – 9,150 SF – In Lease
- Retail B – 3,500 SF – Aspen Dental
- Retail C – ± 4,500 SF – Wild Fork Foods  
± 2,750 SF – Available





# NEC WESTERN AND BELMONT AVENUES

roscoe village / chicago, il

AERIAL MAP

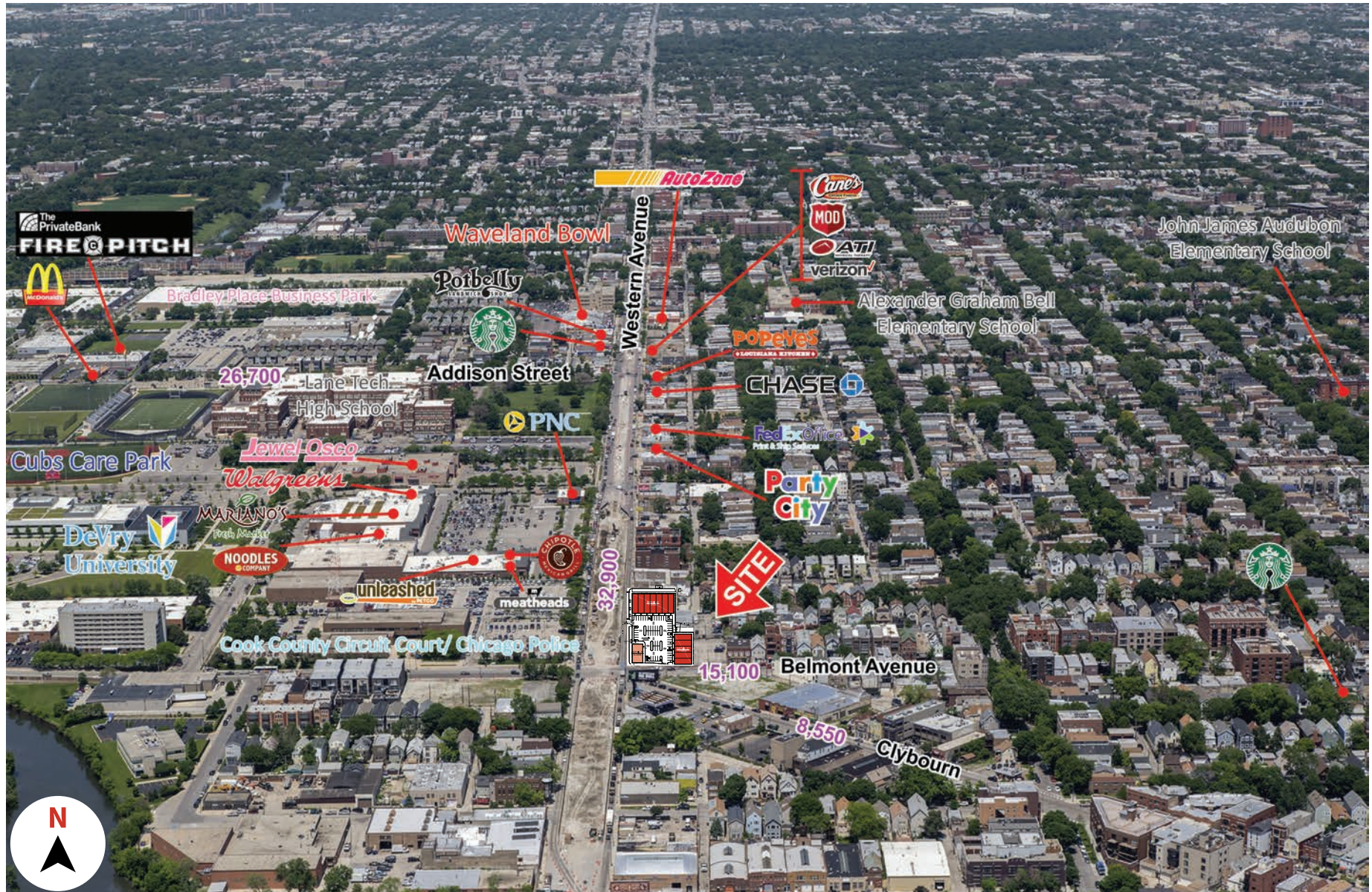



# NEC WESTERN AND BELMONT AVENUES

roscoe village / chicago, il

AERIAL MAP







let's talk. **BIG IDEAS?**

**PAUL BRYANT**  
Mid-America Real Estate Corporation  
630.954.7354  
PBryant@MidAmericaGrp.com

**GREG BAYER**  
Mid-America Real Estate Corporation  
630.954.7441  
GBayer@MidAmericaGrp.com

**LARA KEENE**  
Mid-America Real Estate Corporation  
630.481.4038  
LKeene@MidAmericaGrp.com

**MID-AMERICA<sup>®</sup> URBAN**

