

# PRIME RETAIL SPACE ADJACENT TO KOHL'S

Harrisonburg, VA 22801 | 2035 E Market Street | E Market St & Evelyn Byrd Ave | #0736

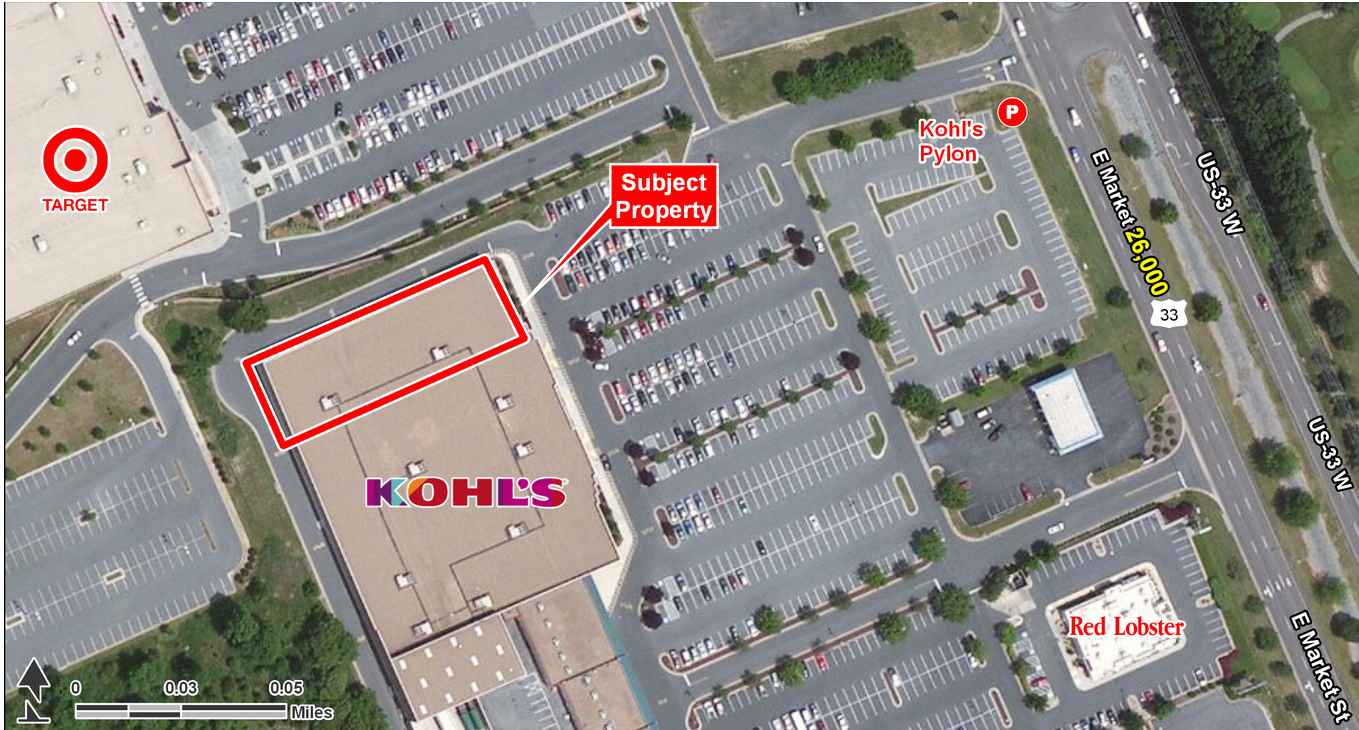

AVAILABLE SF:  
23,900 SF

FRONTAGE:  
APPROX 97' 2"

ZONING:  
GENERAL BUSINESS

RATES:  
CALL FOR DETAILS

## AREA ANCHORS



- 23,900 SF of Jr. Anchor space available next to Kohl's
- Located along dominant regional retail corridor of Harrisonburg along highly traveled East Market Street/Route 33
- Center benefits from multiple points of ingress and egress
- Walking distance to James Madison University with 20,836 students and one mile to Interstate 81

DEMOGRAPHICS	1 MILE	3 MILES	5 MILES	TRAFFIC COUNTS	
2018 Population Density	5,071	53,415	70,256	E Market Street	26,000 AADT
2018 Daytime Population	12,509	43,610	57,418	I-81	58,000 AADT
2018 Average HH Income	57,387	61,113	63,075		
2018 Median HH Income	33,098	40,558	43,794		



**FOR MORE INFORMATION, CONTACT EXCLUSIVE AGENT(S):**  
**KAREN MIKULSKI** • karen.mikulski@tscg.com • 757.722.2500  
**CHRISTINA MAYHUGH** • christina.mayhugh@tscg.com • 804.673.1100

Demographics: Esri 2018 No warranty expressed or implied has been made as to the accuracy of the information provided herein, no liability assumed for error or omissions.





# PRIME RETAIL SPACE ADJACENT TO KOHL'S

Harrisonburg, VA 22801 | 2035 E Market Street | E Market St & Evelyn Byrd Ave | #0736



**FOR MORE INFORMATION, CONTACT EXCLUSIVE AGENT(S):**  
 KAREN MIKULSKI • karen.mikulski@tscg.com • 757.722.2500  
 CHRISTINA MAYHUGH • christina.mayhugh@tscg.com • 804.673.1100



Demographics: Esri 2018 No warranty expressed or implied has been made as to the accuracy of the information provided herein, no liability assumed for error or omissions.



# PRIME RETAIL SPACE ADJACENT TO KOHL'S

Harrisonburg, VA 22801 | 2035 E Market Street | E Market St & Evelyn Byrd Ave | #0736



FOR MORE INFORMATION, CONTACT EXCLUSIVE AGENT(S):  
KAREN MIKULSKI • [karen.mikulski@tscg.com](mailto:karen.mikulski@tscg.com) • 757.722.2500  
CHRISTINA MAYHUGH • [christina.mayhugh@tscg.com](mailto:christina.mayhugh@tscg.com) • 804.673.1100



Demographics: Esri 2018 No warranty expressed or implied has been made as to the accuracy of the information provided herein, no liability assumed for error or omissions.

# PRIME RETAIL SPACE ADJACENT TO KOHL'S

Harrisonburg, VA 22801 | 2035 E Market Street | E Market St & Evelyn Byrd Ave | #0736

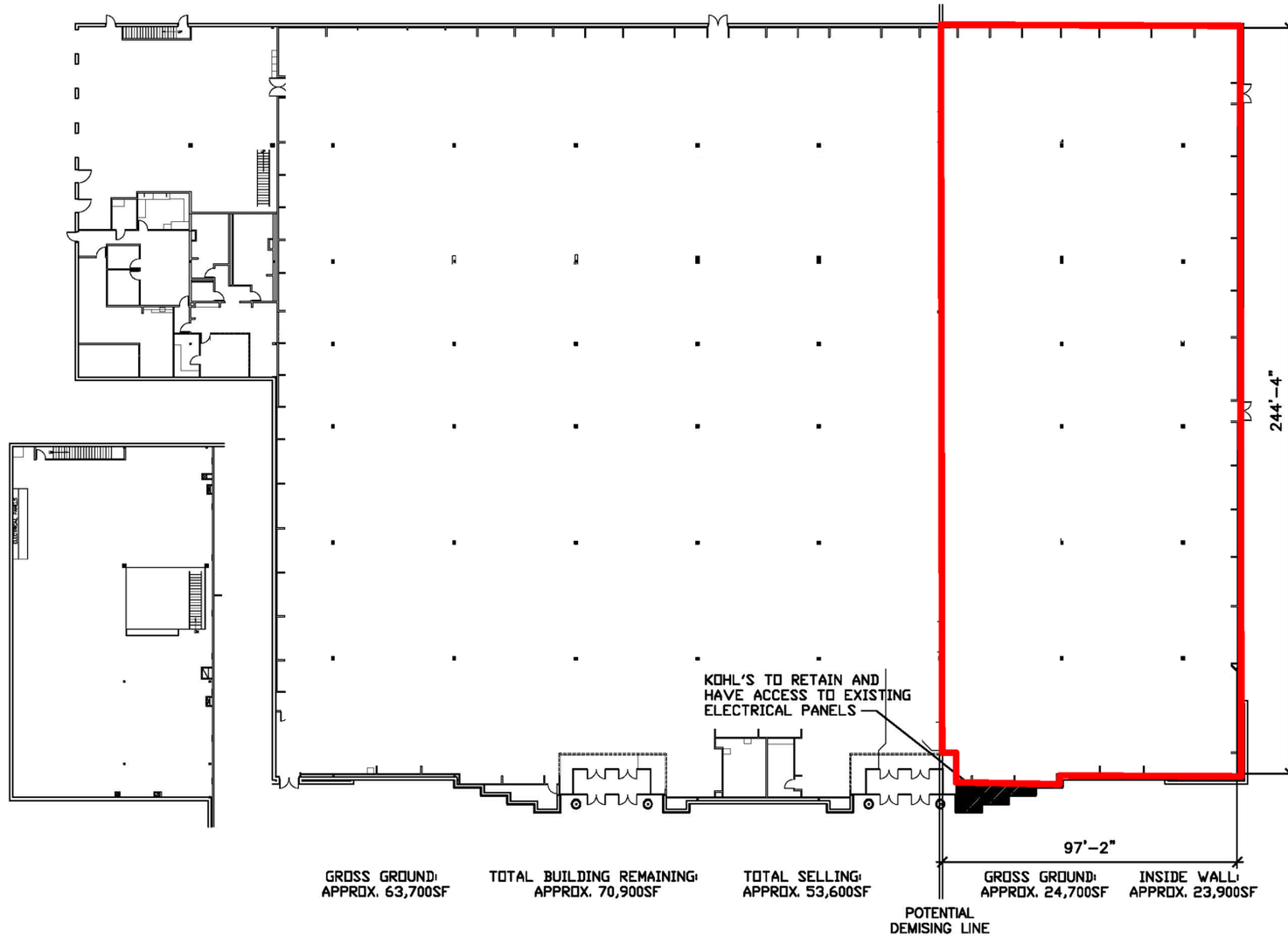

#10736 Harrisonburg, VA  
Updated: 12/6/17



FOR MORE INFORMATION, CONTACT EXCLUSIVE AGENT(S):  
KAREN MIKULSKI • karen.mikulski@tscg.com • 757.722.2500  
CHRISTINA MAYHUGH • christina.mayhugh@tscg.com • 804.673.1100

