

OFFICE / FLEX SPACE FOR LEASE

PACIFIC SIERRA BUSINESS CENTER

3017-3039 KILGORE ROAD
RANCHO CORDOVA, CA



SEAN MULLEN

Director
sean.mullen@cushwake.com
CA License 01845406

KEVIN GOLDTHWAITE

Senior Associate
kevin.goldthwaite@cushwake.com
CA License 01911862

SPENCER NIELSEN

Senior Associate
spencer.nielsen@cushwake.com
CA License 01964163

CALL
+1 916 288 4800

PACIFIC SIERRA BUSINESS CENTER

3017 KILGORE ROAD

3039 KILGORE ROAD

Space Ranging From $\pm 1,826$ SF - $\pm 11,212$ SF

Up to 15' ceilings heights

Ability to deliver creative workspace

Flexible floor plans, and units with industrial roll-up doors

3017 KILGORE ROAD RANCHO CORDOVA, CA

AVAILABILITIES	
Suite 1*	±6,226 RSF
Suite 2*	±2,539 RSF
Suite 3*	±2,447 RSF

* Can be combine up to ±11,212 RSF

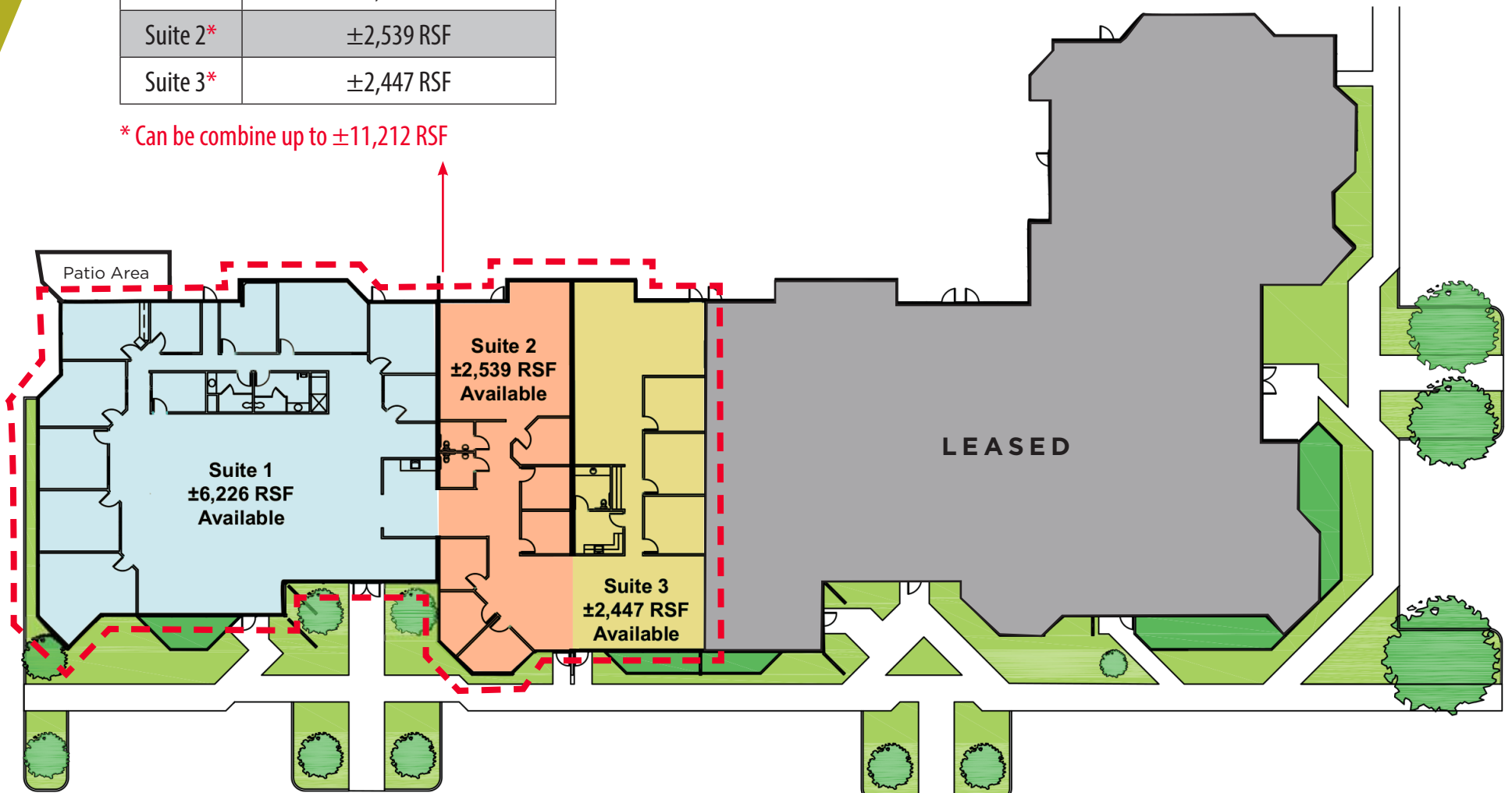

3039 KILGORE ROAD RANCHO CORDOVA, CA

AVAILABILITIES	
Suite 150*	±1,826 RSF
Suite 160*	±2,891 RSF
Suite 170*	±1,826 RSF
Suite 180*	±1,907 RSF
Suite 190*	±2,734 RSF

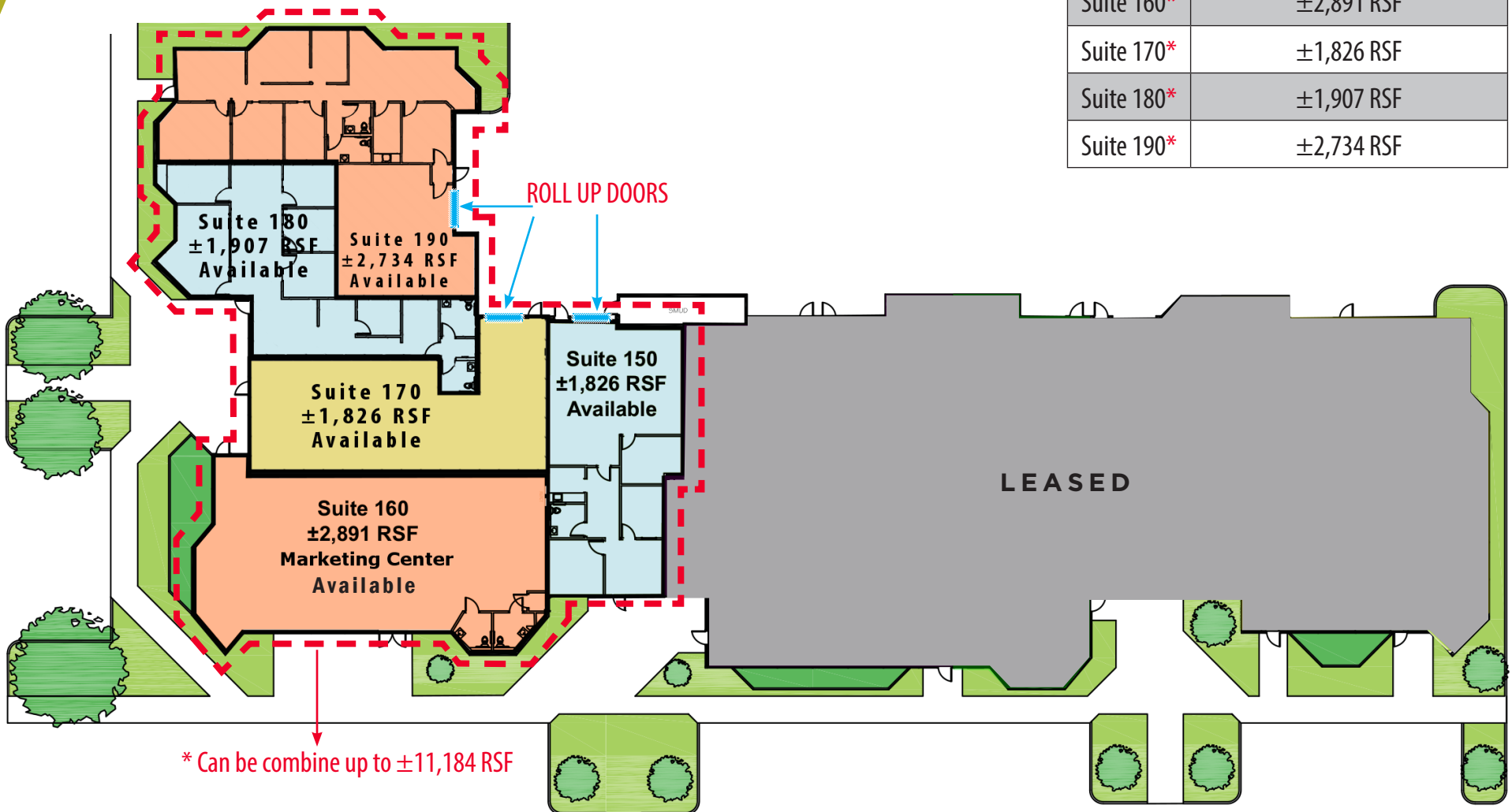





12 Miles to Downtown Sacramento



3017-3039 Kilgore Road



White Rock Rd.



Weather Sports Center



Sunrise Blvd.

Zinfandel Dr.



- Easy access to Hwy 50
- Conveniently located near a variety of retail amenities
- Close proximity to both executive and affordable housing
- Access to the region's dense labor pools

PACIFIC SIERRA BUSINESS CENTER

3017-3039 KILGORE ROAD
RANCHO CORDOVA, CA

3017 | 3039

SEAN MULLEN

Director

916.288.4811

sean.mullen@cushwake.com

CA License 01845406

KEVIN GOLDTHWAITE

Senior Associate

916.403.1818

kevin.goldthwaite@cushwake.com

CA License 01911862

SPENCER NIELSEN

Senior Associate

916.288.4531

spencer.nielsen@cushwake.com

CA License 0196416



400 Capitol Mall, Ste. 1800,
sacramento, CA 95814
cushmanwakefield.com
+1 916 288 4800

Cushman & Wakefield Copyright 2019. No warranty or representation, express or implied, is made to the accuracy or completeness of the information contained herein, and same is submitted subject to errors, omissions, change of price, rental or other conditions, withdrawal without notice, and to any special listing conditions imposed by the property owner(s). As applicable, we make no representation as to the condition of the property (or properties) in question.