

For more information, please contact:

TIM WALKER

☎: 949.230.7649

✉: timwalker@lee-associates.com

DRE #: 01097727

STEVE HEIMULI

☎: 949.510.0618

✉: sheimuli@lee-associates.com

DRE #: 02023637



LEE & ASSOCIATES® - NEWPORT BEACH | Corporate ID#01197433
 100 Bayview Circle, Suite 600, Newport Beach, California 92660
 ☎ 949.724.1000 | ☎ 949.862.9048 | www.lee-associates.com

DISCLAIMER: The information contained herein has been obtained from the property owner or other third party and is provided to you without verification as to accuracy. We (Lee & Associates, its brokers, employees, agents, principals, officers, directors and affiliates) make no warranty or representation regarding the information, property, or transaction. You and your attorneys, advisors and consultants should conduct your own investigation of the property and transaction.

LEASE

1520 N. EL CAMINO REAL SAN CLEMENTE, CALIFORNIA

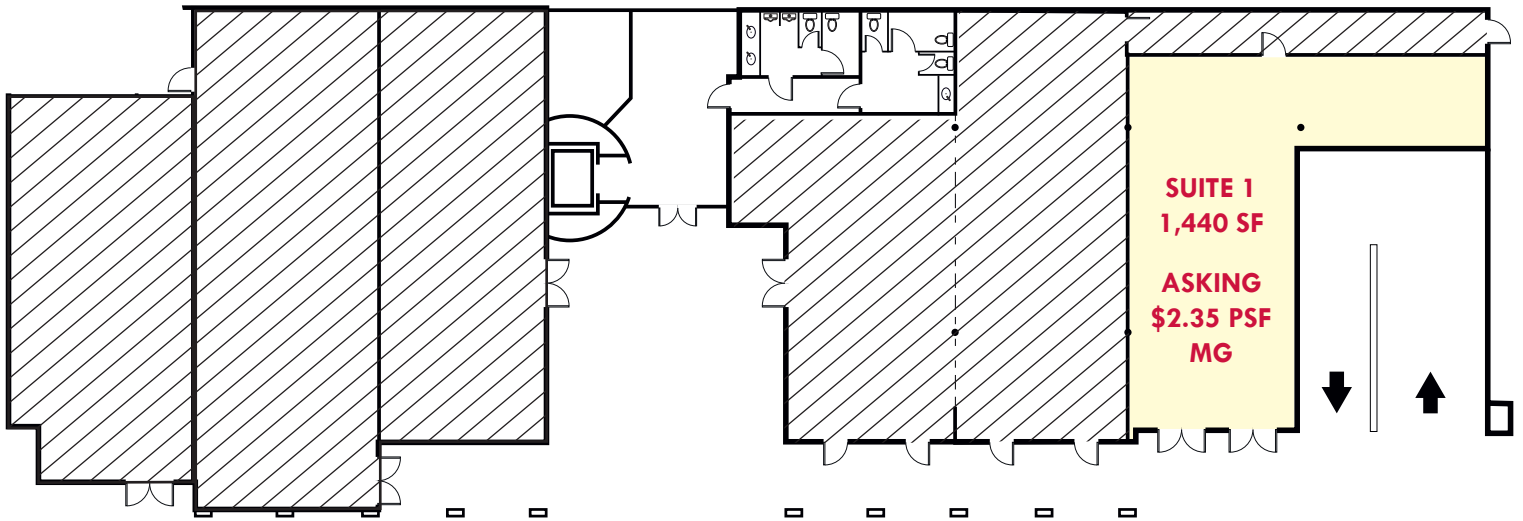

NOT TO SCALE. NOT AS BUILT.

For more information, please contact:

TIM WALKER

☎: 949.230.7649

✉: timwalker@lee-associates.com

DRE #: 01097727

STEVE HEIMULI

☎: 949.510.0618

✉: sheimuli@lee-associates.com

DRE #: 02023637



LEE & ASSOCIATES® - NEWPORT BEACH | Corporate ID#01197433
100 Bayview Circle, Suite 600, Newport Beach, California 92660
☎ 949.724.1000 | ☎ 949.862.9048 | www.lee-associates.com

DISCLAIMER: The information contained herein has been obtained from the property owner or other third party and is provided to you without verification as to accuracy. We (Lee & Associates, its brokers, employees, agents, principals, officers, directors and affiliates) make no warranty or representation regarding the information, property, or transaction. You and your attorneys, advisors and consultants should conduct your own investigation of the property and transaction.