



# 17<sup>th</sup> and CHANCELLOR

Rittenhouse Square | Philadelphia, PA

CORNER RETAIL OPPORTUNITY  
6,876 SF

HYATT  
CENTRIC™

JLL

Clemens  
Construction  
Company, Inc.

# 17<sup>th</sup> and CHANCELLOR

HYATT CENTRIC™

Rittenhouse Square | Philadelphia, PA

6,876 SF Corner Retail Opportunity

## PROPERTY DETAILS

- ±6,876 SF (Divisible)
- New construction high-exposure corner retail opportunity with eye-catching floor to ceiling glass façade
- Situated at the base of the Hyatt Centric with 332 rooms
- Anticipated Spring 2020 delivery
- Dramatic ceiling heights at 18'
- Parking garage immediately adjacent with 220 spaces
- Centrally located within bustling Rittenhouse, immersed within a dense and affluent residential population and desirable retail and dining offerings

## FLOOR PLANS

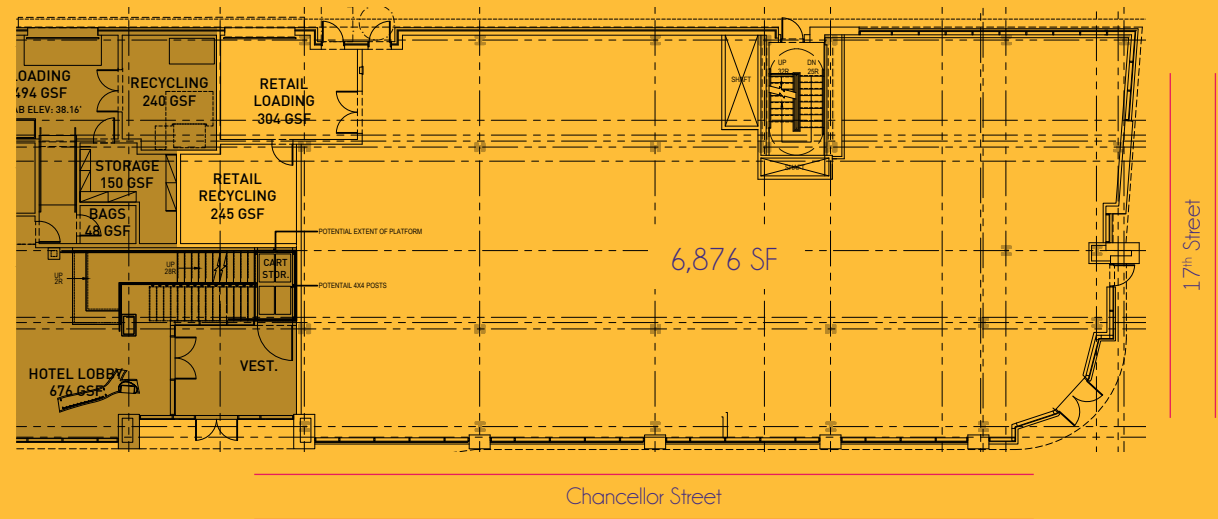

## NEIGHBORING TENANTS



STUART WEITZMAN

URBAN OUTFITTERS



VINCE.



# 17<sup>th</sup> and CHANCELLOR

HYATT CENTRIC™

Rittenhouse Square | Philadelphia, PA  
6,876 SF Corner Retail Opportunity

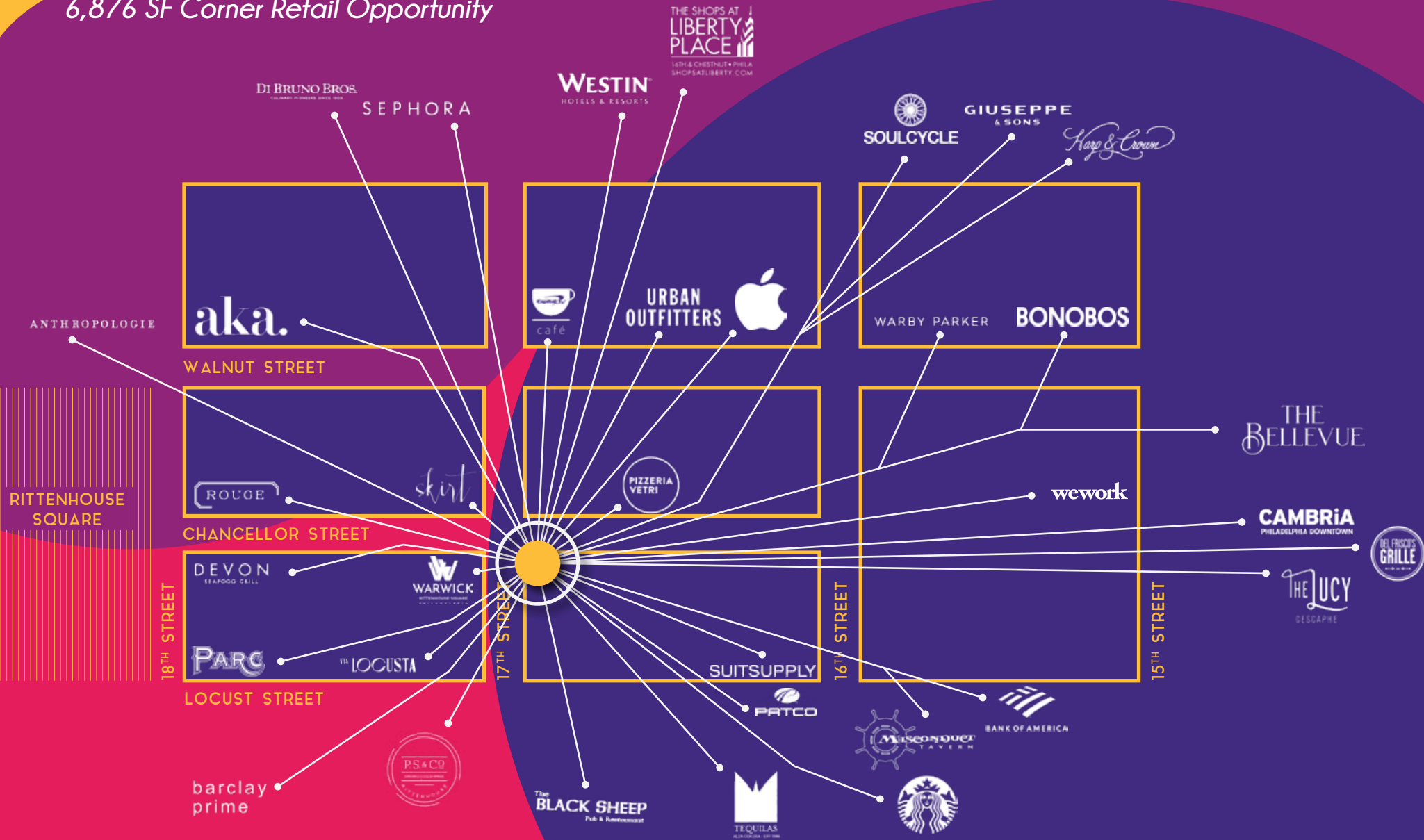



JLL | Jones Lang LaSalle  
1650 Arch St. Suite 2500  
Philadelphia, PA 19103  
+1 215 988 5500

# 17<sup>th</sup> and CHANCELLOR

*Rittenhouse Square | Philadelphia, PA*

CORNER RETAIL OPPORTUNITY  
**6,876 SF**

**PAIGE JAFFE**  
MANAGING DIRECTOR  
[paige.jaffe@am.jll.com](mailto:paige.jaffe@am.jll.com)  
+1 215 988 5500

**MALLORY SCACCETTI**  
SENIOR VICE PRESIDENT  
[mallory.scaccetti@am.jll.com](mailto:mallory.scaccetti@am.jll.com)  
+1 215 988 5500