

## For Sublease

**540 Madison Avenue**  
Southwest Corner of  
East 55th Street

**AREA:**  
Partial 7th Floor - 3,748 RSF

**RENTAL RATE:**  
Upon Request

**POSSESSION:**  
Immediate

**TERM:**  
2 - 3 Years

[Download PDF](#)



### COMMENTS:

- High-end space with glass finishes throughout
- Reception area, conference room, 5 perimeter offices, 3 interior offices, open area and workstations
- Furniture and wiring in place
- Sublandlord occupies the balance of the floor
- Boutique property
- High-end tenant roster
- Plaza District location

**Existing Plan**



**Alternate Layout**

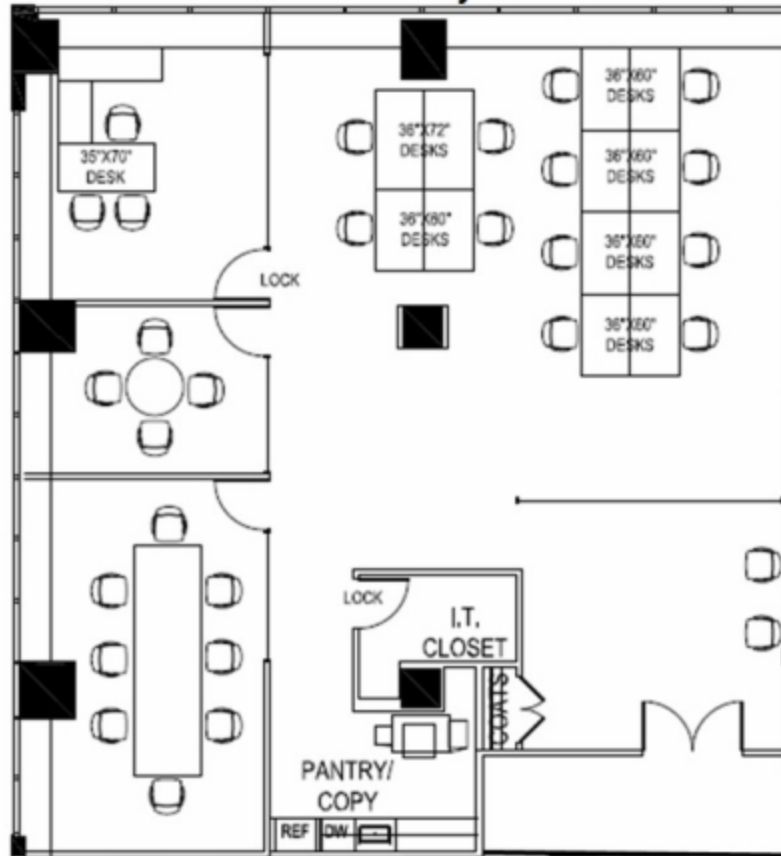

### FOR INFORMATION, PLEASE CONTACT:

**MICHAEL HORN**  
Associate Director  
646.441.3806  
[MHORN@NGKF.COM](mailto:MHORN@NGKF.COM)

**JOSH FRIEDMAN**  
Executive Managing Director  
212.372.2305  
[JFRIEDMAN@NGKF.COM](mailto:JFRIEDMAN@NGKF.COM)

