

2/7/11  
 Most recent floor plan

Area A.1 = 2,606.5 SF

Area A.2 = 3,698.5 SF

Area B = 3,128 SF

Area C = 2,372 SF

Total = 11,800 SF

Rough Limits Review = 48' x 44' = 2,112 SF  
 = 196' x 50' = 9,800 SF  
 11,912 SF

Area A.1 = (9' x 6'6") + (12' x 29') + (48' x 44') + (11' x 8')  
 58.5 + 348 + 2112 + 88  
 = 2606.5 SF

Area A.2 = (12' x 14'6") + (3' x 6'6") + (50' x 70')  
 174 + 19.5 + 3500 = 3,693.5

Area B = (12' x 19') + (50' x 58')  
 = 228 + 2900 = 3128 SF

Area C = (12' x 81') + (40' x 50')  
 972 + 2000 = 2,972 SF

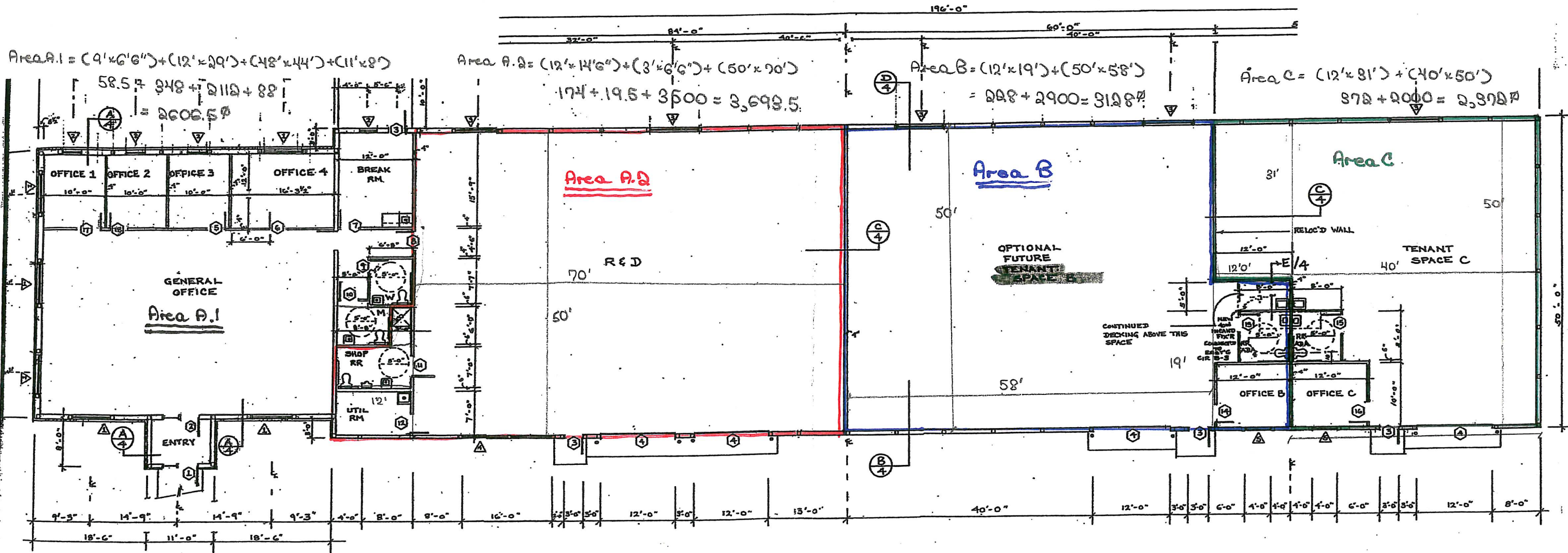

FLOOR PLAN  
 SCALE: 1/8" = 1'

12000 SF

2112 SF

12/19/06